

This catalog covers:  
**'10 KX65 AAF**

GRID NO. **A-1** This grid covers:  
**Title**



## PARTS CATALOG

'10 KX65 AAF

(KX65)

---

Publications .....	A-2
Model Identification .....	A-4
Engine .....	B-1
Chassis.....	D-1

---

© Kawasaki Heavy Industries, Ltd. 2009

Engine No. Location:  
RH side crankcase, below cylinder base

---

Year & Model	'10 KX65AAF
Color	1. Lime Green (777)
VIN No. Range	JKBKX065AAA070001 ~ JKBKXEAC\AA070001 ~ (Australia only)
Engine No. Range	KX065AE000001 ~

This catalog covers:  
**'10 KX65 AAF**

GRID NO. **A-2** This grid covers:  
**Publications**

Year & Model	Owner's Manual	A&P Manual		Service Manual		Microfiche
		General	Supplement	Basic	Supplement	
<b>2010 KX65AAF</b>	99976-1549(EN/FR/DE) 99976-1550(IT/ES/NL) 99986-1528(Australia only)	99939-1319-01		99924-1252-11		99912-1611-01



# KX65AAF

Left Side View

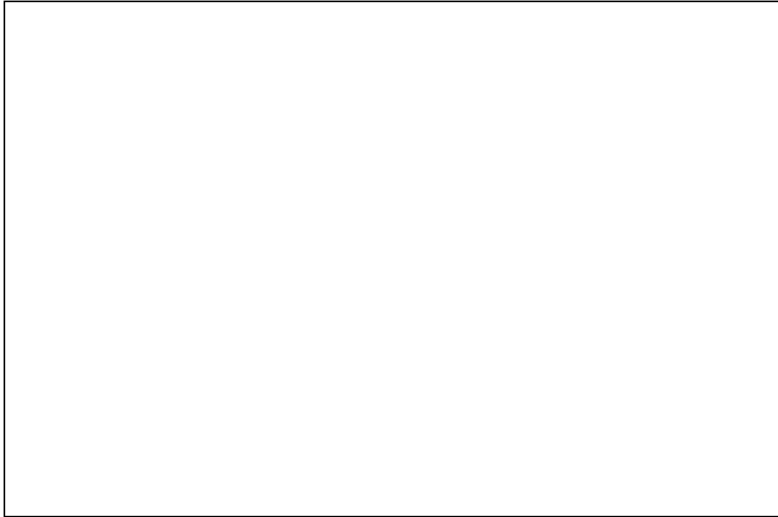

Right Side View

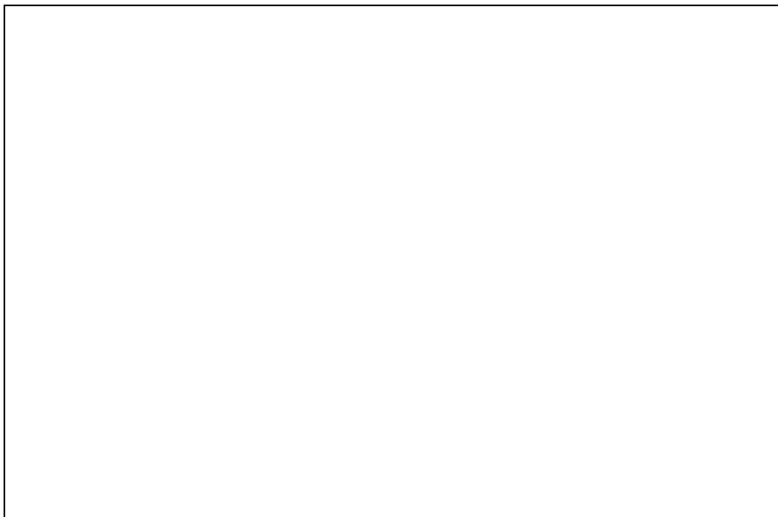





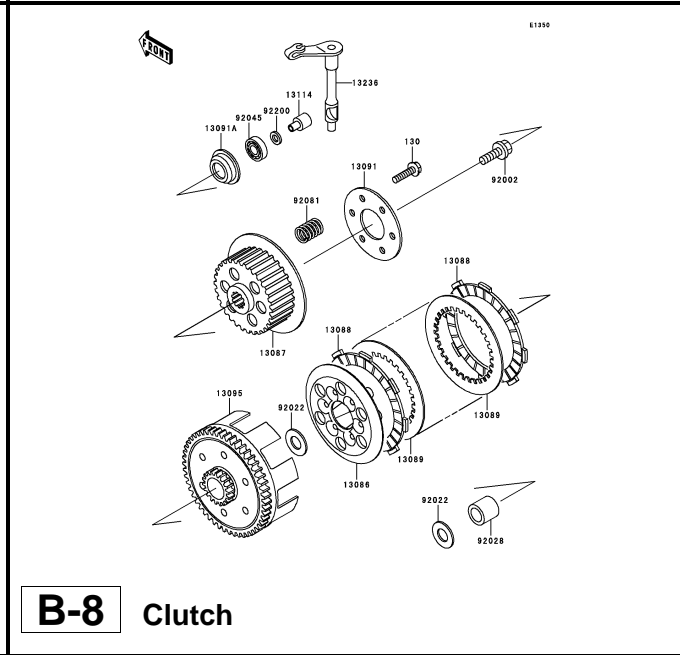
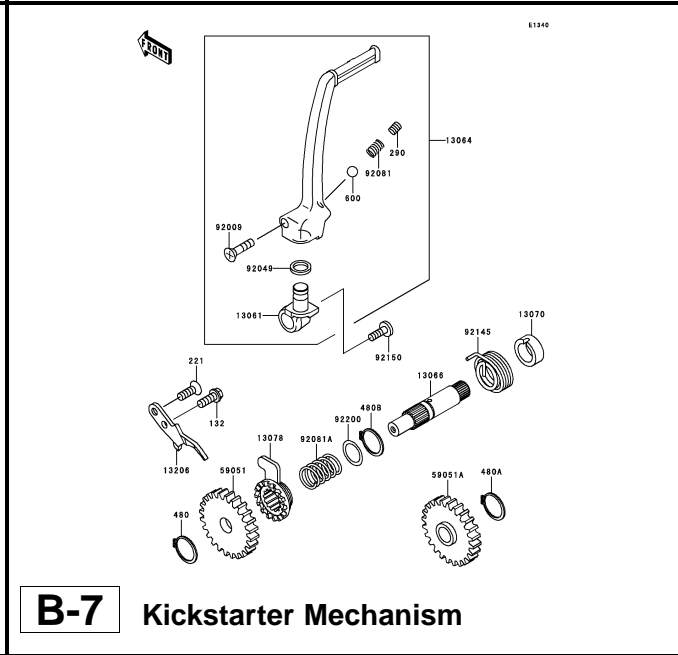
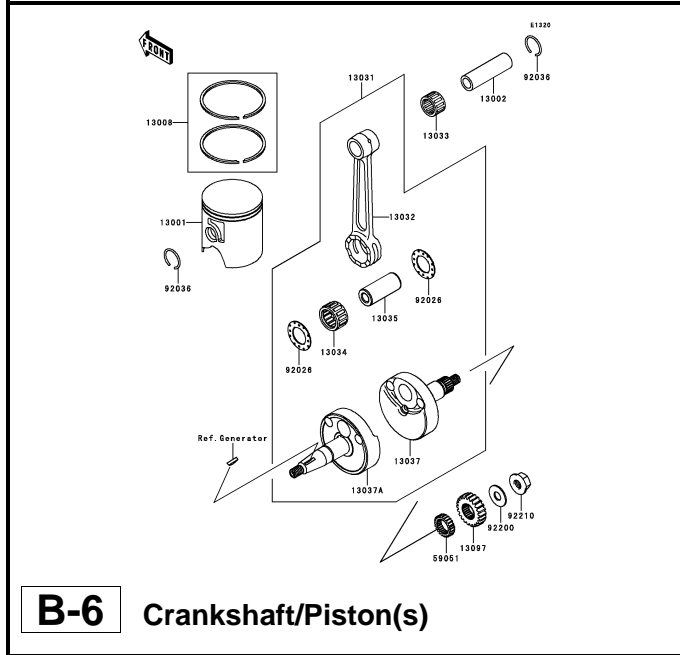
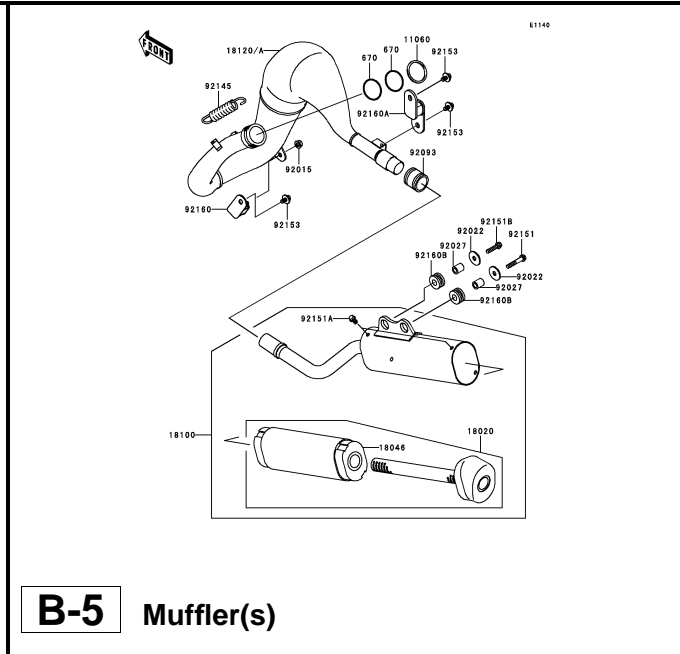
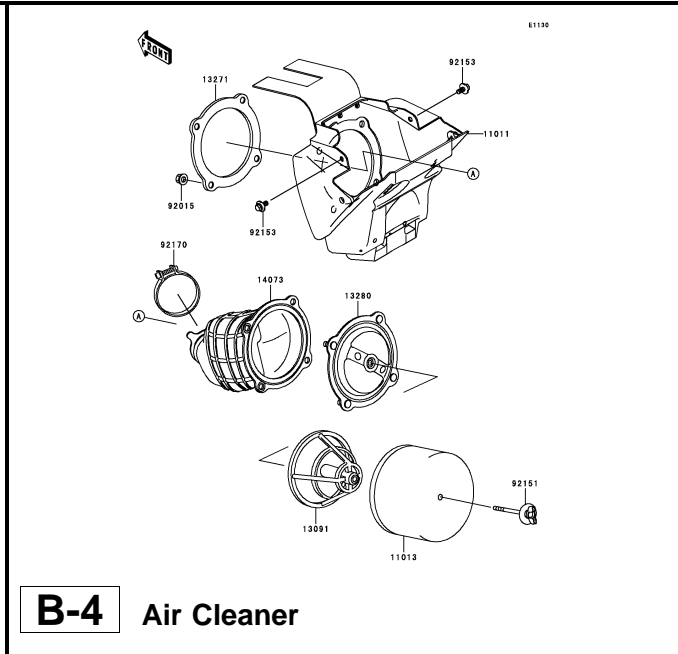
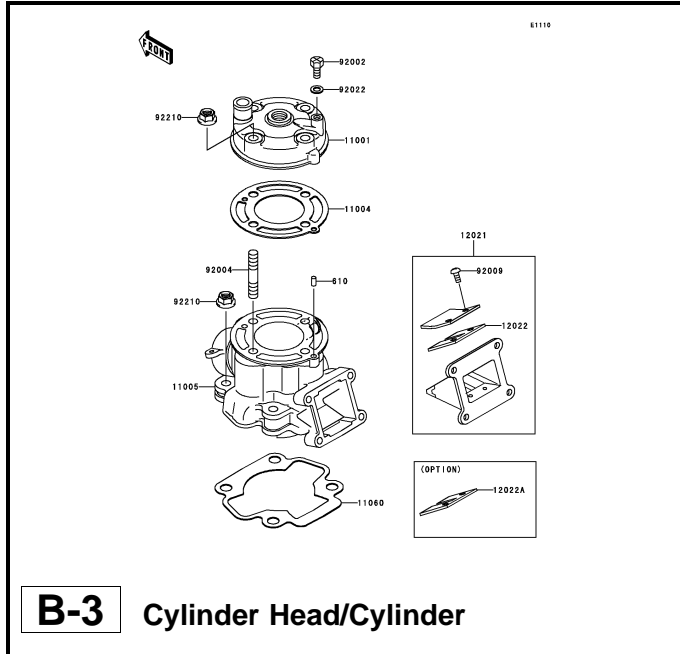







*This catalog covers:*

**'10 KX65AAF Engine**

*GRID NO.*

**C-2**

*This grid covers:*

**Pictorial Index**



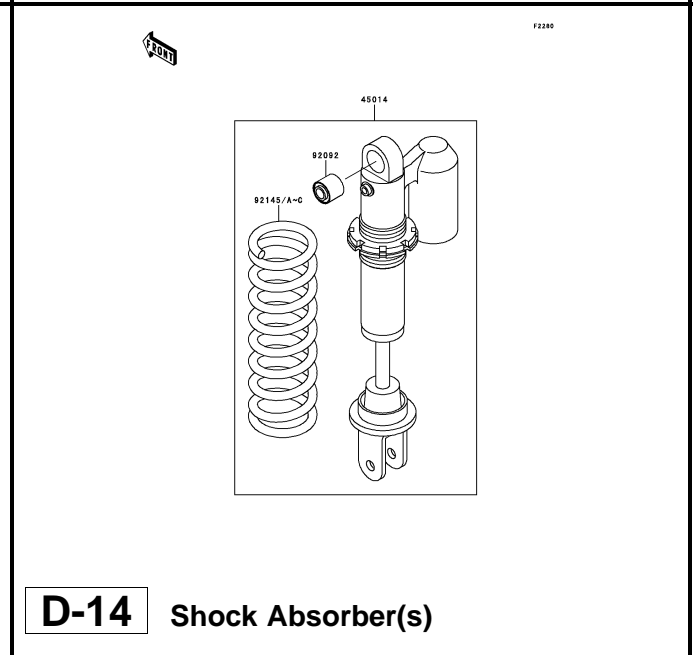
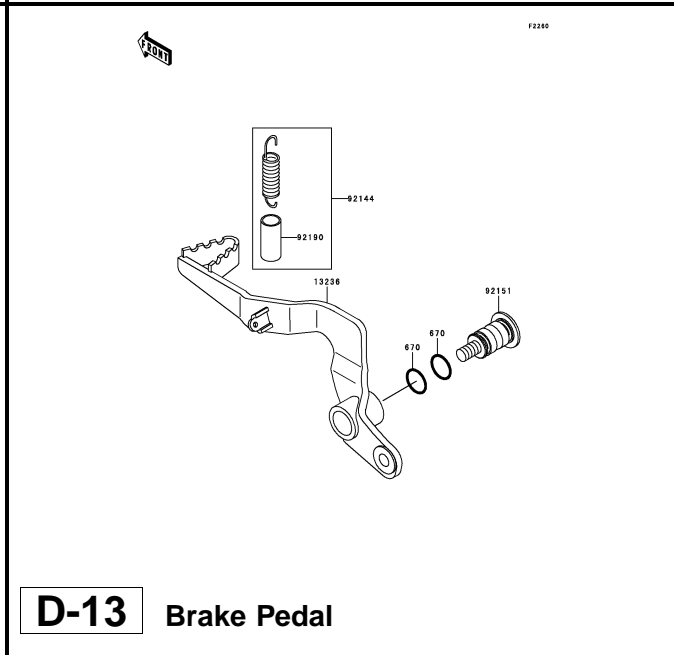
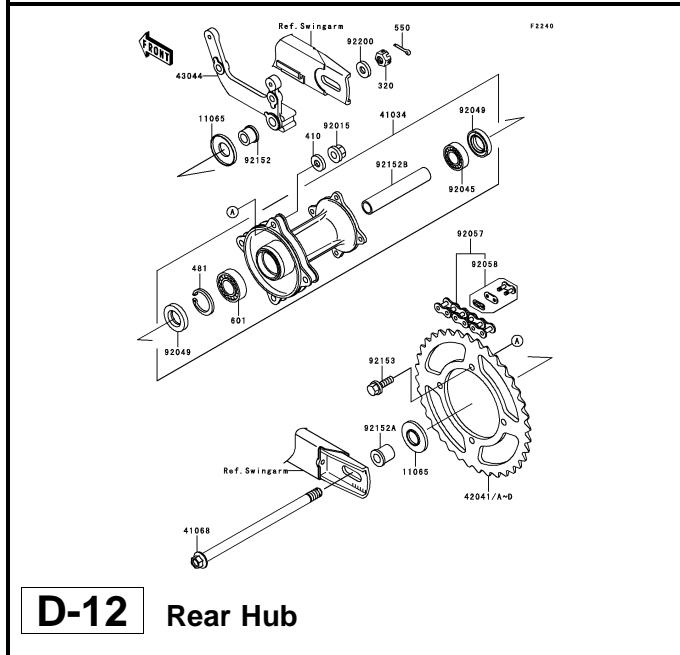
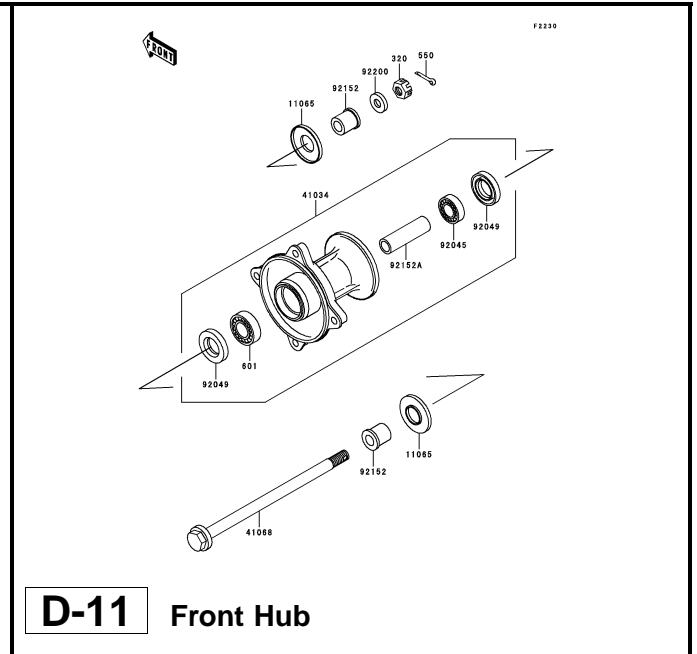
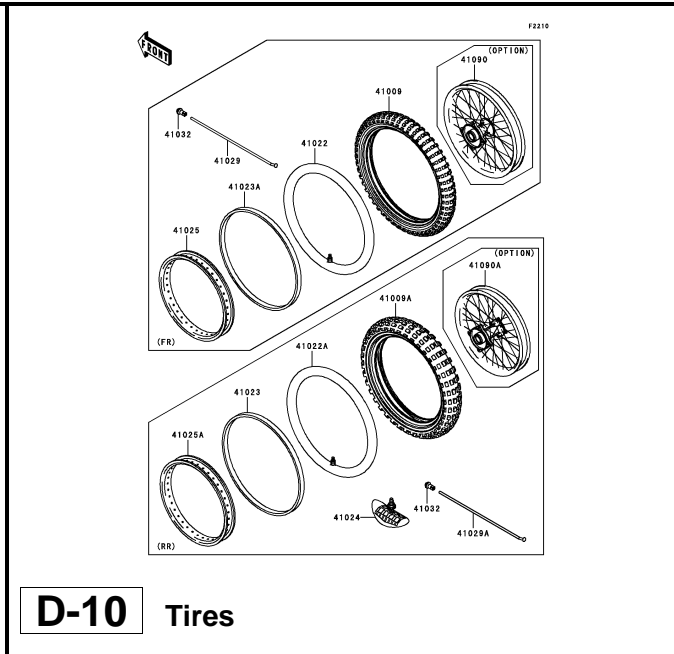
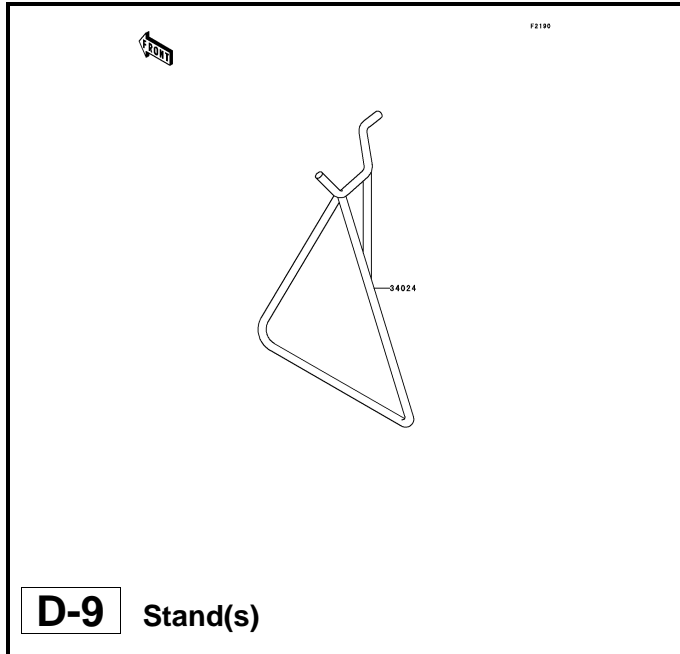

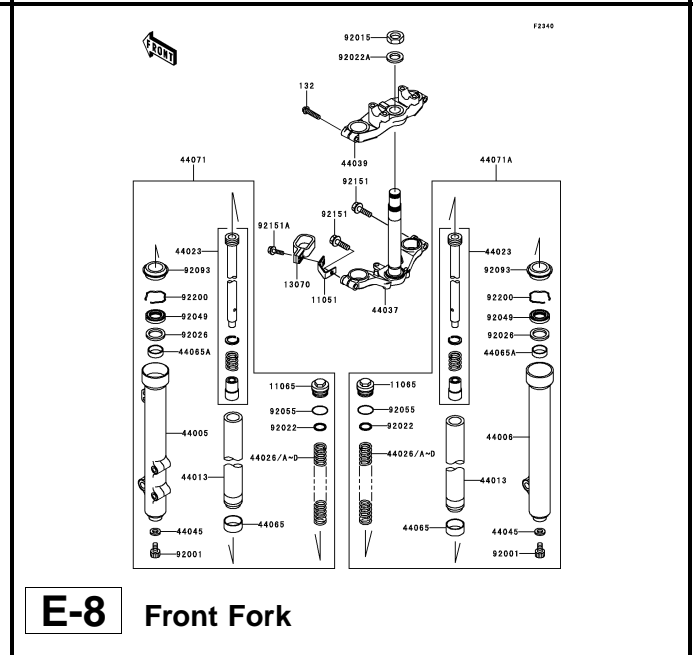
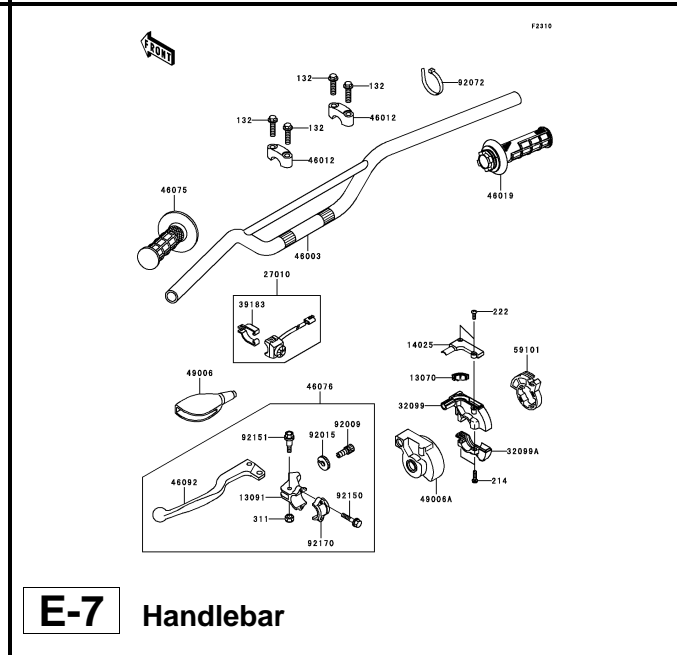
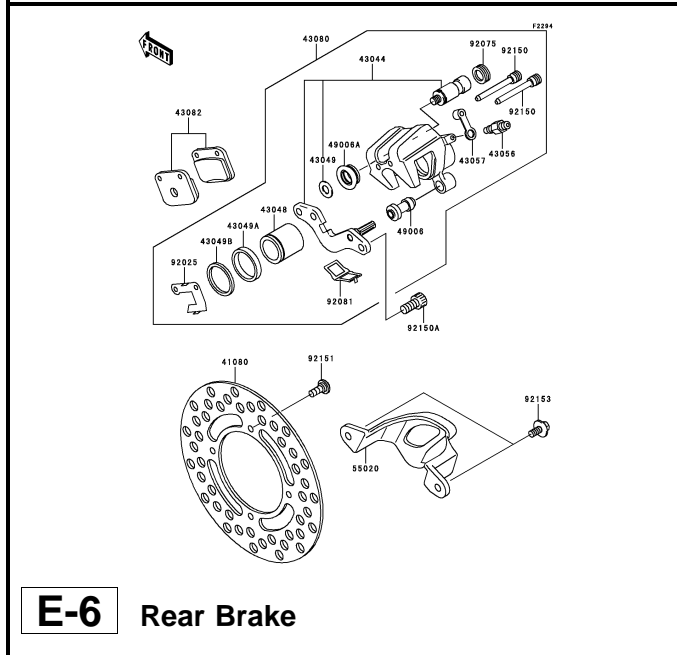
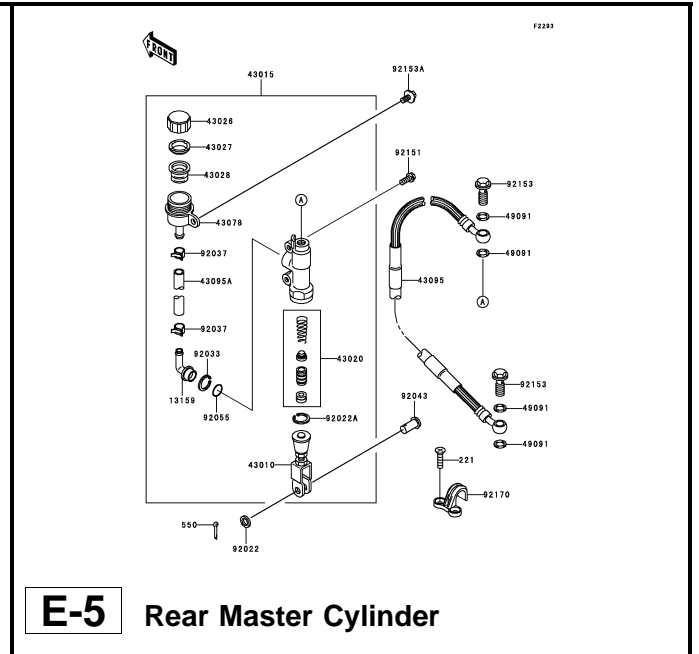
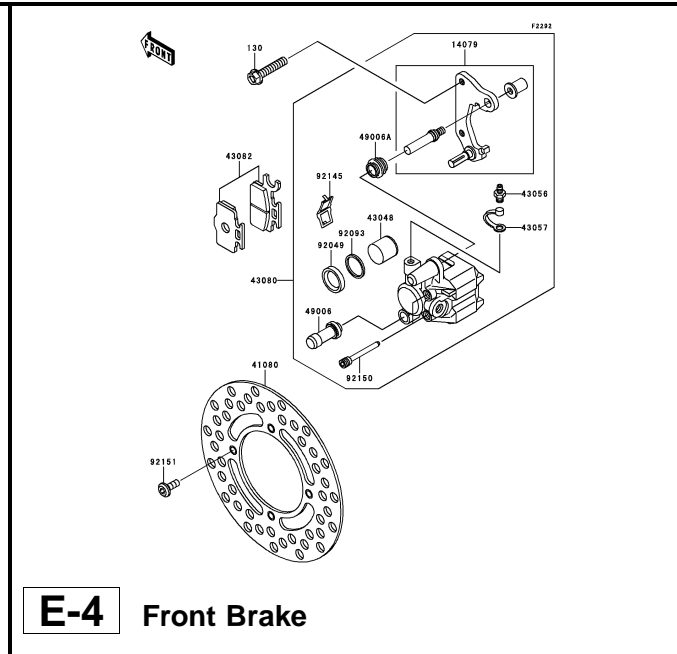
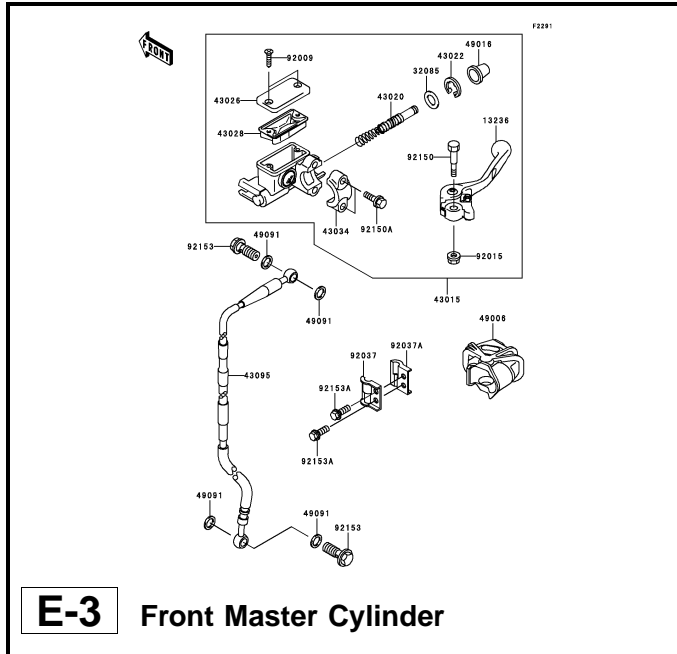

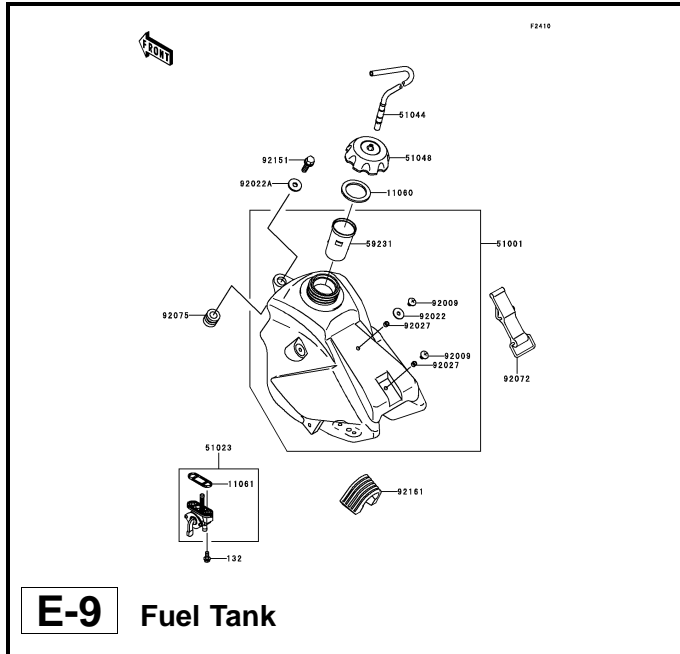
**E-9 Fuel Tank**

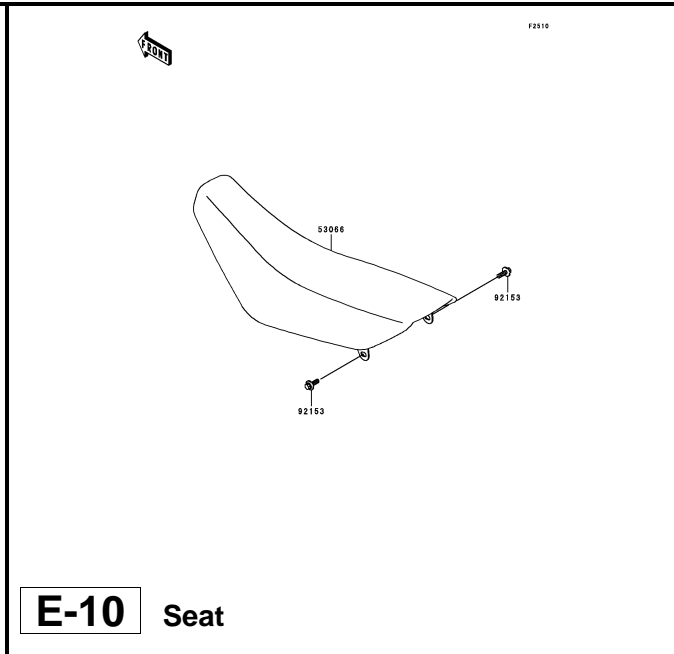

**E-10 Seat**

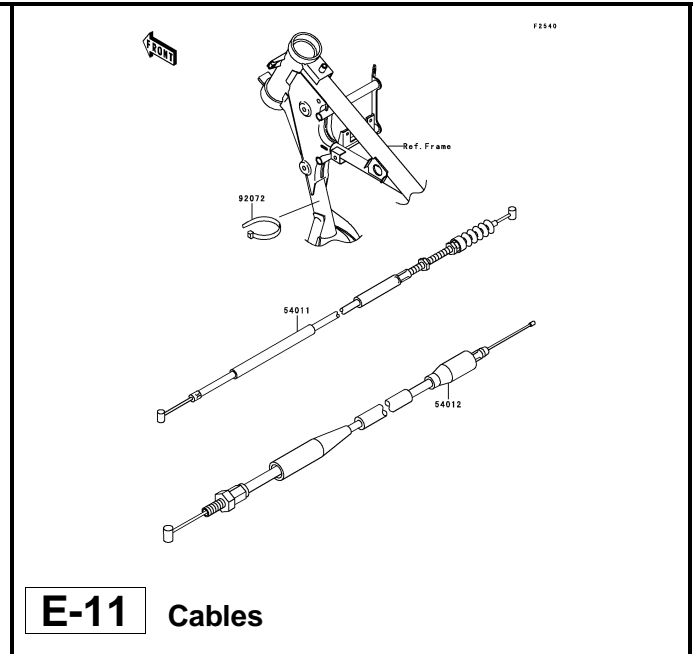

**E-11 Cables**

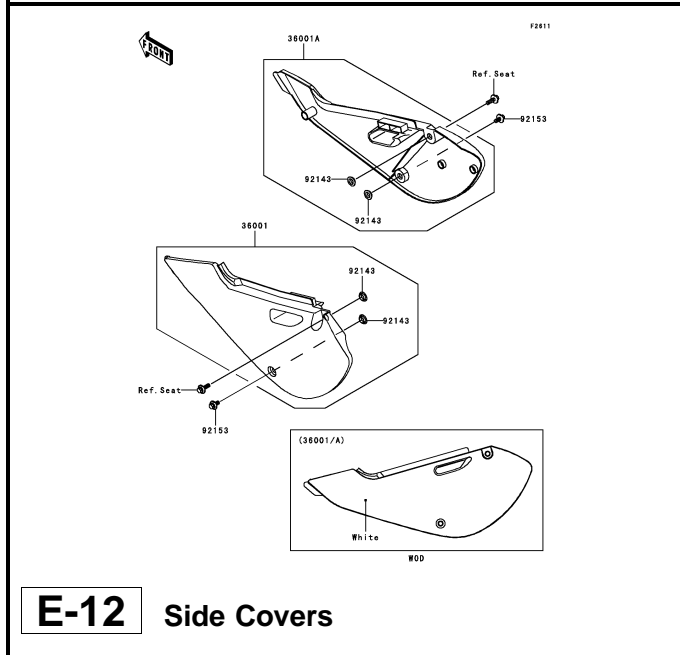

**E-12 Side Covers**

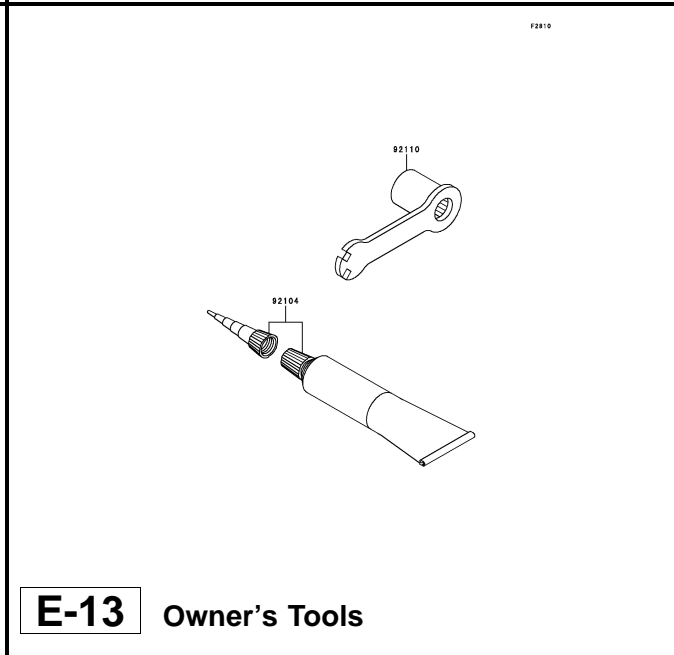

**E-13 Owner's Tools**

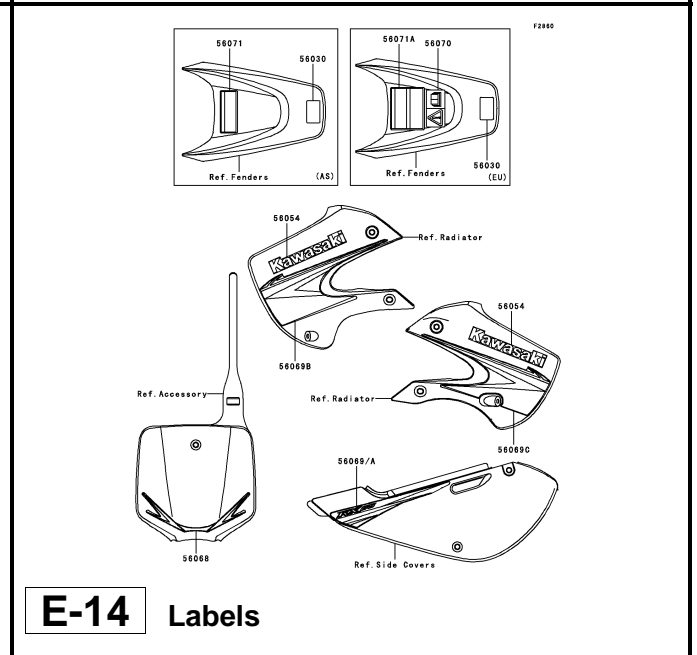

**E-14 Labels**

F2910

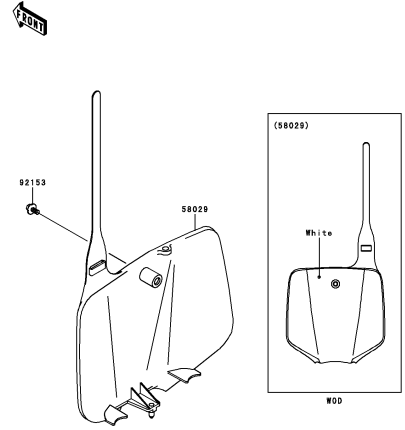

92153

58029

(58029)

White

W00

**F-3** Accessory

F2920

Owner's Manual  
(Local Procurement)

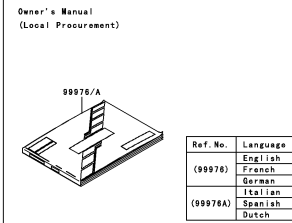

99976/A

Ref. No.	Language
	English
(99976)	French
	German
	Italian
(99976A)	Spanish
	Dutch

**F-4** Manual(EU)

*This catalog covers:*

**'10 KX65AAF Chassis**

*GRID NO.*

**F-2**

*This grid covers:*

**Pictorial Index**

---



This catalog covers:  
**'10 KX65AAF Engine**

GRID NO.

**B-3**

This grid covers:  
**Cylinder Head/Cylinder**

E1110

Ref. No.	Part No.	Description	Spec Code	Quantity-KX65		
				'10		
				AAF		
11001	11001-1516	HEAD-CYLINDER			1	
11004	11004-1346	GASKET-HEAD			1	
11005	11005-1973	CYLINDER-ENGINE			1	
11060	11060-1921	GASKET,CYLINDER BASE,T=0.37			1	
12021	12021-1015	VALVE-ASSY-REED			1	
12022	12022-1013	VALVE-REED,T=0.42			2	
12022A	12022-1087	VALVE-REED,T=0.37,CARBON (OPTION)			2	
92002	92002-1222	BOLT,6X10			1	
92004	92004-1069	STUD,8X30			4	
92009	92009-1014	SCREW,REED VALVE			4	
92022	92022-304	WASHER,6.2X11X1			1	
92210	92210-0076	NUT,8MM			8	
610	610A0408	ROLLER,4X8			2	

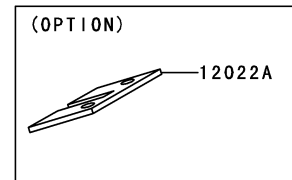
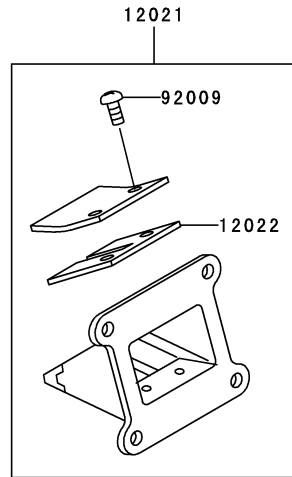
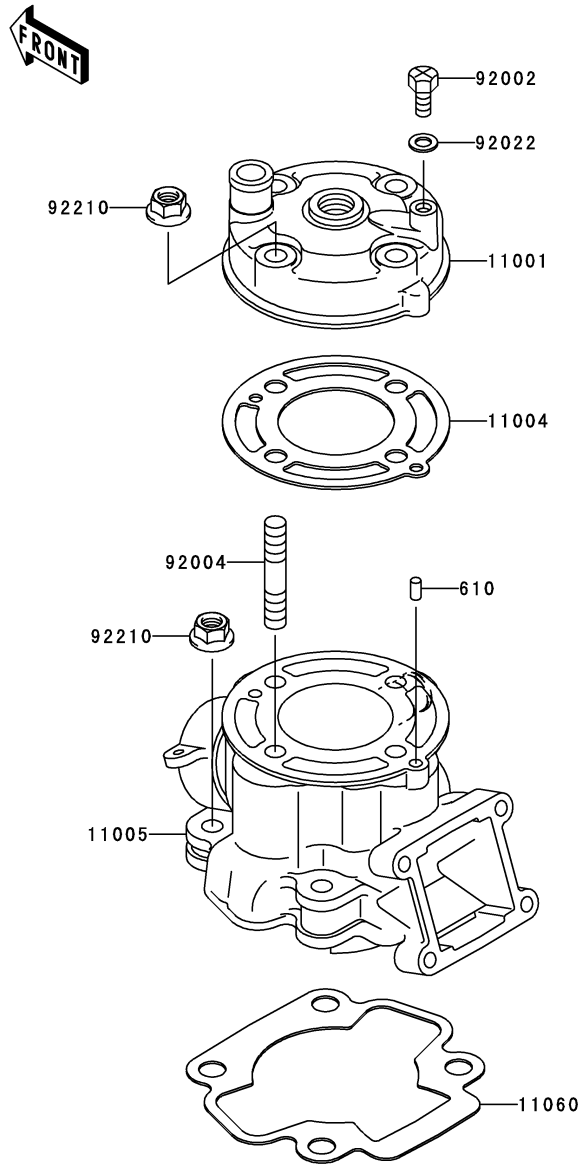

This catalog covers:  
**'10 KX65AAF Engine**

GRID NO. **B-4** This grid covers:  
**Air Cleaner**

E1130

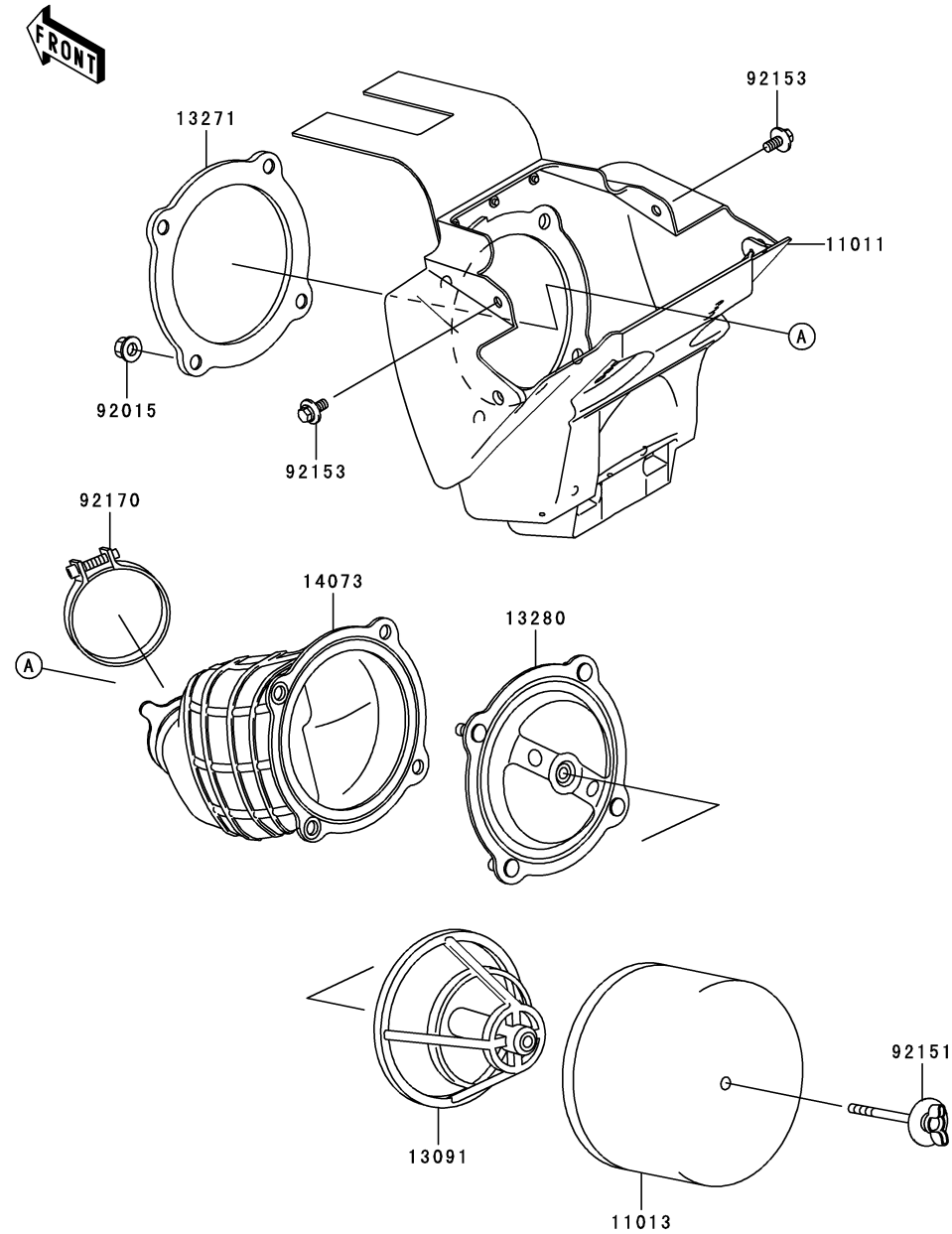

Ref. No.	Part No.	Description	Spec Code	Quantity-KX65			
				'10			
11011	11011-1578	CASE-AIR FILTER					1
11013	11013-1284	ELEMENT-AIR FILTER					1
13091	13091-1696	HOLDER,ELEMENT					1
13271	13271-1298	PLATE,AIR FILTER					1
13280	13280-1142	HOLDER,AIR FILTER ELEMENT					1
14073	14073-1759	DUCT,AIR FILTER					1
92015	92015-1259	NUT,FLANGED,5MM					4
92151	92151-1256	BOLT,AIR FILTER					1
92153	92153-0936	BOLT,FLANGED,6X14					2
92170	92170-1686	CLAMP					1

E1140

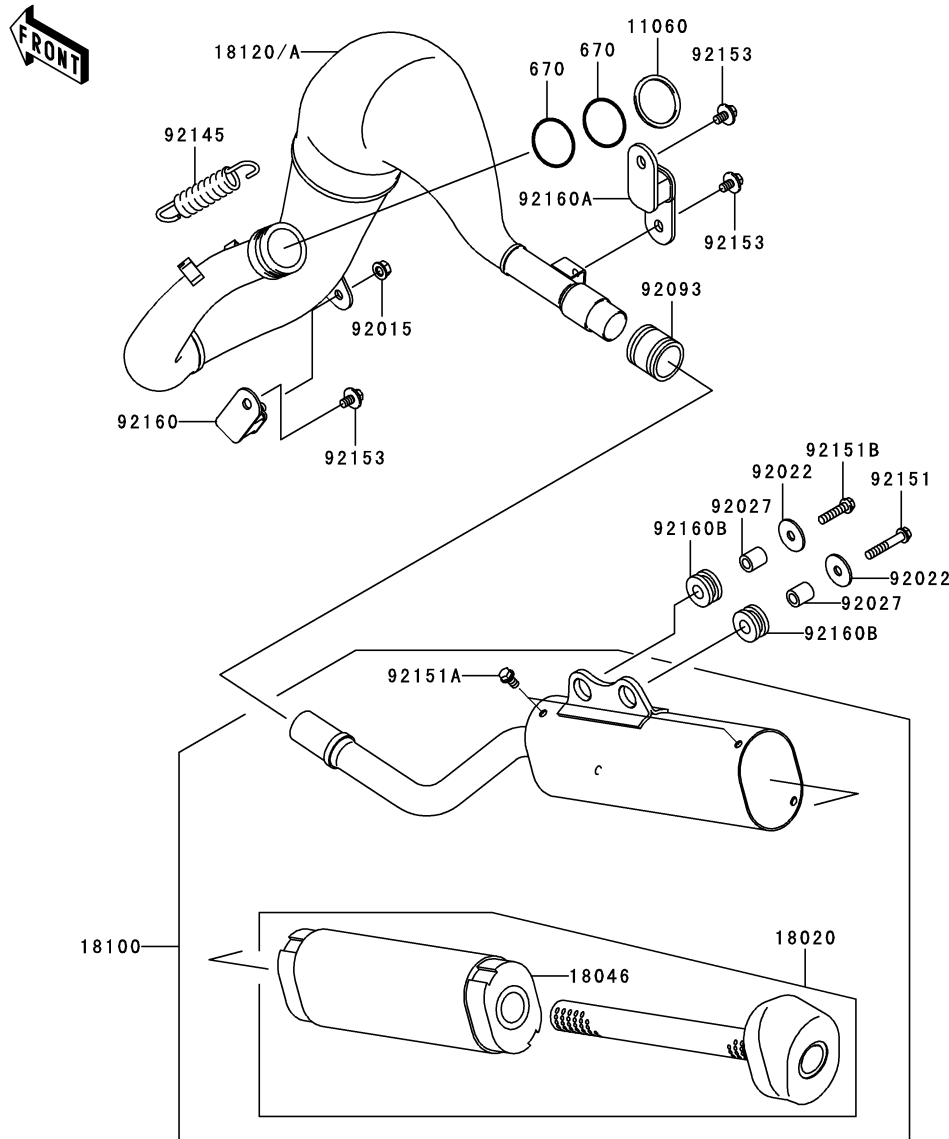

Ref. No.	Part No.	Description	Spec Code	Quantity-KX65	
				'10	AAF
11060	11060-1922	GASKET,EXHAUST		1	
18020	18020-0038	BAFFLE		1	
18046	18046-0049	WOOL,BAFFLE		1	
18100	18100-0025	BODY-ASSY-MUFFLER		1	
18120	18120-1116	CHAMBER-EXHAUST		1	
18120A	18120-1119 (OPTION)	CHAMBER-EXHAUST		1	
92015	92015-1078	NUT,FLANGED,6MM		1	
92022	92022-237	WASHER,6.5X22X1.6		2	
92027	92027-1210	COLLAR,6.8X10X11.5		2	
92093	92093-1511	SEAL		1	
92145	92145-1340	SPRING,EXHAUST CONNECTING		2	
92151	92151-1135	BOLT,6X35		1	
92151A	92151-1822	BOLT,FLANGED,6X10		4	
92151B	92151-1930	BOLT,FLANGED-SMALL,6X25		1	
92153	92153-0503	BOLT,6X12		3	
92160	92160-1176	DAMPER,MUFFLER,FR		1	
92160A	92160-1201	DAMPER,MUFFLER,RR		1	
92160B	92160-1913	DAMPER		2	
670	670E3032	O RING,32MM		2	

This catalog covers:  
**'10 KX65AAF Engine**

GRID NO.

**B-6**

This grid covers:  
**Crankshaft/Piston(s)**

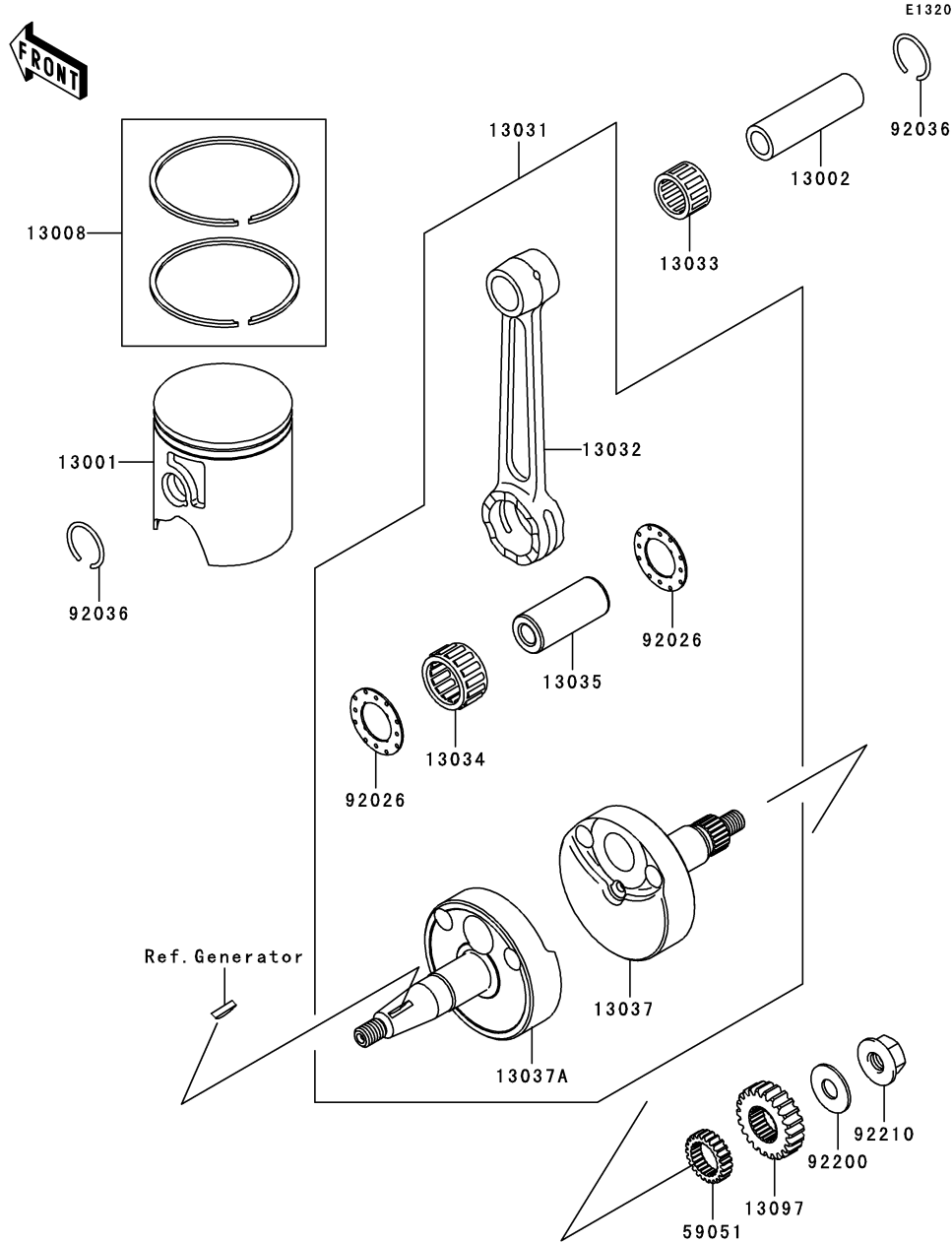

Ref. No.	Part No.	Description	Spec Code	Quantity-KX65	
				'10	AAF
13001	13001-0040	PISTON-ENGINE,B		1	
13002	13002-1119	PIN-PISTON		1	
13008	13008-1199	RING-SET-PISTON		1	
13031	13031-0039	CRANKSHAFT-COMP		1	
13032	13032-1246	ROD-CONNECTING		1	
13033	13033-0002	BEARING-SMALL END		1	
13034	13034-0012	BEARING-BIG END,SKTZ 202714EGS		1	
13035	13035-1002	PIN-CRANK		1	
13037	13037-0049	CRANKSHAFT,RH		1	
13037A	13037-1615	CRANKSHAFT,LH		1	
13097	13097-0055	GEAR-PRIMARY SPUR,22T		1	
59051	59051-1146	GEAR-SPUR,PUMP,23T		1	
92026	92026-1522	SPACER		2	
92036	92036-007	RING-SNAP,PISTON PIN		2	
92200	92200-0213	WASHER,10.2X25X1.5		1	
92210	92210-0215	NUT,FLANGED,M10XL1.25		1	

E1340

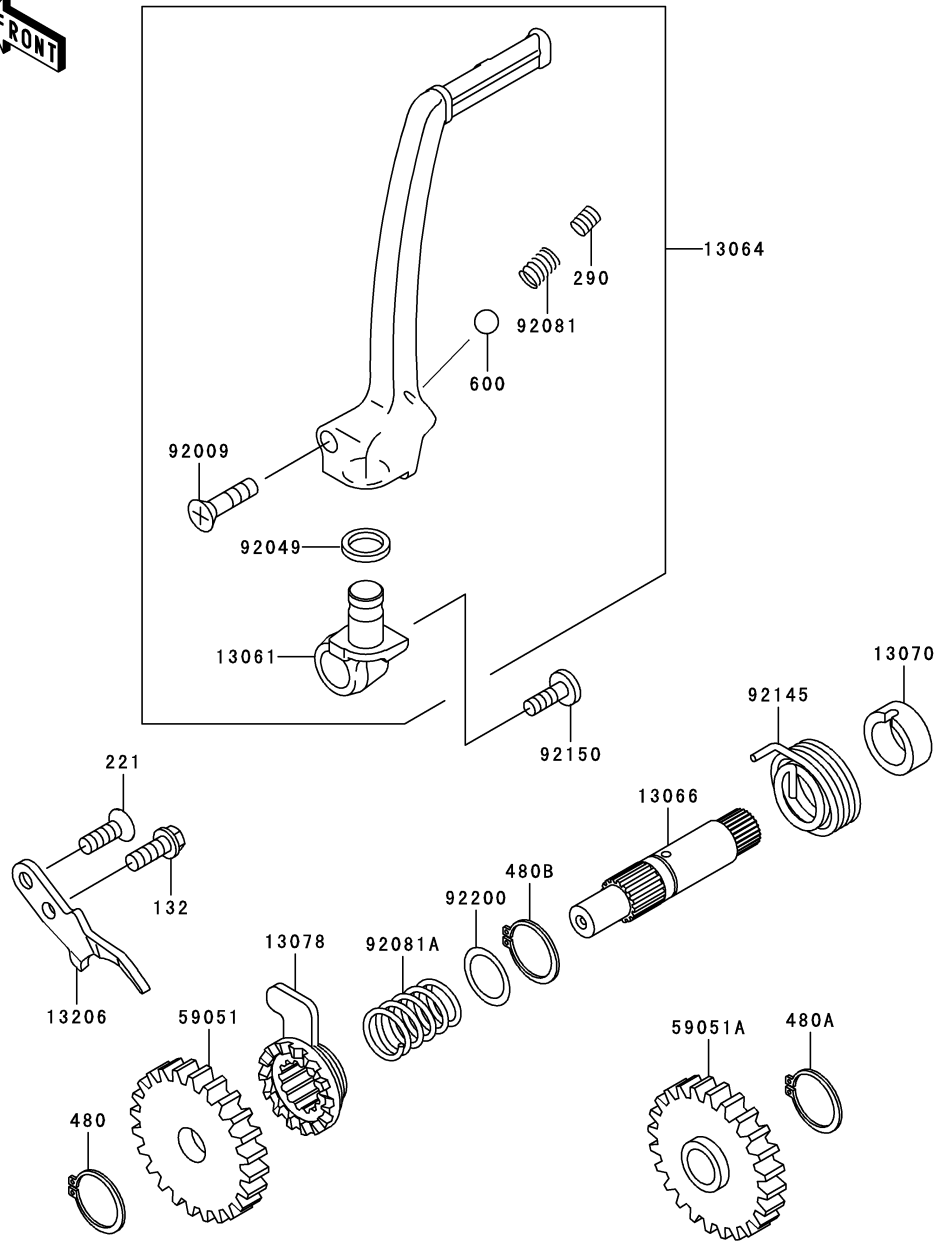

Ref. No.	Part No.	Description	Spec Code	Quantity-KX65			
				'10			
				AA	F		
13061	13061-1712	BOSS,KICK PEDAL					1
13064	13064-1196	LEVER-ASSY-KICK,PEDAL					1
13066	13066-1097	SHAFT-KICK					1
13070	13070-1314	GUIDE					1
13078	13078-1004	RATCHET					1
13206	13206-1067	GUIDE-KICK					1
59051	59051-1026	GEAR-SPUR,32T					1
59051A	59051-1027	GEAR-SPUR,30T					1
92009	92009-1607	SCREW,6X27					1
92049	92049-1468	SEAL-OIL,SR12162.5					1
92081	92081-020	SPRING,KICK PEDAL					1
92081A	92081-122	SPRING,RATCHET					1
92145	92145-1058	SPRING					1
92150	92150-1673	BOLT,SOCKET,6X16					1
92200	92200-1209	WASHER,KICKSHAFT					1
132	132BA0616	BOLT-FLANGED-SMALL,6X16					1
221	221AA0618	SCREW-CSK-CROS,6X18					1
290	290CA0808	SCREW-SET-SOCKET,8X8					1
480	480J1200	CIRCLIP-TYPE-C,12MM					1
480A	480J1500	CIRCLIP-TYPE-C,15MM					1
480B	480J1600	CIRCLIP-TYPE-C,16MM					1
600	600A0800	BALL-STEEL,1/4"					1

This catalog covers:  
**'10 KX65AAF Engine**

GRID NO. **B-8** This grid covers:  
**Clutch**

E1350

Ref. No.	Part No.	Description	Spec Code	Quantity-KX65	
				'10	AAF
13086	13086-1002	WHEEL-CLUTCH		1	
13087	13087-1051	HUB-CLUTCH		1	
13088	13088-1010	PLATE-FRICTION		5	
13089	13089-1087	PLATE-CLUTCH		4	
13091	13091-1115	HOLDER,CLUTCH SPRING		1	
13091A	13091-1133	HOLDER,CLUTCH PUSHER		1	
13095	13095-1042	HOUSING-COMP-CLUTCH		1	
13114	13114-1055	PUSHER-CLUTCH		1	
13236	13236-1338	LEVER-COMP,RELEASE		1	
92002	92002-1697	BOLT,10X30		1	
92022	92022-255	WASHER,17.3X28X1		2	
92028	92028-1967	BUSHING		1	
92045	92045-1236	BEARING-BALL,627		1	
92081	92081-1175	SPRING,CLUTCH		6	
92200	92200-1197	WASHER,7X12.5X0.8		1	
130	130CA0520	BOLT-FLANGED,5X20		6	

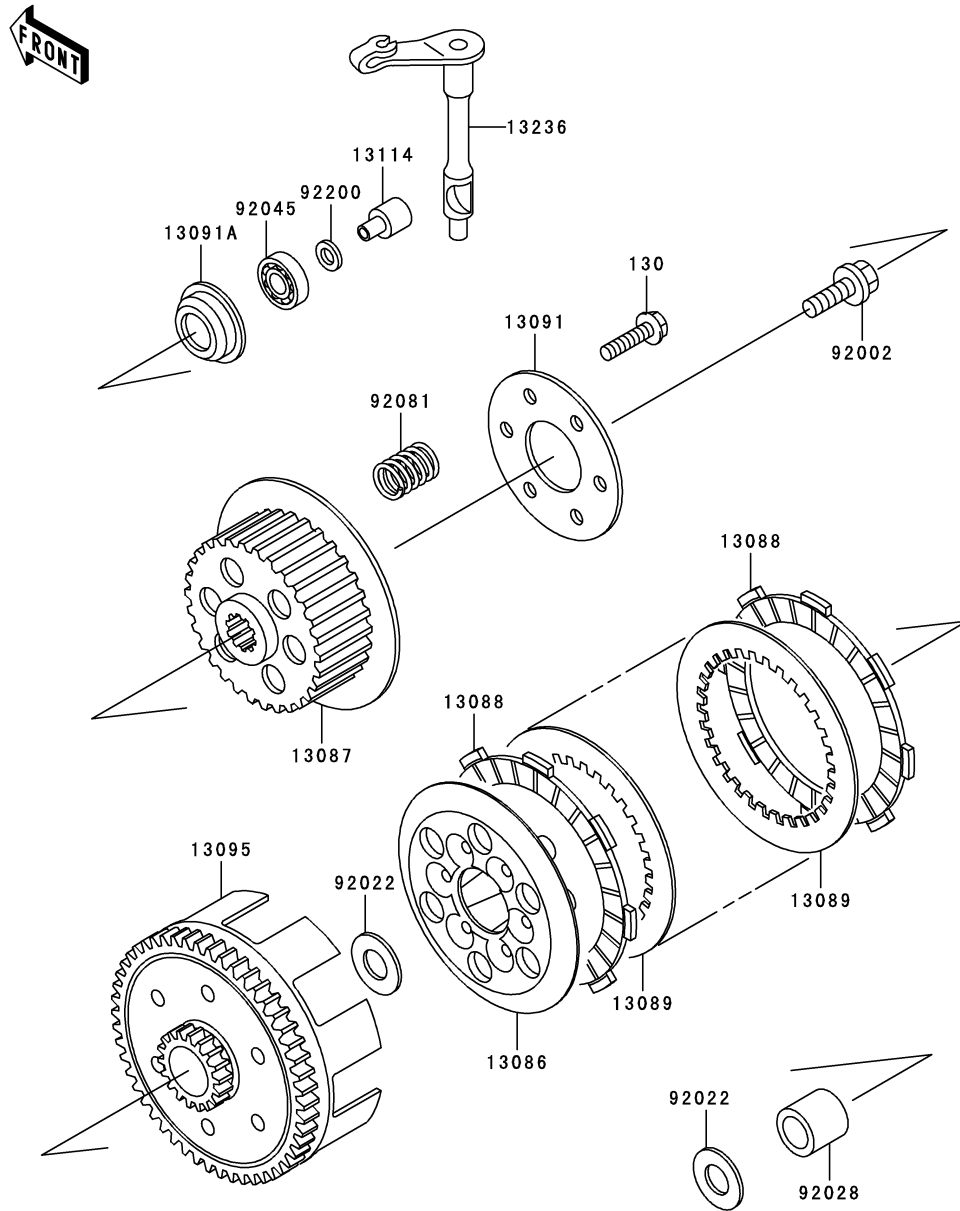

E1361

Ref. No.	Part No.	Description	Spec Code	Quantity-KX65			
				'10			
				AAF			
13127	13127-1105	SHAFT-TRANSMISSION INPUT,13T					1
13128	13128-0016	SHAFT-TRANSMISSION OUTPUT					1
13129	13129-1215	GEAR,INPUT 2ND,16T					1
13129A	13129-1343	GEAR,INPUT 5TH,23T					1
13129B	13129-1345	GEAR,OUTPUT 2ND,34T					1
13129C	13129-1348	GEAR,OUTPUT 5TH,28T					1
13129D	13129-1349	GEAR,OUTPUT TOP,26T					1
13129E	13129-1515	GEAR,OUTPUT LOW,37T					1
13129F	13129-1611	GEAR,INPUT 3RD&4TH,21T&18T					1
13129G	13129-1612	GEAR,OUTPUT 4TH,30T					1
13129H	13129-1654	GEAR,OUTPUT 3RD,31T					1
13144	13144-1022	SPROCKET-OUTPUT,14T					1
		(OPTION)					
13144A	13144-1023	SPROCKET-OUTPUT,13T					1
13260	13260-1542	GEAR,INPUT TOP,24T					1
92033	92033-029	RING-SNAP,18MM					1
92033A	92033-1060	RING-SNAP,17MM					2
92033B	92033-1079	RING-SNAP,18MM					3
92055	92055-022	RING-O,17.5X1.5					2
92152	92152-0195	COLLAR,20X25X12.9					1

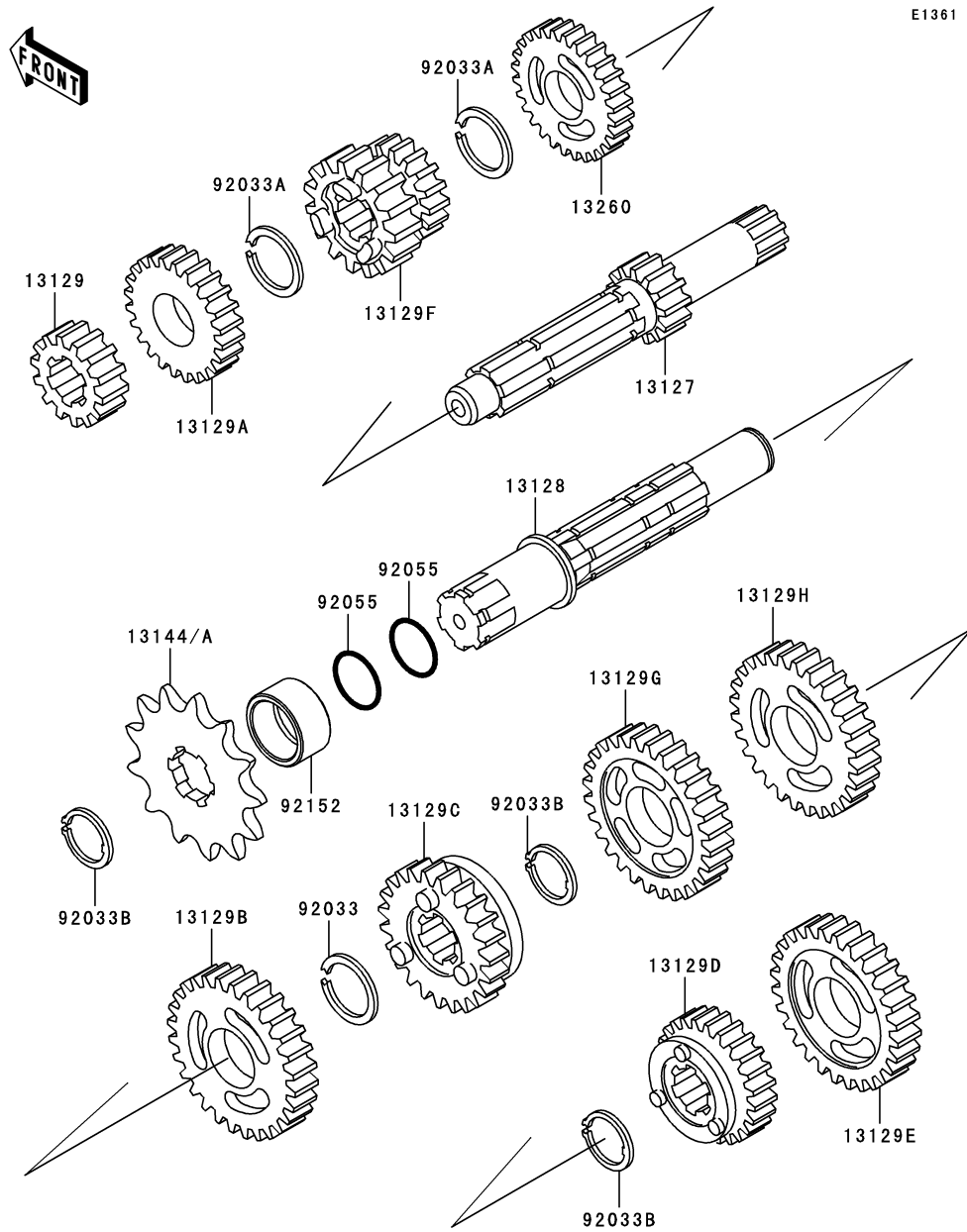

E1362

Ref. No.	Part No.	Description	Spec Code	Quantity-KX65			
				'10			
13140	13140-1300	FORK-SHIFT,INPUT		1			
13140A	13140-1301	FORK-SHIFT,OUTPUT		2			
13141	13141-1220	DRUM-CHANGE		1			
13271	13271-1417	PLATE		1			
13280	13280-1179	HOLDER		1			
49047	49047-1009	ROD-SHIFT,10X90		2			
92009	92009-1862	SCREW,6X14		1			
92042	92042-014	PIN,DOWEL,4X15.8		6			
92150	92150-1604	BOLT,SOCKET,8X30		1			
610	610A0408	ROLLER,4X8		1			

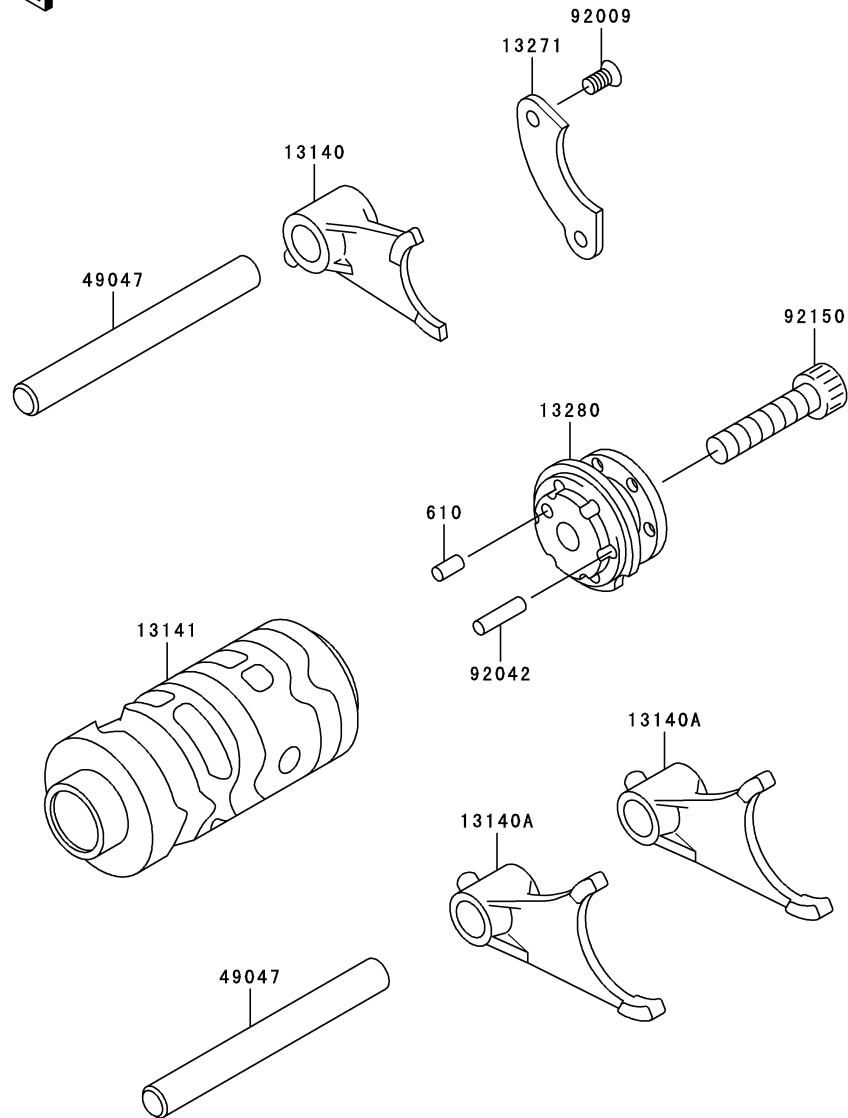



E1370

Ref. No.	Part No.	Description	Spec Code	Quantity-KX65		
				'10		

13156	13156-1347 (OPTION)	LEVER-CHANGE,PEDAL		1
13161	13161-1280	LEVER-COMP-CHANGE SHAFT		1
13236	13236-1026	LEVER-COMP,CHANGE DRUM		1
13236A	13236-1376	LEVER-COMP,CHANGE		1
13242	13242-1366	LEVER-ASSY-CHANGE,PEDAL,STEEL		1
92002	92002-1237	BOLT,6X20		1
92009	92009-1102	SCREW,CHANGE LEVER		1
92081	92081-1109	SPRING,CHANGE LEVER		1
92081A	92081-1129	SPRING,TENSION		1
92081B	92081-1275	SPRING,CHANGE LEVER		1

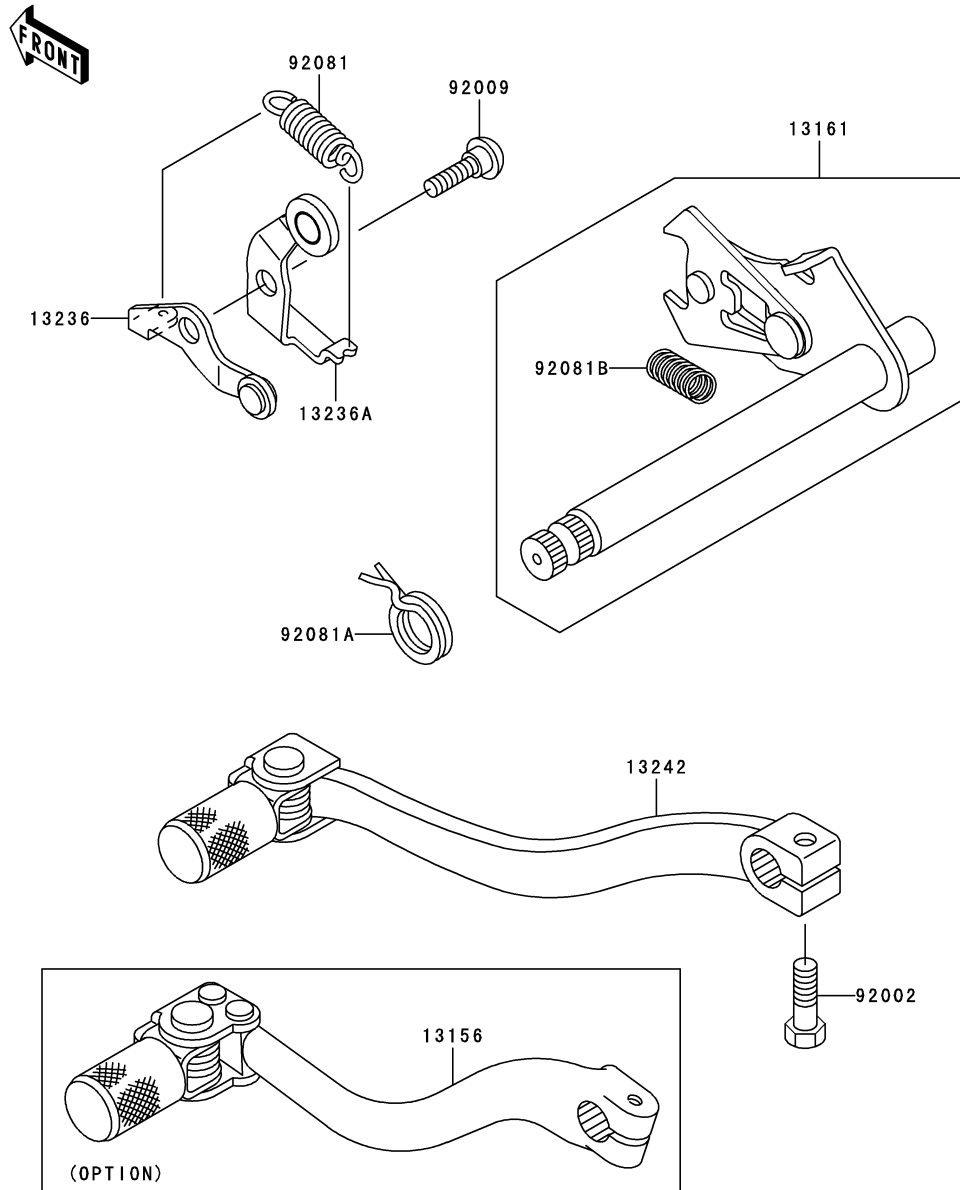

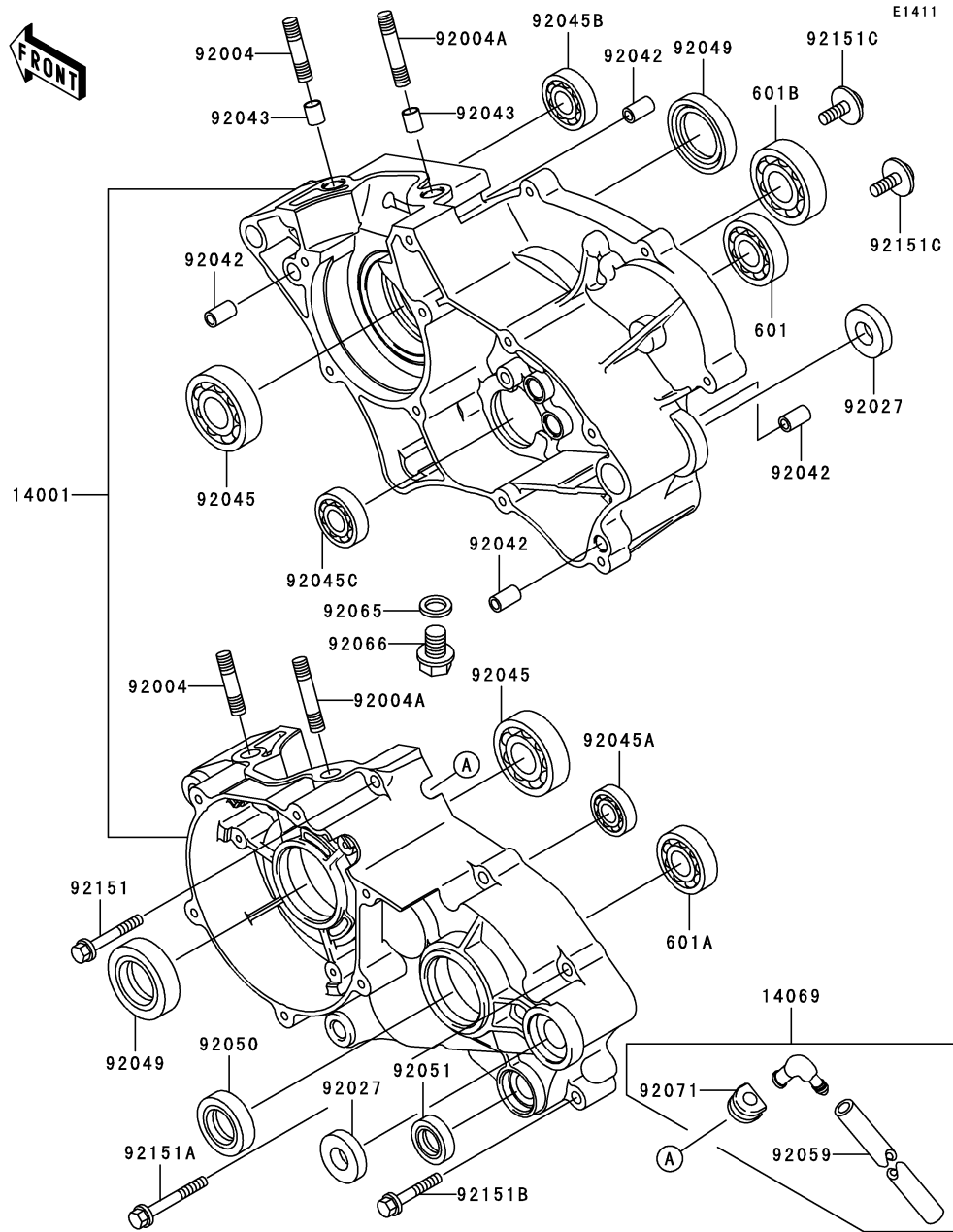

Ref. No.	Part No.	Description	Spec Code	Quantity-KX65	
				'10	AAF
14001	14001-0119	SET-CRANKCASE			1
14069	14069-1003	BREATHER			1
92004	92004-0019	STUD,8X30			2
92004A	92004-0020	STUD,8X38			2
92027	92027-1744	COLLAR,12.1X26X6			2
92042	92042-007	PIN,DOWEL,6.3X8X14			4
92043	92043-1264	PIN,8.2X10X14			2
92045	92045-1059	BEARING-BALL,R-6304C3			2
92045A	92045-1235	BEARING-BALL,6001C3ML01			1
92045B	92045-1304	BEARING-BALL,626MC3			1
92045C	92045-1432	BEARING-BALL,6805JRZ			1
92049	92049-1188	SEAL-OIL,SD20407GS			2
92050	92050-013	SEAL-OIL,SC25376			1
92051	92051-005	SEAL-OIL,TB13225.5			1
92059	92059-1074	TUBE,6X9X280			1
92065	92065-058	GASKET,10.5X16X1			1
92066	92066-1437	PLUG,DRAIN			1
92071	92071-042	GROMMET,BREATHER			1
92151	92151-1131	BOLT,6X40			5
92151A	92151-1132	BOLT,6X55			1
92151B	92151-1135	BOLT,6X35			3
92151C	92151-1762	BOLT,6X16			2
601	601A6002	BEARING-BALL,#6002			1
601A	601A6004	BEARING-BALL,#6004			1
601B	601A6203	BEARING-BALL,#6203			1

This catalog covers:  
**'10 KX65AAF Engine**

GRID NO. **B-13** This grid covers:  
**Engine Cover(s)**

E1431

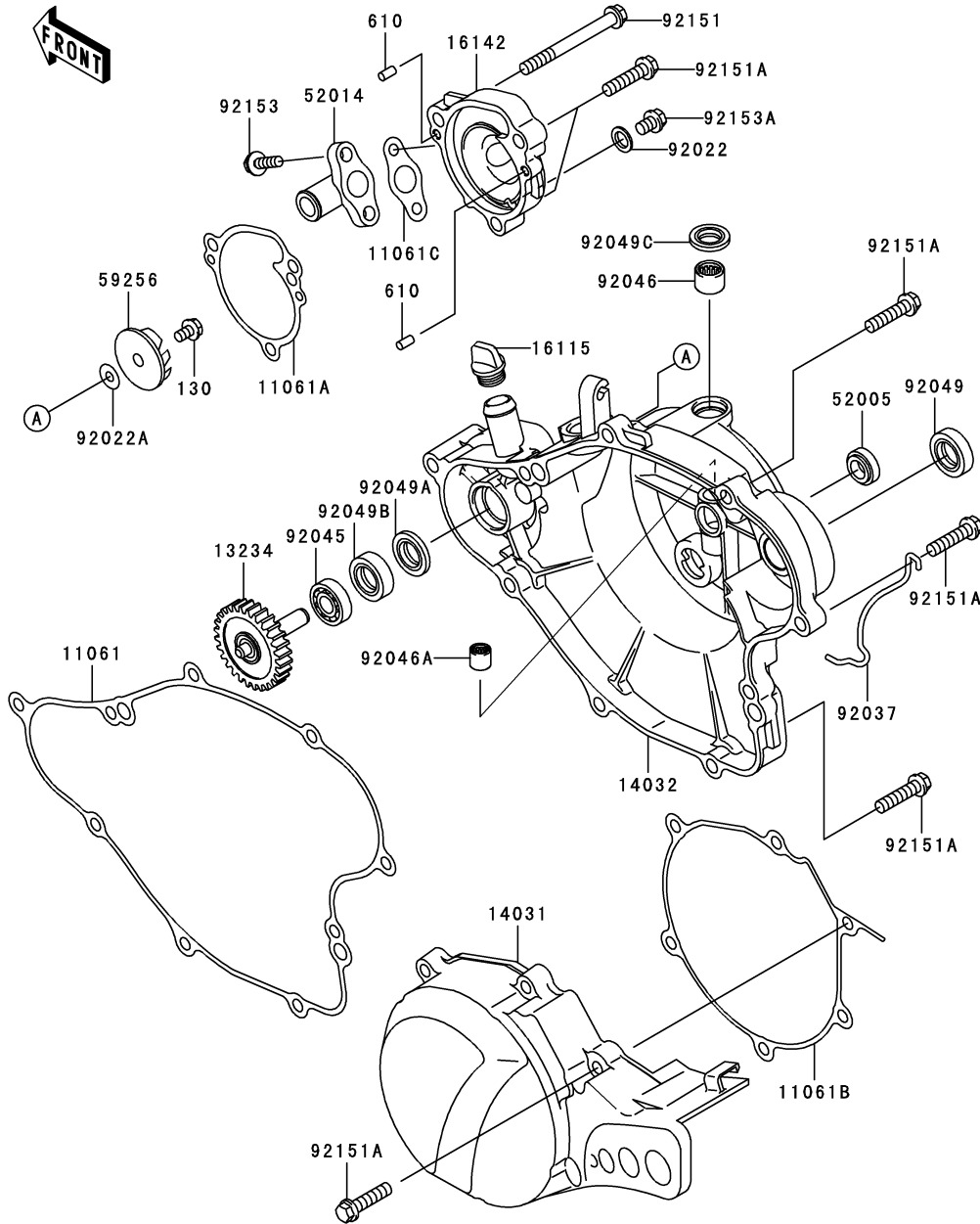

Ref. No.	Part No.	Description	Spec Code	Quantity-KX65	
				'10	AAF
11061	11061-0121	GASKET,CLUTCH COVER		1	
11061A	11061-0159	GASKET,WATER PUMP COVER		1	
11061B	11061-0193	GASKET,GENERATOR COVER		1	
11061C	11061-0202	GASKET,ELBOW		1	
13234	13234-1110	SHAFT-COMP,PUMP		1	
14031	14031-0107	COVER-GENERATOR		1	
14032	14032-0133	COVER-CLUTCH		1	
16115	16115-018	CAP-OIL FILLER		1	
16142	16142-0023	COVER-PUMP		1	
52005	52005-0019	GAUGE,OIL LEVEL		1	
52014	52014-1094	ELBOW		1	
59256	59256-1064	IMPELLER		1	
92022	92022-077	WASHER,6.1X12X1		1	
92022A	92022-1380	WASHER,5.2X13X1		1	
92037	92037-1236	CLAMP,TUBE		1	
92045	92045-1305	BEARING-BALL,608MC3		1	
92046	92046-1160	BEARING-NEEDLE,HK1010		1	
92046A	92046-1217	BEARING-NEEDLE,6BTM109		1	
92049	92049-002	SEAL-OIL,SB16244		1	
92049A	92049-1359	SEAL-OIL,MH8X18X3.5-A		1	
92049B	92049-1366	SEAL-OIL,MHSD8X18X10J-1		1	
92049C	92049-1414	SEAL-OIL,BG1408F0		1	
92151	92151-1235	BOLT,6X60		1	
92151A	92151-1930	BOLT,FLANGED-SMALL,6X25		16	
92153	92153-0859	BOLT,5X16		2	
92153A	92153-0860	BOLT,6X8		1	
130	130CA0510	BOLT-FLANGED,5X10		1	
610	610A0408	ROLLER,4X8		2	



This catalog covers:  
**'10 KX65AAF Engine**

GRID NO.

**C-3**

This grid covers:  
**Carburetor(2/2)**

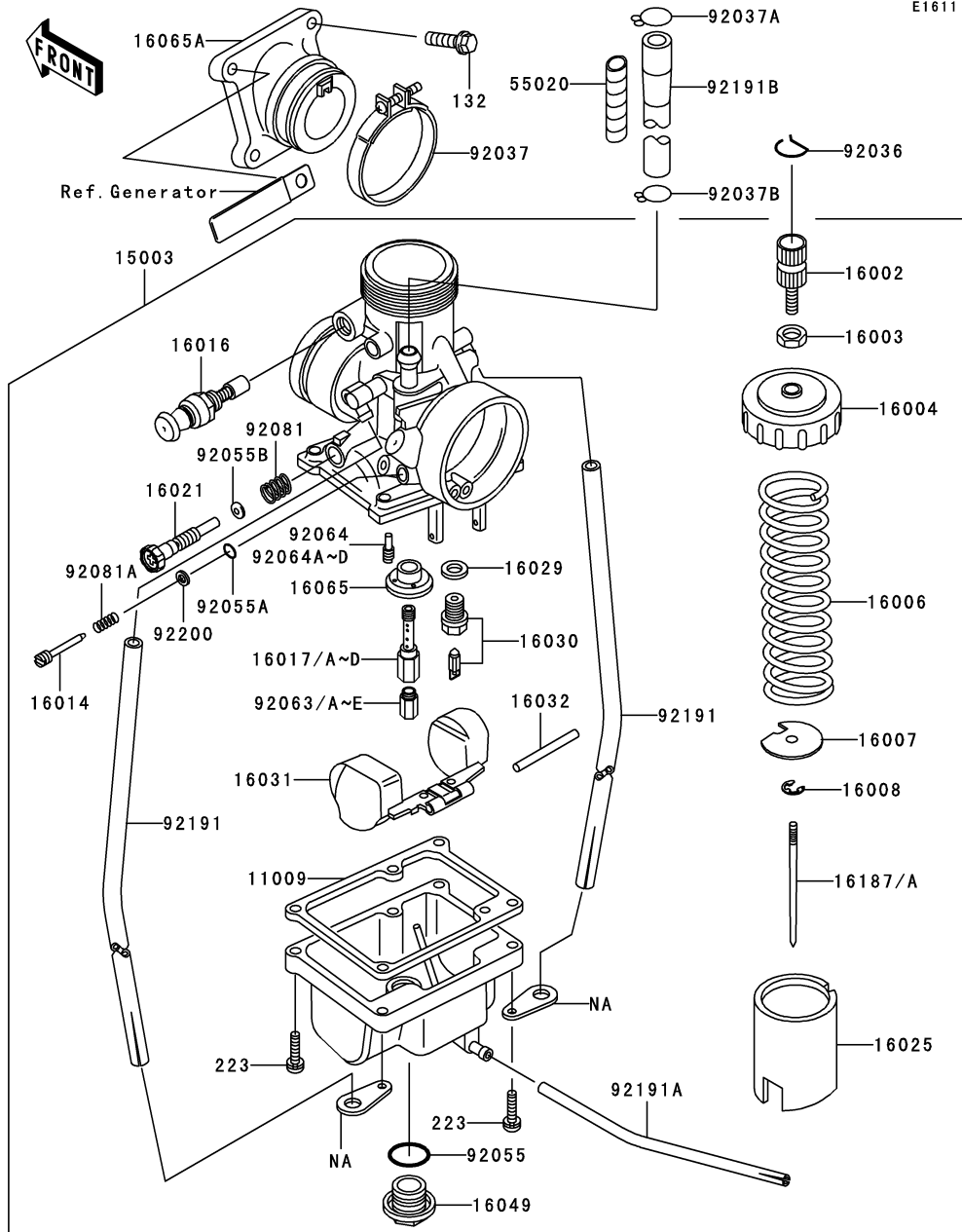

E1611

Ref. No.	Part No.	Description	Spec Code	Quantity-KX65	
				'10	AAF
92063	92063-019	JET-MAIN,#170			1
	(OPTION)				
92063A	92063-020	JET-MAIN,#180			1
	(OPTION)				
92063B	92063-021	JET-MAIN,#190			1
92063C	92063-022	JET-MAIN,#200			1
	(OPTION)				
92063D	92063-023	JET-MAIN,#210			1
	(OPTION)				
92063E	92063-025	JET-MAIN,#230			1
	(OPTION)				
92064	92064-021	JET-PILOT,#20			1
	(OPTION)				
92064A	92064-022	JET-PILOT,#30			1
	(OPTION)				
92064B	92064-032	JET-PILOT,#25			1
92064C	92064-040	JET-PILOT,#22.5			1
	(OPTION)				
92064D	92064-1033	JET-PILOT,#27.5			1
	(OPTION)				
92081	92081-1152	SPRING,THROTTLE ADJUST			1
92081A	92081-1153	SPRING,STOP SCREW			1
92191	92191-1495	TUBE,3X5X280			2
92191A	92191-1496	TUBE,3X5X220			1
92191B	92191-1611	TUBE			1
92200	92200-1564	WASHER,PILOT AIR SCREW			1
132	132BC0620	BOLT-FLANGED-SMALL,6X20			4
223	223AA0416	SCREW-PAN-WS-CROS,4X16			4

This catalog covers:  
**'10 KX65AAF Engine**

GRID NO. **C-4** This grid covers:  
**Generator**

E1810

Ref. No.	Part No.	Description	Spec Code	Quantity-KX65	
				'10	AAF
21003	21003-0031	STATOR			1
21007	21007-0052	ROTOR			1
21119	21119-0047	IGNITER			1
92015	92015-077	NUT,FLANGED,10MM			1
92037	92037-1173	CLAMP			2
92038	92038-001	KEY,WOODRUFF			1
92072	92072-1293	BAND,L=140			1
92153	92153-0863	BOLT,6X16			2
92171	92171-0652	CLAMP			1
224	224AA0614	SCREW-PAN-WP-CROS,6X14			3

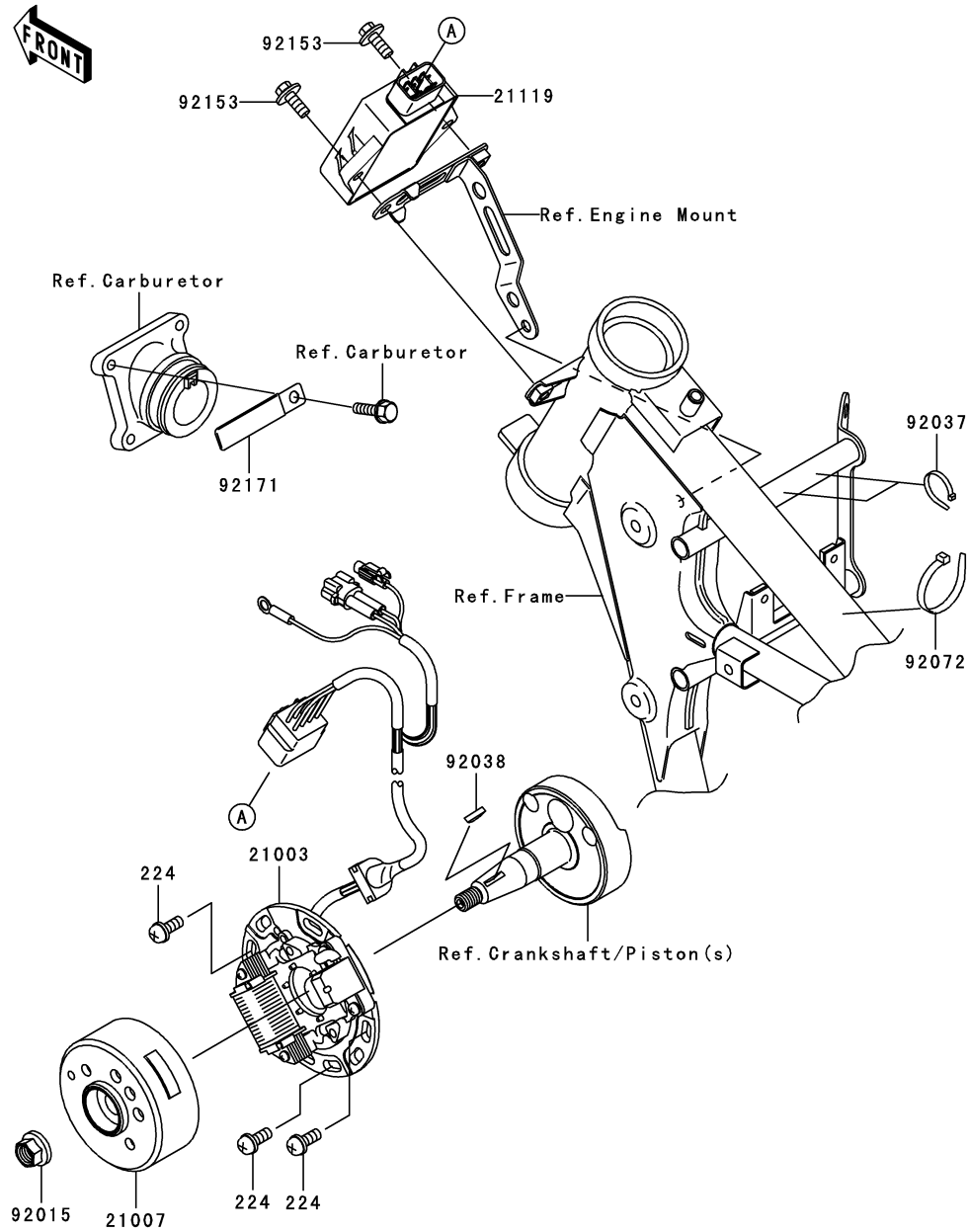

This catalog covers:  
**'10 KX65AAF Engine**

GRID NO. **C-5** This grid covers:  
**Ignition System**

E1830

Ref. No.	Part No.	Description	Spec Code	Quantity-KX65			
				'10			
21121	21121-0022	COIL-IGNITION					1
21130	21130-1077	CAP-SPARK PLUG					1
92037	92037-1173	CLAMP					1
92070	92070-1133	PLUG-SPARK,BR10EG(NGK),SOLID					1
92070A	92070-1272 (OPTION)	PLUG-SPARK,BR10EIX(NGK)					1
92151	92151-1311	BOLT,6X18					2

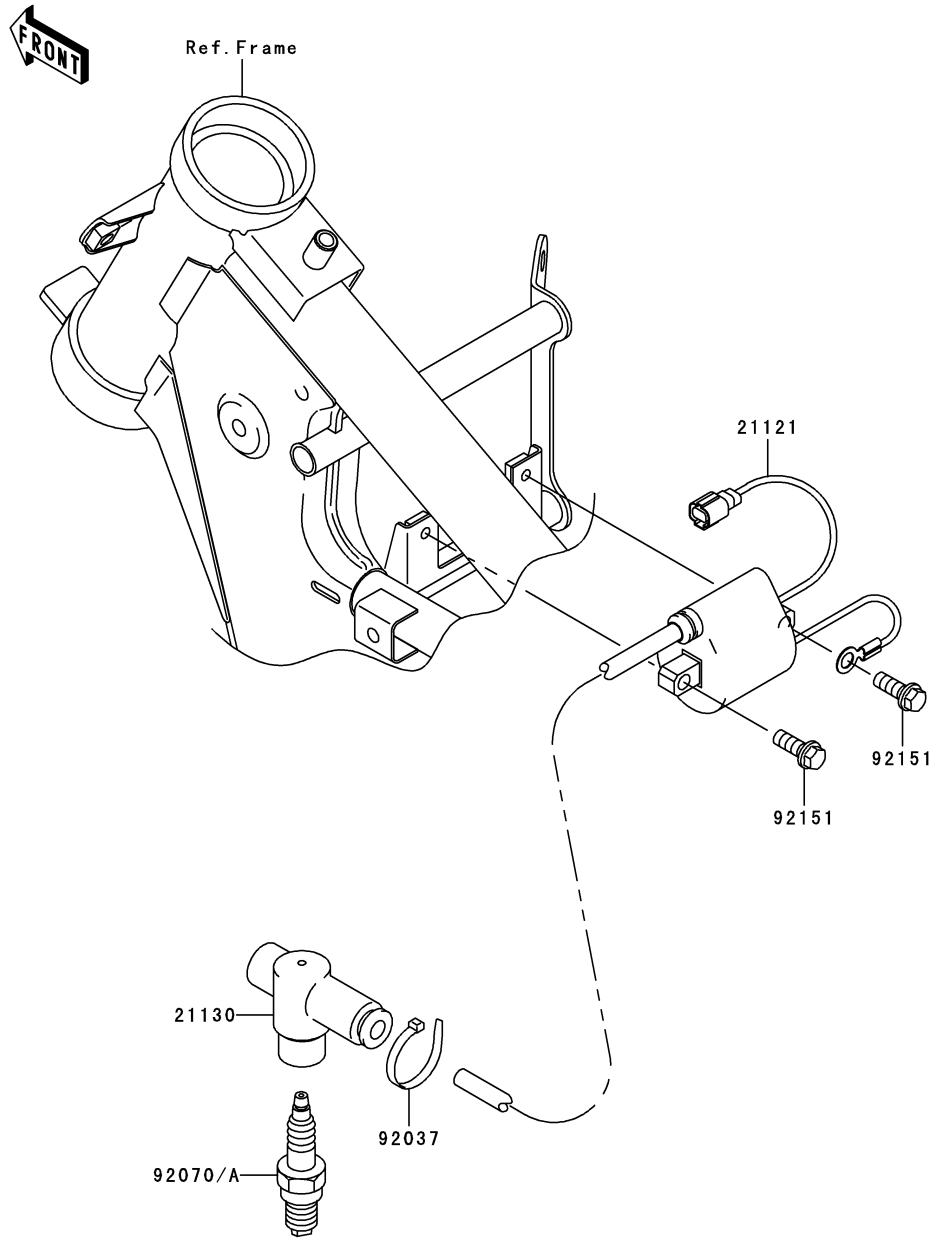

This catalog covers:  
**'10 KX65AAF Engine**

GRID NO.

**C-6**

This grid covers:  
**Radiator**

E3032

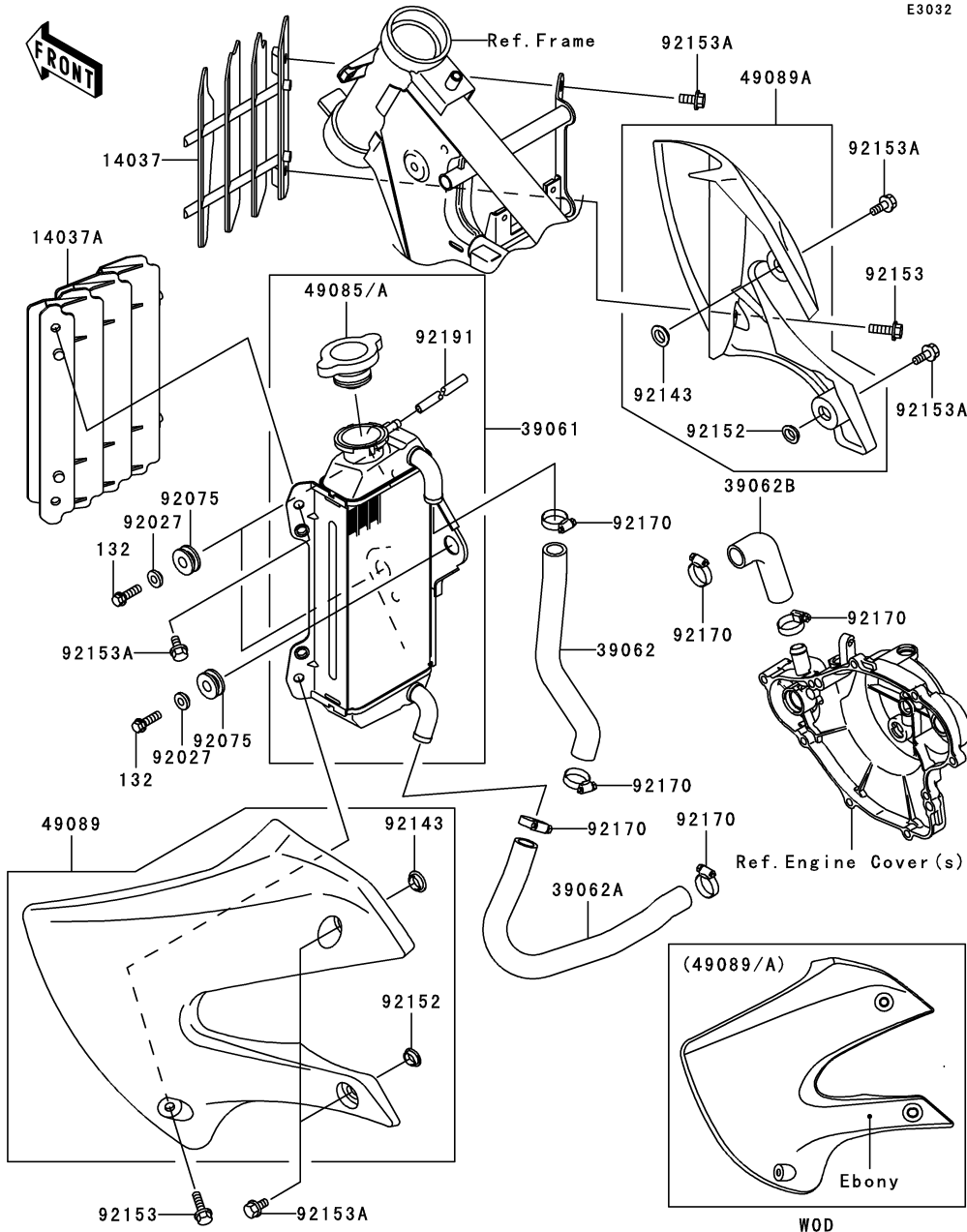

Ref. No.	Part No.	Description	Spec Code	Quantity-KX65	
				'10	AAF
14037	14037-0047-6C	SCREEN,RH,EBONY		1	
14037A	14037-1266-6C	SCREEN,LH,EBONY		1	
39061	39061-1277	RADIATOR-ASSY		1	
39062	39062-1808	HOSE-COOLING,HEAD-RADIATOR		1	
39062A	39062-1809	HOSE-COOLING,PUMP-RADIATOR		1	
39062B	39062-1810	HOSE-COOLING,PIPE-CYLINDER		1	
49085	49085-1076	CAP-ASSY-PRESSURE,P1.1		1	
49085A	49085-1077	CAP-ASSY-PRESSURE,P1.8		1	
	(OPTION)				
49089	49089-1144-6C	SHROUD-ENGINE,LH,EBONY		1	
49089A	49089-1145-6C	SHROUD-ENGINE,RH,EBONY		1	
92027	92027-194	COLLAR,L=11.1		3	
92075	92075-209	DAMPER		3	
92143	92143-1196	COLLAR		2	
92152	92152-1235	COLLAR		2	
92153	92153-0502	BOLT,6X20		2	
92153A	92153-0503	BOLT,6X12		6	
92170	92170-1283	CLAMP		6	
92191	92191-1434	TUBE		1	
132	132BC0620	BOLT-FLANGED-SMALL,6X20		3	



This catalog covers:  
**'10 KX65AAF Chassis**

GRID NO. This grid covers:

**D-3** **Frame**

F2120

Ref. No.	Part No.	Description	Spec Code	Quantity-KX65			
				'10			
32160	32160-0117-18R	FRAME-COMP,F.S.BLACK					1
32160A	32160-1611-18R	FRAME-COMP,SUB,F.S.BLACK					1
92015	92015-1684	NUT,STEERING STEM,25MM					1
92116	92116-1065	BEARING-ROLLER,H1-CAP32005JRRS					2
92150	92150-1760	BOLT,SOCKET,8X20					2

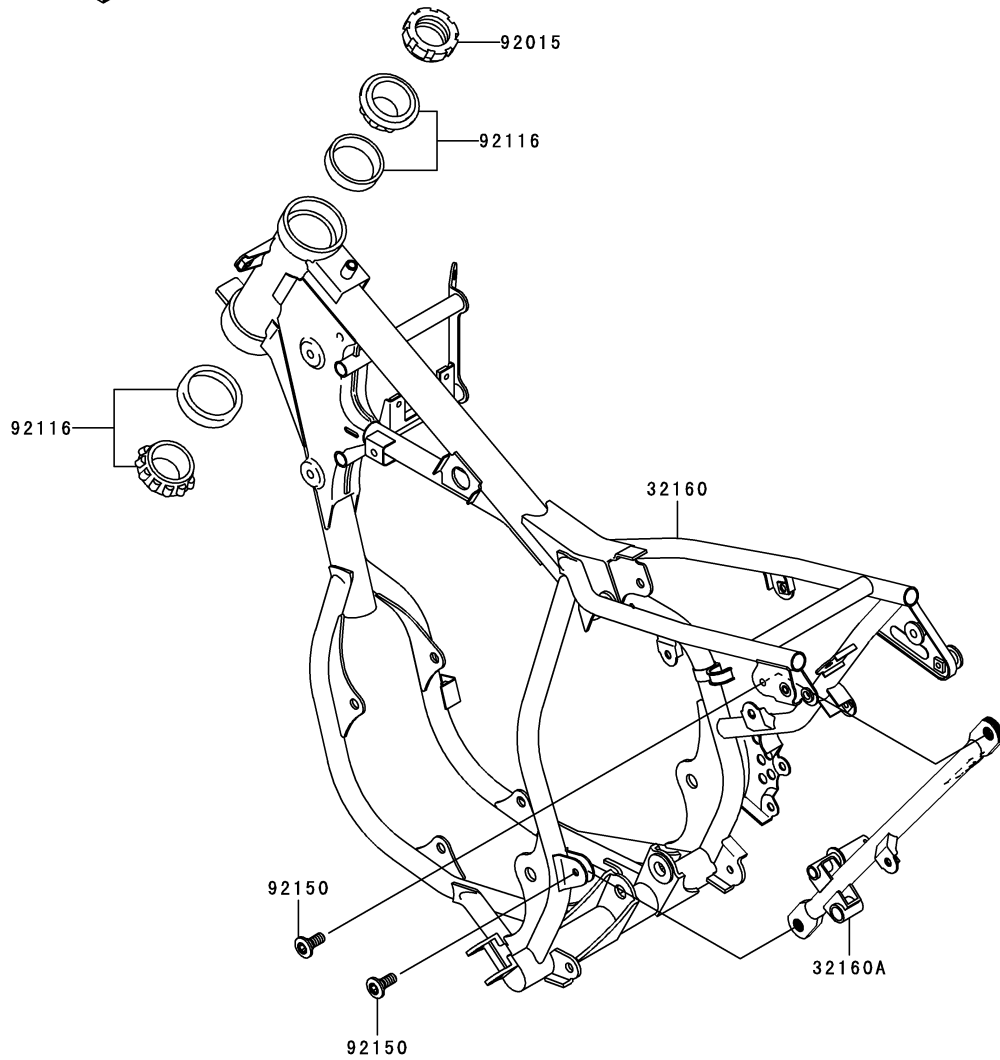

This catalog covers:

'10 KX65AAF Chassis

GRID NO.

**D-4**

This grid covers:

**Engine Mount**

F2122

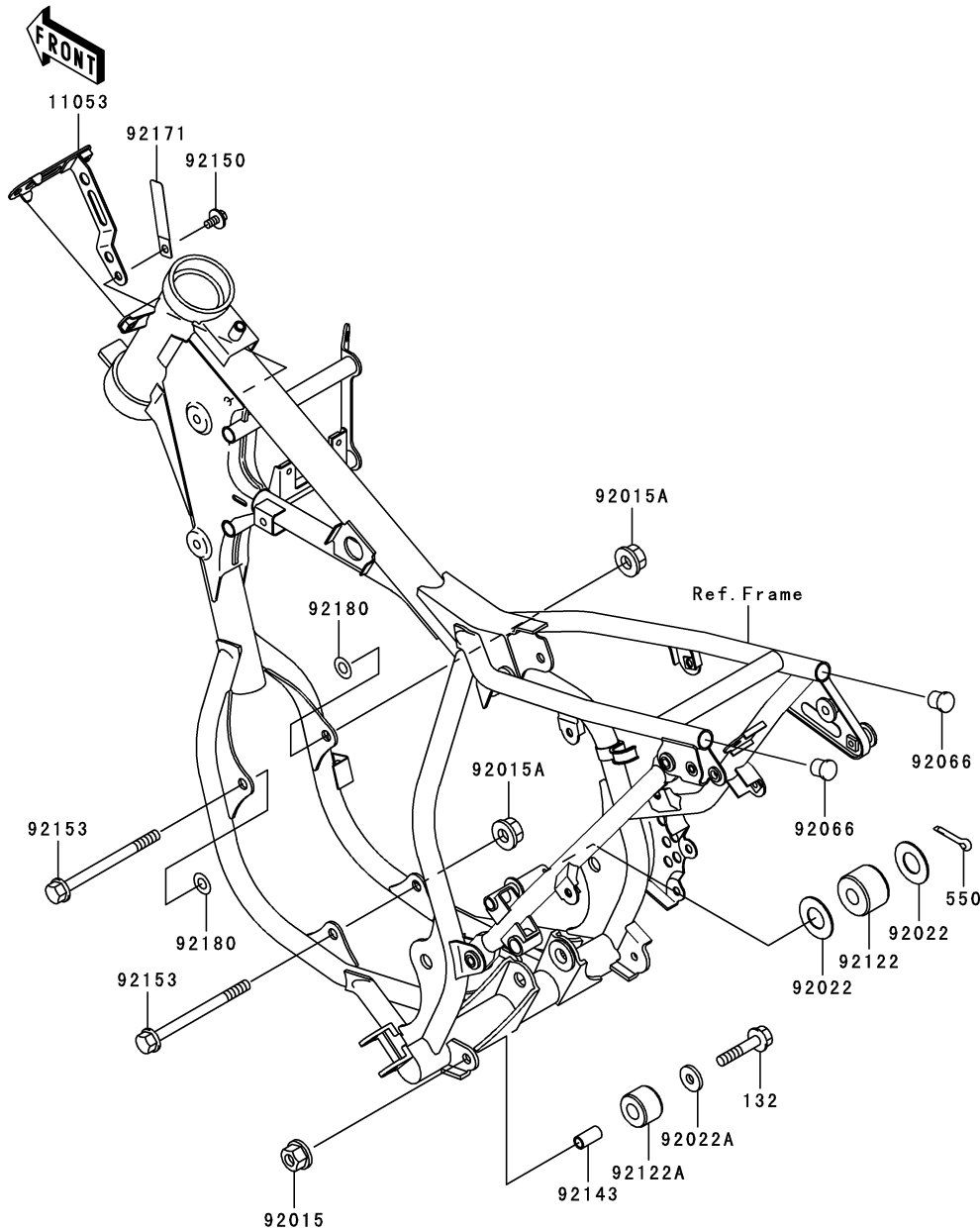

Ref. No.	Part No.	Description	Spec Code	Quantity-KX65		
				'10	AAF	
11053	11053-1682	BRACKET,IGNITER			1	
92015	92015-1143	NUT,8MM			1	
92015A	92015-1432	NUT,8MM			2	
92022	92022-107	WASHER			2	
92022A	92022-1561	WASHER,8.5X20X1.6			1	
92066	92066-1081	PLUG			2	
92122	92122-1179	ROLLER,CHAIN GUIDE			1	
92122A	92122-1213	ROLLER,CHAIN GUIDE			1	
92143	92143-1432	COLLAR,9.5X12.7X25			1	
92150	92150-1891	BOLT,6X12			1	
92153	92153-1095	BOLT,FLANGED,8X110			2	
92171	92171-0652	CLAMP			1	
92180	92180-1354	SHIM,9X18X0.3			AR	
132	132BA0840	BOLT-FLANGED-SMALL,8X40			1	
550	550AA2518	PIN-COTTER,2.5X18			1	

This catalog covers:

'10 KX65AAF Chassis

GRID NO.

**D-5**

This grid covers:

**Swingarm**

F2141

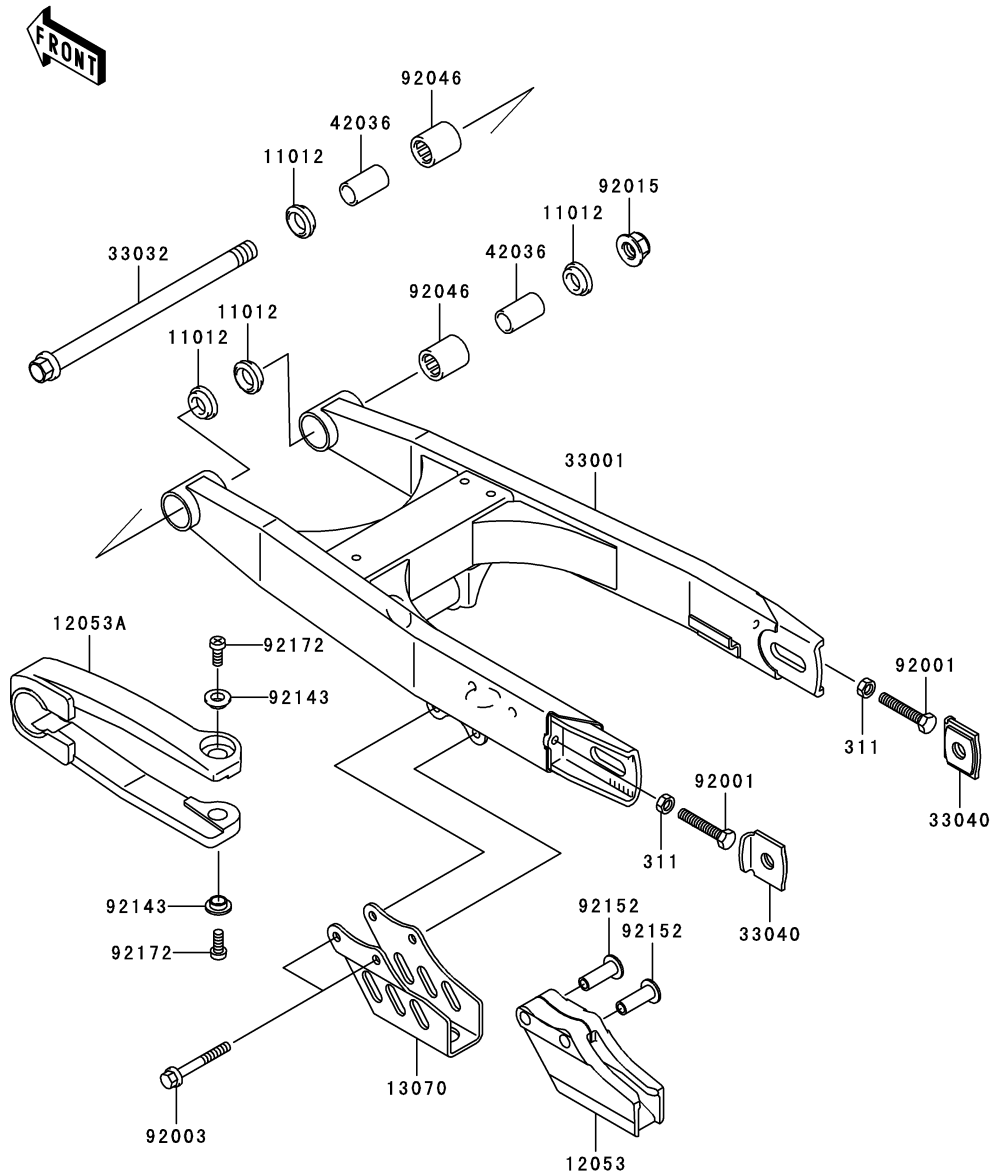

Ref. No.	Part No.	Description	Spec Code	Quantity-KX65			
				'10			
				AAF			
11012	11012-1263	CAP		4			
12053	12053-1436	GUIDE-CHAIN,RR		1			
12053A	12053-1456	GUIDE-CHAIN,FR		1			
13070	13070-1347	GUIDE,CHAIN		1			
33001	33001-1634-458	ARM-COMP-SWING,P,SILVER		1			
33032	33032-1194	SHAFT-SWING ARM		1			
33040	33040-1188	ADJUSTER-CHAIN		2			
42036	42036-1067	SLEEVE,SWING ARM,L=34		2			
92001	92001-1463	BOLT,6X39		2			
92003	92003-179	BOLT,FLANGED,6X48		2			
92015	92015-1433	NUT,LOCK,FLANGED,12MM		1			
92046	92046-1046	BEARING-NEEDLE		2			
92143	92143-1676	COLLAR		2			
92152	92152-1215	COLLAR		2			
92172	92172-0119	SCREW,5X8		2			
311	311AA0600	NUT-HEX,6MM		2			



This catalog covers:  
**'10 KX65AAF Chassis**

GRID NO. This grid covers:

**D-7** **Footrests**

F2160

Ref. No.	Part No.	Description	Spec Code	Quantity-KX65			
				'10			
				AAF			
34028	34028-1529-CE	STEP,LH,SILVER					1
34028A	34028-1530-CE	STEP,RH,SILVER					1
92022	92022-1829	WASHER,10.2X16X1					2
92043	92043-1643	PIN,10X37.5					2
92145	92145-1106	SPRING,STEP,LH					1
92145A	92145-1107	SPRING,STEP,RH					1
550	550S3020	PIN-COTTER,3.0X20					2

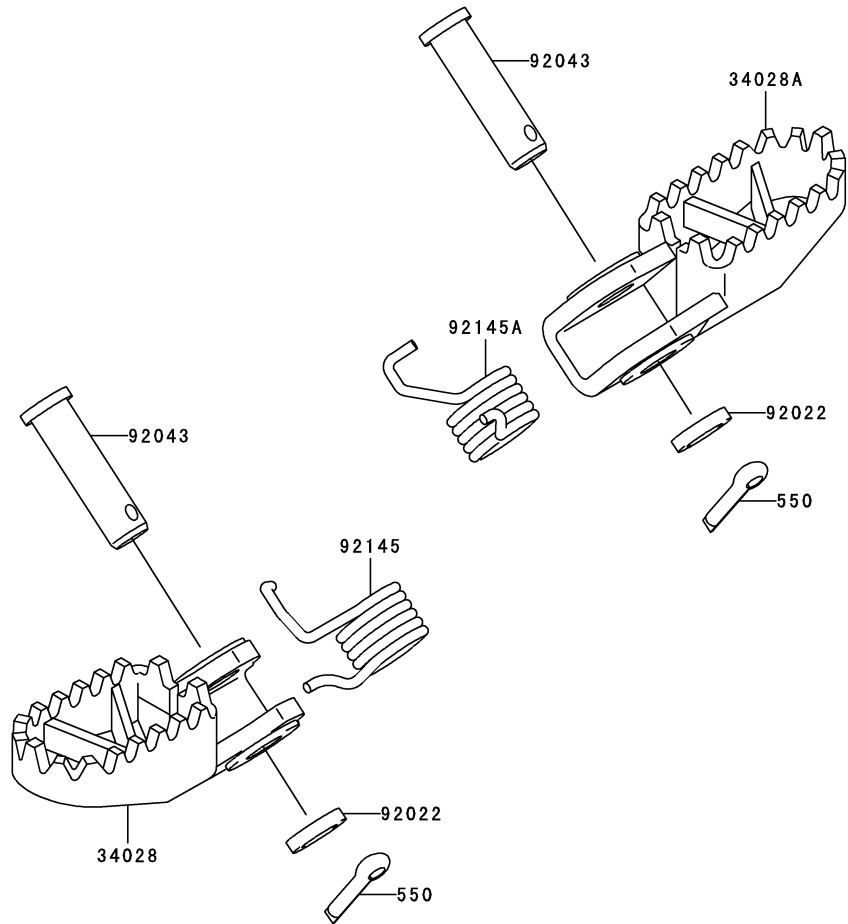

This catalog covers:

'10 KX65AAF Chassis

GRID NO.

**D-8**

This grid covers:

**Fenders**

F2170

Ref. No.	Part No.	Description	Spec Code	Quantity-KX65			
				'10			
35004	35004-1416-290	FENDER-FRONT,L.GREEN		1			
35019	35019-1395-6D	FLAP,REAR FENDER,BLACK		1			
35022	35022-1342-290	FENDER-COMP-REAR,L.GREEN		1			
92015	92015-1078	NUT,FLANGED,6MM		2			
92022	92022-125	WASHER,6.5X20X1.6		2			
92143	92143-1196	COLLAR		2			
92151	92151-1930	BOLT,FLANGED-SMALL,6X25		1			
92152	92152-1255	COLLAR		4			
92153	92153-0502	BOLT,6X20		2			
92153A	92153-0863	BOLT,6X16		3			
92153B	92153-0864	BOLT,6X20		4			

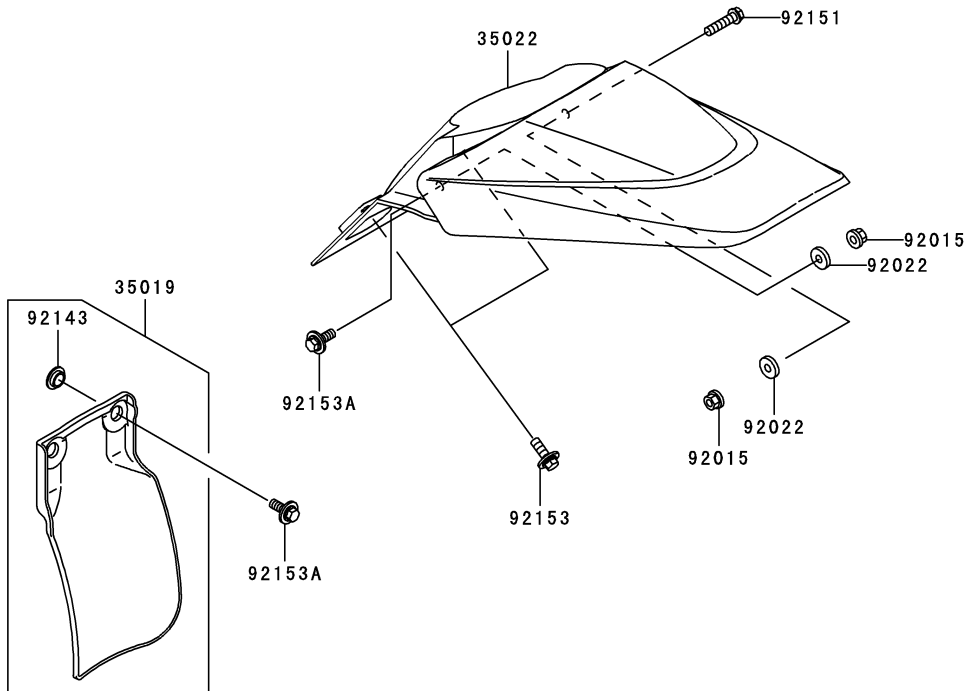
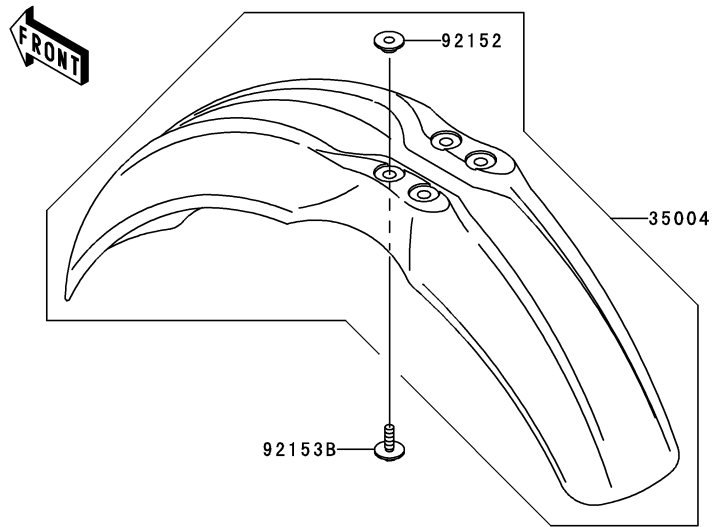

This catalog covers:

'10 KX65AAF Chassis

GRID NO.

**D-9**

This grid covers:

**Stand(s)**



F2190

Ref. No.	Part No.	Description	Spec Code	Quantity-KX65			
				'10			
34024	34024-1403-458	STAND-SIDE,P.SILVER				1	

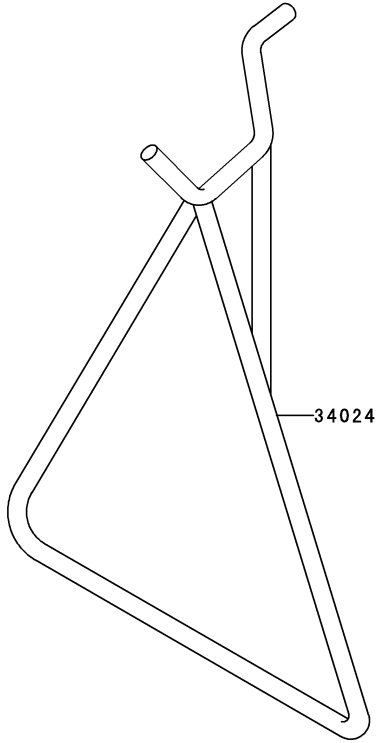

This catalog covers:  
**'10 KX65AF Chassis**

GRID NO. This grid covers:

**D-10** Tires

F2210

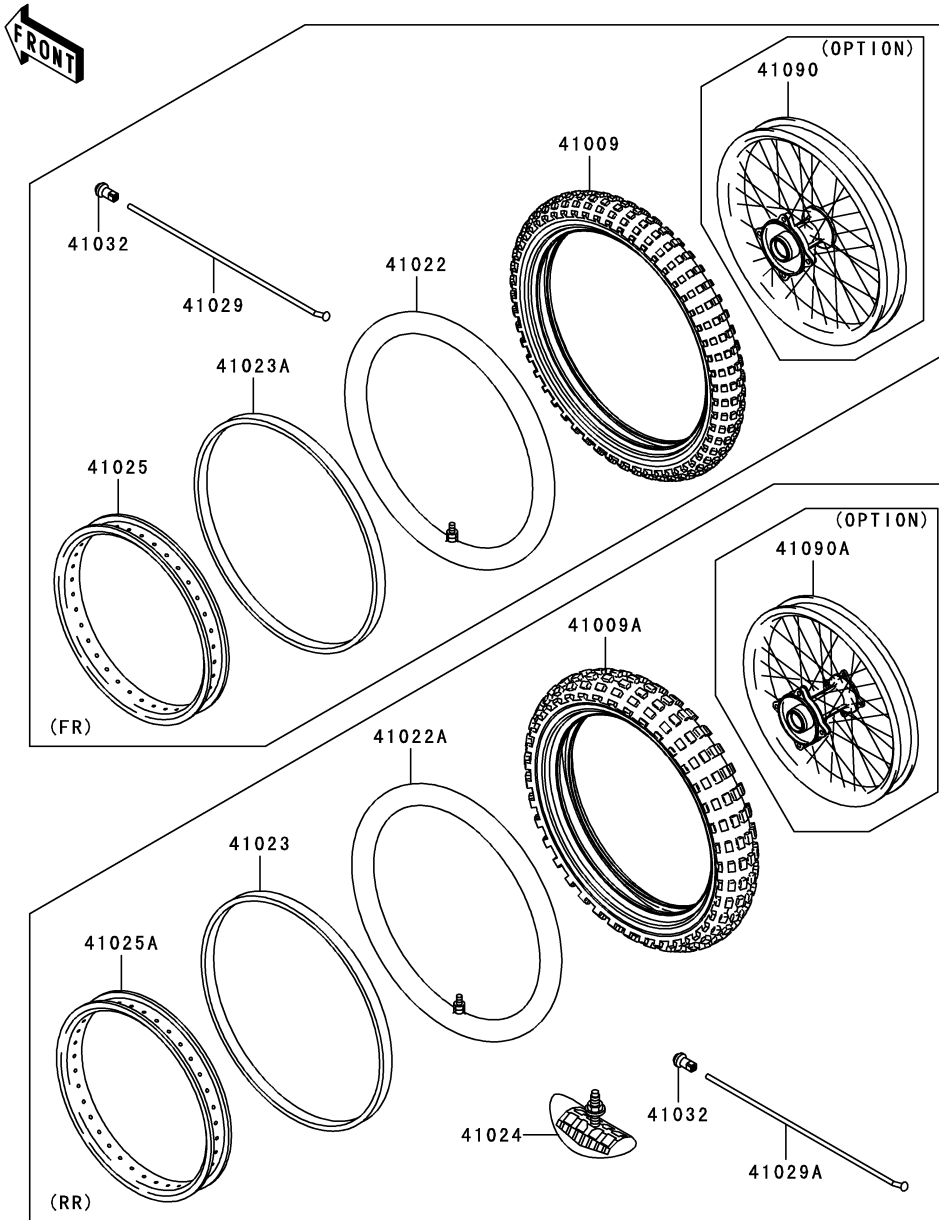

Ref. No.	Part No.	Description	Spec Code	Quantity-KX65			
				'10			
				AAF			
41009	41009-0105	TIRE,FR,60/100-14 30M,D756F(D)					1
41009A	41009-0106	TIRE,RR,80/100-12 41M,D756F(D)					1
41022	41022-1114	TUBE-TIRE,60/100-14(D)					1
41022A	41022-1115	TUBE-TIRE,80/100-12(D)					1
41023	41023-1066	BAND-RIM,80/100-12(D)					1
41023A	41023-1068	BAND-RIM,80/100-14(D)					1
41024	41024-010	STOPPER-RIM,1.60-M(DUNLOP)					1
41025	41025-0129-WC	RIM,FR,1.40X14,BLACK					1
41025A	41025-0130-WC	RIM,RR,1.60X12,BLACK					1
41029	41029-1302	SPOKE-INNER,FR,150MMX159D					28
41029A	41029-1303	SPOKE-INNER,RR,125.5MMX167D					28
41032	41032-1055	NIPPLE-SPOKE					56
41090	41090-0099-WC (OPTION)	WHEEL,FR,1.40X14,BLACK					1
41090A	41090-0100-WC (OPTION)	WHEEL,RR,1.60X12,BLACK					1



This catalog covers:

'10 KX65AAF Chassis

GRID NO.

**D-11**

This grid covers:

**Front Hub**

F2230

Ref. No.	Part No.	Description	Spec Code	Quantity-KX65			
				'10			
AA							

11065	11065-1137	CAP		2
41034	41034-1302	DRUM-ASSY,FRONT BRAKE		1
41068	41068-1418	AXLE,FR		1
92045	92045-1062	BEARING-BALL,TMB201LLUC3/2A		1
92049	92049-1257	SEAL-OIL,TC20376.5		2
92152	92152-1196	COLLAR,AXLE,L=15.5		2
92152A	92152-1197	COLLAR,FR BRAKE DRUM,L=59		1
92200	92200-1004	WASHER,12.3X23X2.3		1
320	320BA1200	NUT-CASTLE		1
550	550AA3025	PIN-COTTER,3.0X25		1
601	601B6301UU	BEARING-BALL,#6201UUC3		1

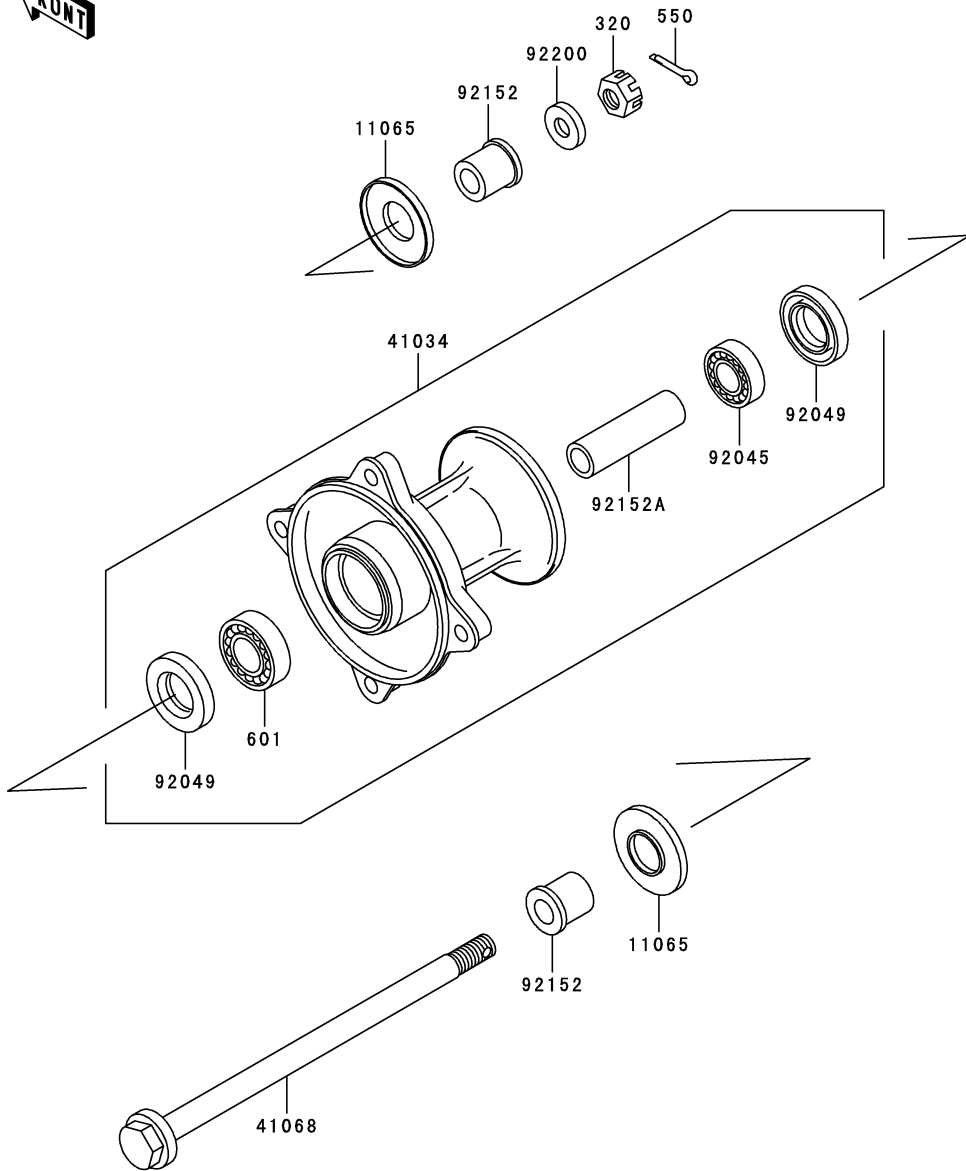

This catalog covers:

'10 KX65AAF Chassis

GRID NO.

**D-12**

This grid covers:

**Rear Hub**

F2240

Ref. No.	Part No.	Description	Spec Code	Quantity-KX65	
				'10	AAF

11065	11065-1137	CAP		2
41034	41034-1303	DRUM-ASSY,REAR BRAKE		1
41068	41068-1419	AXLE,RR		1
42041	42041-1526	SPROCKET-HUB,45T		1
	(OPTION)			
42041A	42041-1527	SPROCKET-HUB,46T		1
	(OPTION)			
42041B	42041-1528	SPROCKET-HUB,47T		1
42041C	42041-1529	SPROCKET-HUB,48T		1
	(OPTION)			
42041D	42041-1549	SPROCKET-HUB,49T		1
	(OPTION)			
43044	43044-1127	HOLDER-COMP-CALIPER,RR		1
92015	92015-1432	NUT,8MM		4
92045	92045-1062	BEARING-BALL,TMB201LLUC3/2A		1
92049	92049-1257	SEAL-OIL,TC20376.5		2
92057	92057-1504	CHAIN,DRIVE,DID420MBK1X110L		1
92058	92058-1073	JOINT-CHAIN,DRIVE		1
92152	92152-1196	COLLAR,AXLE,L=15.5		1
92152A	92152-1198	COLLAR,RR AXLE,L=22		1
92152B	92152-1199	COLLAR,RR BRAKE DRUM,L=89		1
92153	92153-1101	BOLT,FLANGED,8X28		4
92200	92200-1004	WASHER,12.3X23X2.3		1
320	320BA1200	NUT-CASTLE		1
410	410AA0800	WASHER-PLAIN-SMALL,8MM		4
481	481J3700	CIRCLIP-TYPE-C,37MM		1
550	550AA3025	PIN-COTTER,3.0X25		1
601	601B6301UU	BEARING-BALL,#6201UUC3		1

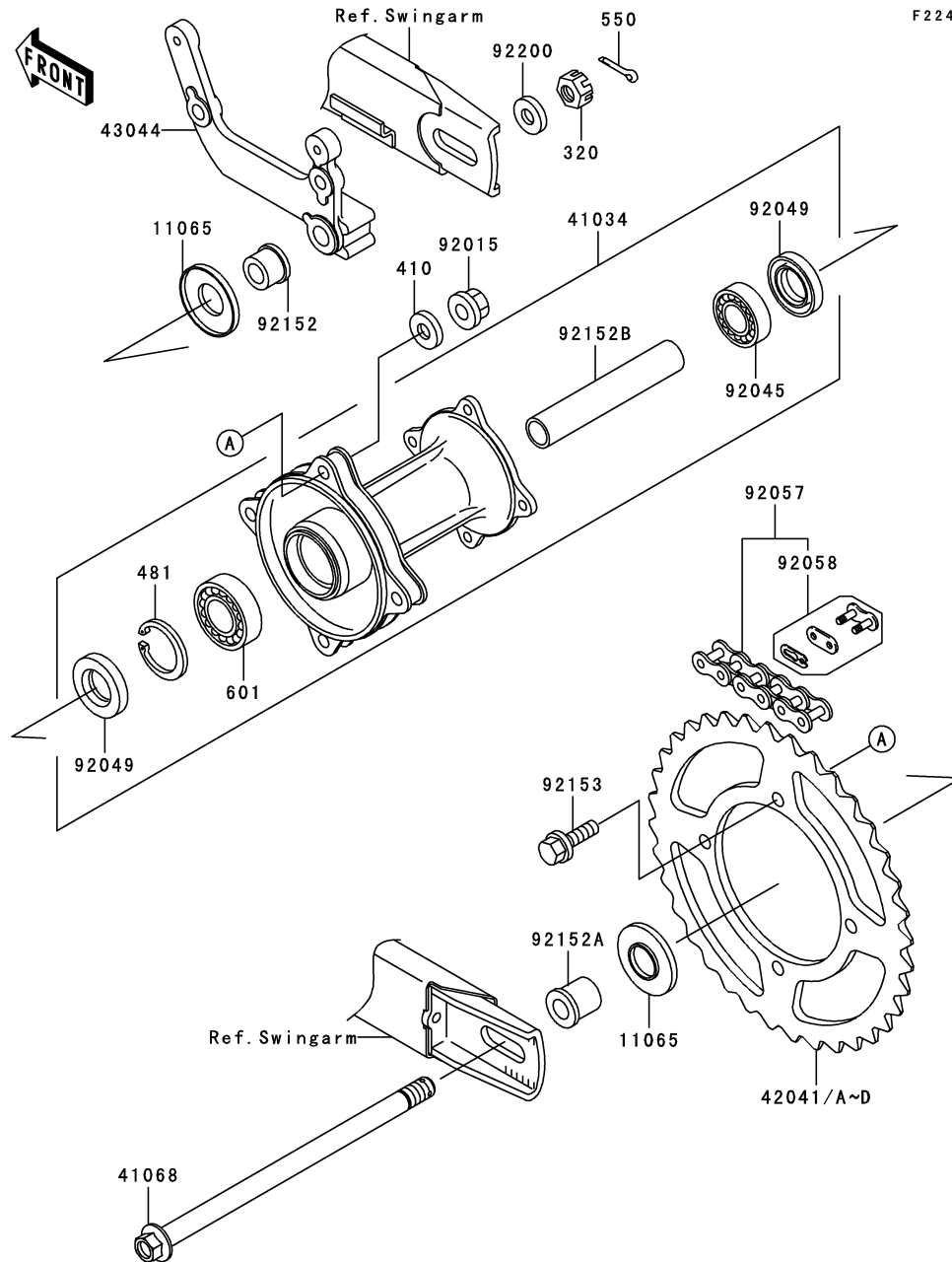

This catalog covers:

'10 KX65AAF Chassis

GRID NO.

**D-13**

This grid covers:

**Brake Pedal**

F2260

Ref. No.	Part No.	Description	Spec Code	Quantity-KX65			
				'10			

13236	13236-1369	LEVER-COMP,BRAKE PEDAL,STEEL		1
92144	92144-1752	SPRING,BRAKE PEDAL RETURN		1
92151	92151-1572	BOLT,BRAKE PEDAL,8MM		1
92190	92190-1488	TUBE,13X16X25		1
670	670B2012	O RING,12MM		2

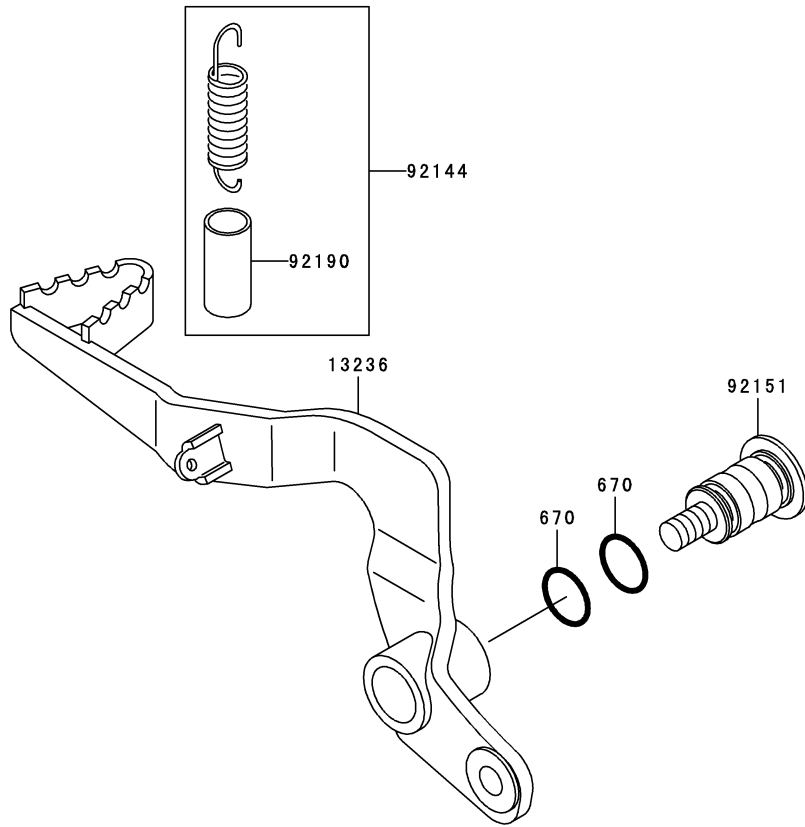

This catalog covers:

'10 KX65AAF Chassis

GRID NO.

**D-14**

This grid covers:

**Shock Absorber(s)**

F2280

Ref. No.	Part No.	Description	Spec Code	Quantity-KX65			
				'10			
				AAF			
45014	45014-0120-10	SHOCKABSORBER,BLACK					1
92092	92092-1078	BUSHING-RUBBER					1
92145	92145-1474-10 (OPTION)	SPRING,SHOCK,K=44.1N/MM,BLK					1
92145A	92145-1475-10 (OPTION)	SPRING,SHOCK,K=46.1N/MM,BLK					1
92145B	92145-1476-10	SPRING,SHOCK,K=48.1N/MM,BLK					1
92145C	92145-1477-10 (OPTION)	SPRING,SHOCK,K=50.0N/MM,BLK					1

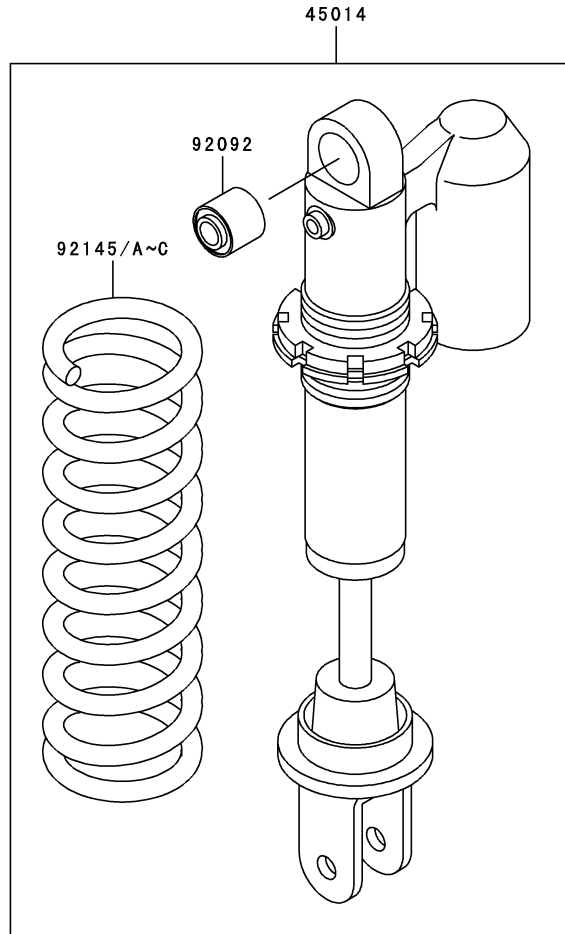

This catalog covers:

'10 KX65AAF Chassis

GRID NO.

**E-3**

This grid covers:

Front Master Cylinder

F2291

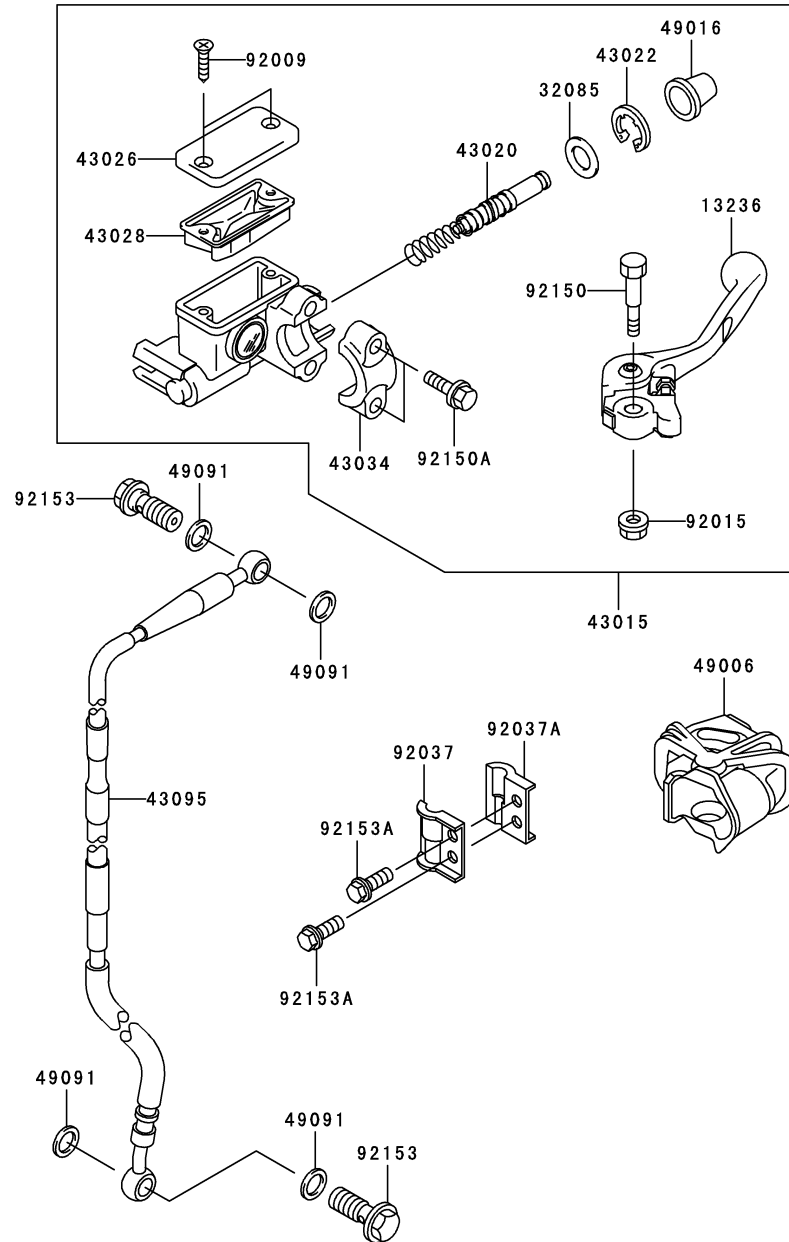

Ref. No.	Part No.	Description	Spec Code	Quantity-KX65	
				'10	AAF
13236	13236-1346	LEVER-COMP,FRONT BRAKE		1	
32085	32085-1508	STOPPER		1	
43015	43015-0152	CYLINDER-ASSY-MASTER,FR		1	
43020	43020-1121	PISTON-COMP-BRAKE		1	
43022	43022-1010	STOPPER-BRAKE,PISTON		1	
43026	43026-0020	CAP-BRAKE,MASTER CYLINDER		1	
43028	43028-1067	DIAPHRAGM		1	
43034	43034-1110	HOLDER-BRAKE		1	
43095	43095-1256	HOSE-BRAKE,FR		1	
49006	49006-0078	BOOT,FRONT BRAKE LEVER		1	
49016	49016-1044	COVER-SEAL,MASTER CYLINDER		1	
49091	49091-0001	WASHER-SEAL,10.1X14.5X1.5		4	
92009	92009-1458	SCREW,4MM		2	
92015	92015-1528	NUT,FLANGED,6MM		1	
92037	92037-1362	CLAMP,BRAKE HOSE,OUTSIDE		1	
92037A	92037-1363	CLAMP,BRAKE HOSE,INSIDE		1	
92150	92150-1451	BOLT,LEVER SET		1	
92150A	92150-1452	BOLT		2	
92153	92153-0627	BOLT,OIL,L=23		2	
92153A	92153-0695	BOLT,6X16		2	

This catalog covers:

'10 KX65AAF Chassis

GRID NO.

**E-4**

This grid covers:

**Front Brake**



F2292

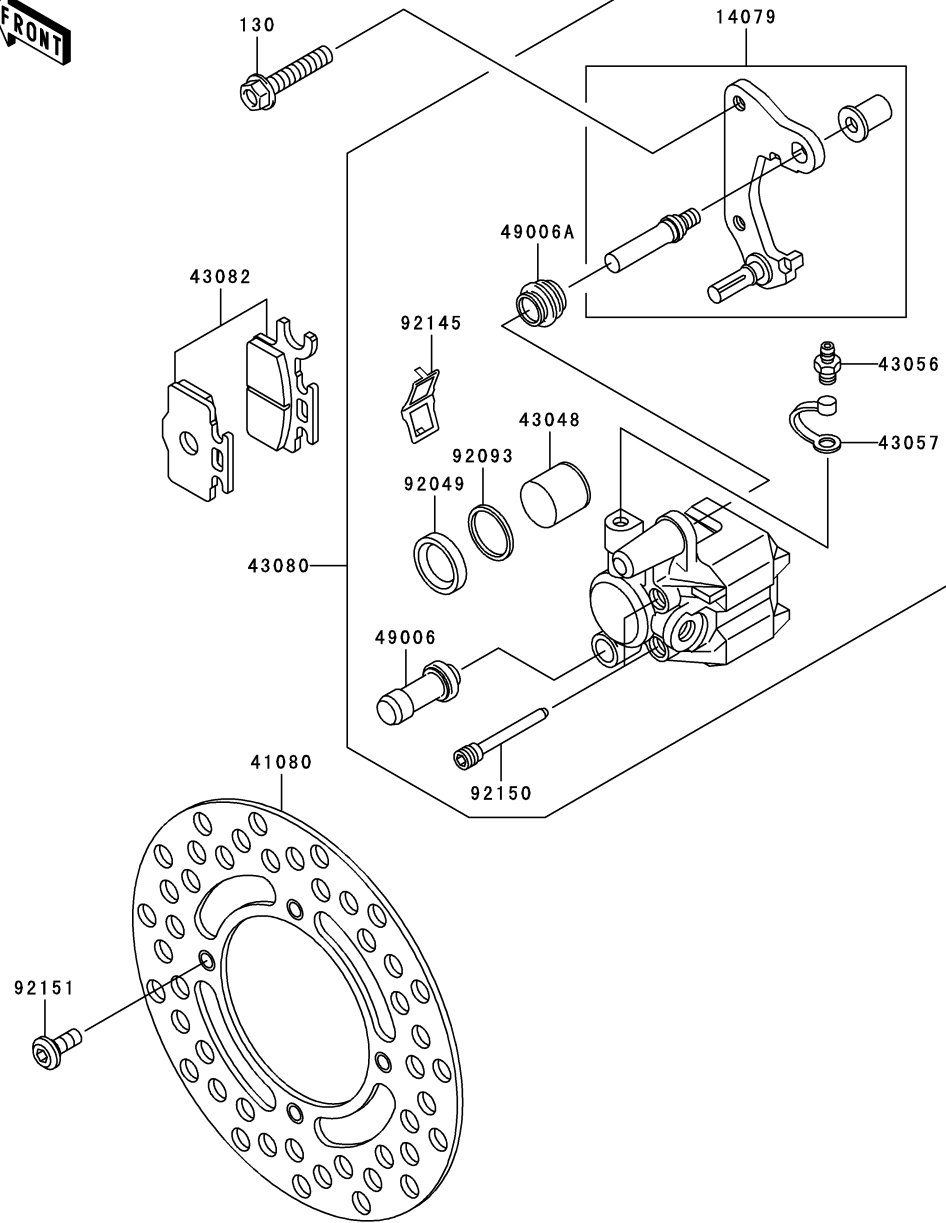

Ref. No.	Part No.	Description	Spec Code	Quantity-KX65			
				'10			
				AAF			
14079	14079-1130	HOLDER-ASSY,FRONT CALIPER					1
41080	41080-1470	DISC					1
43048	43048-1089	PISTON-CALIPER					1
43056	43056-1055	BREATHER					1
43057	43057-1001	CAP-BREATHER					1
43080	43080-0035	CALIPER-SUB-ASSY,FR					1
43082	43082-0042	PAD-ASSY-BRAKE					1
49006	49006-1088	BOOT,CALIPER					1
49006A	49006-1242	BOOT,CALIPER					1
92049	92049-1331	SEAL-OIL,PISTON					1
92093	92093-1272	SEAL,PISTON					1
92145	92145-1269	SPRING,PAD					1
92150	92150-1144	BOLT					2
92151	92151-1799	BOLT,DISC PLATE,6MM					4
130	130CA0840	BOLT-FLANGED,8X40					2

This catalog covers:

'10 KX65AAF Chassis

GRID NO.

**E-5**

This grid covers:

**Rear Master Cylinder**

F2293

Ref. No.	Part No.	Description	Spec Code	Quantity-KX65	
				'10	AAF
13159	13159-1056	CONNECTOR		1	
43010	43010-1076	ROD-ASSY-BRAKE		1	
43015	43015-1694	CYLINDER-ASSY-MASTER,RR		1	
43020	43020-1094	PISTON-COMP-BRAKE		1	
43026	43026-1058	CAP-BRAKE		1	
43027	43027-1052	PLATE-DIAPHRAGM		1	
43028	43028-1060	DIAPHRAGM		1	
43078	43078-1068	RESERVOIR		1	
43095	43095-1228	HOSE-BRAKE,RR		1	
43095A	43095-1254	HOSE-BRAKE,RR MASTER CYLINDER		1	
49091	49091-0001	WASHER-SEAL,10.1X14.5X1.5		4	
92022	92022-1028	WASHER,8.5X13X1		1	
92022A	92022-1601	WASHER,CIRCRIP		1	
92033	92033-1186	RING-SNAP,20.5MM		1	
92037	92037-1710	CLAMP		2	
92043	92043-0004	PIN		1	
92055	92055-1251	RING-O,MASTER CYLINDER		1	
92151	92151-1423	BOLT,6X14		2	
92153	92153-0627	BOLT,OIL,L=23		2	
92153A	92153-0936	BOLT,FLANGED,6X14		1	
92170	92170-1684	CLAMP,HOSE		1	
221	221AA0510	SCREW-CSK-CROS,5X10		2	
550	550AA2015	PIN-COTTER,2.0X15		1	

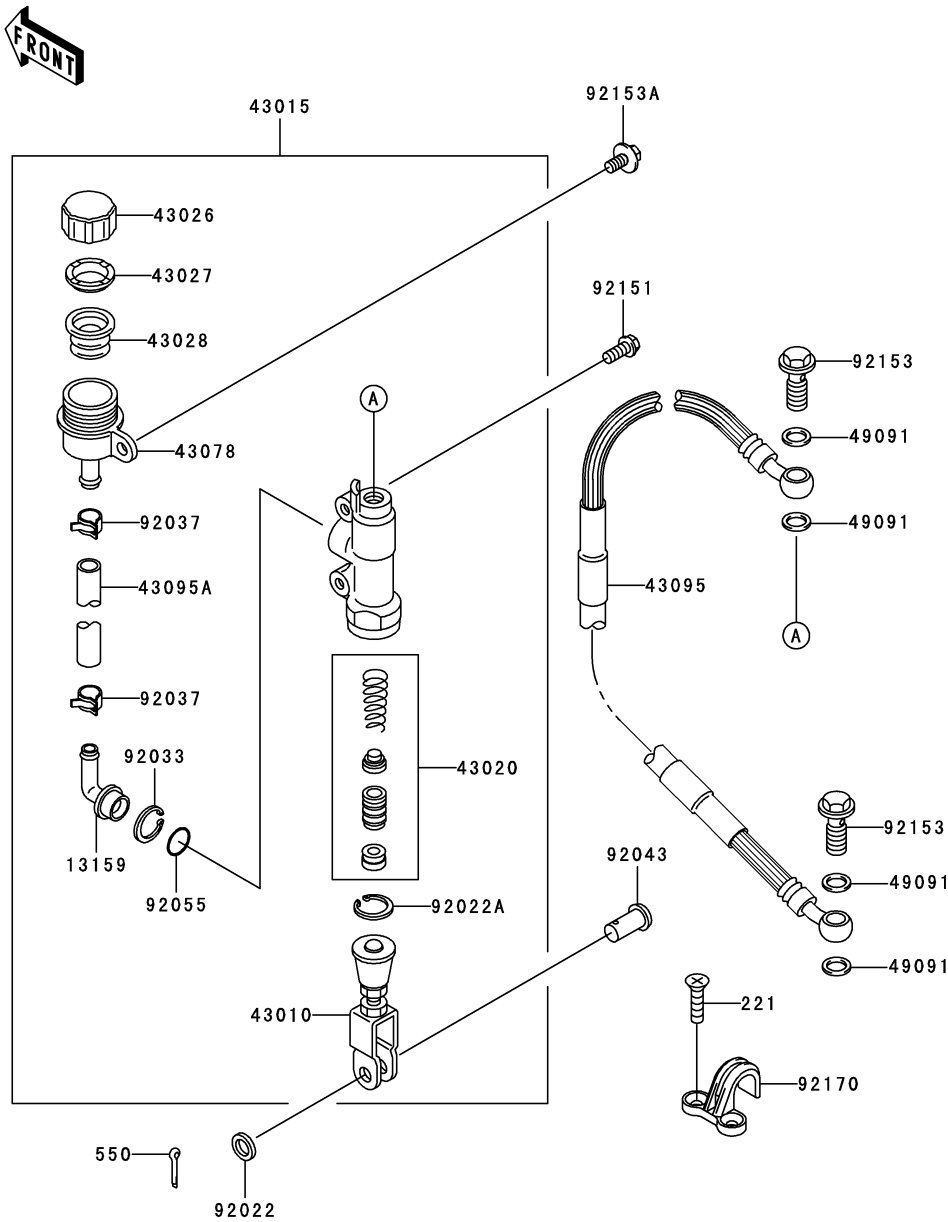

This catalog covers:

'10 KX65AAF Chassis

GRID NO.

**E-6**

This grid covers:

Rear Brake

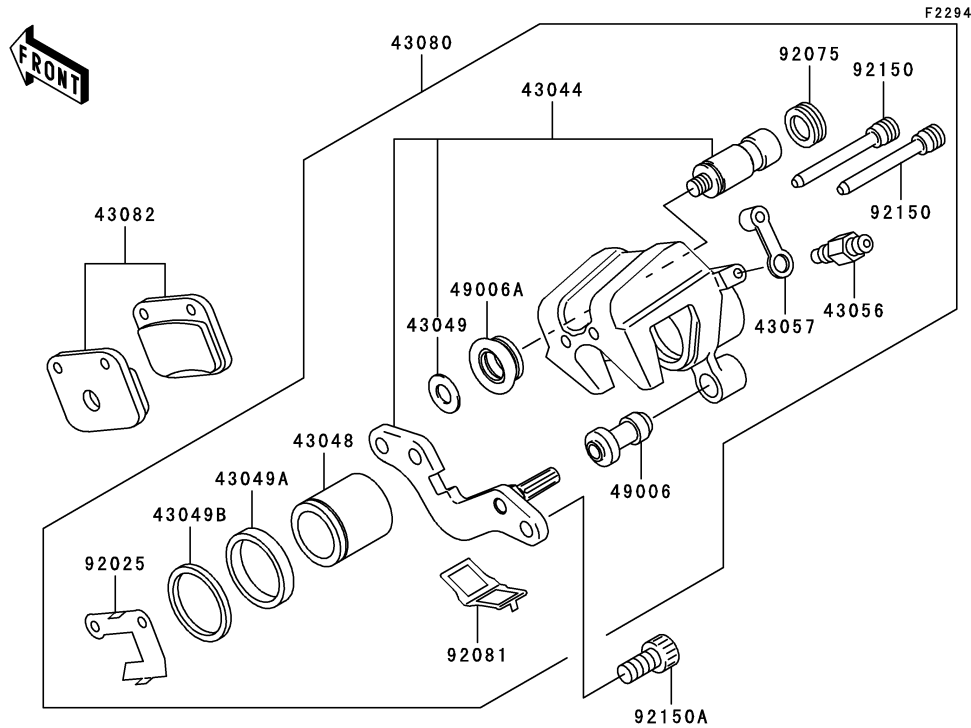

Ref. No.	Part No.	Description	Spec Code	Quantity-KX65	
				'10	AAF
41080	41080-1470	DISC		1	
43044	43044-1076	HOLDER-COMP-CALIPER,RR		1	
43048	43048-1090	PISTON-CALIPER		1	
43049	43049-1025	PACKING		1	
43049A	43049-1060	PACKING,PISTON SEAL		1	
43049B	43049-1061	PACKING,PISTON SEAL		1	
43056	43056-1055	BREATHER		1	
43057	43057-1001	CAP-BREATHER		1	
43080	43080-0036	CALIPER-SUB-ASSY,RR		1	
43082	43082-0043	PAD-ASSY-BRAKE		1	
49006	49006-1088	BOOT,CALIPER		1	
49006A	49006-1089	BOOT,CALIPER		1	
55020	55020-1707-6D	GUARD,REAR CALIPER,BLACK		1	
92025	92025-1817	SHIM,PAD		1	
92075	92075-1414	DAMPER		1	
92081	92081-1502	SPRING,PAD		1	
92150	92150-1144	BOLT		2	
92150A	92150-1840	BOLT,SOCKET,8X16		2	
92151	92151-1799	BOLT,DISC PLATE,6MM		4	
92153	92153-0936	BOLT,FLANGED,6X14		2	

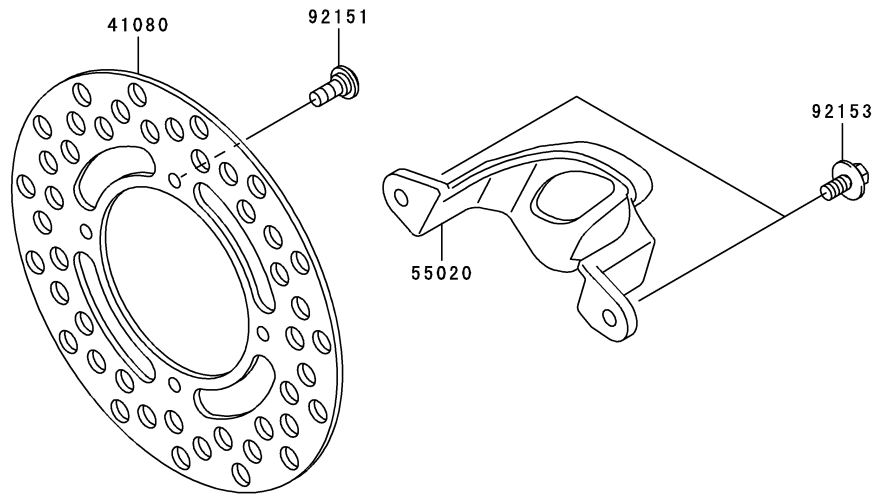



This catalog covers:

'10 KX65AAF Chassis

GRID NO.

**E-7**

This grid covers:

**Handlebar**

F2310

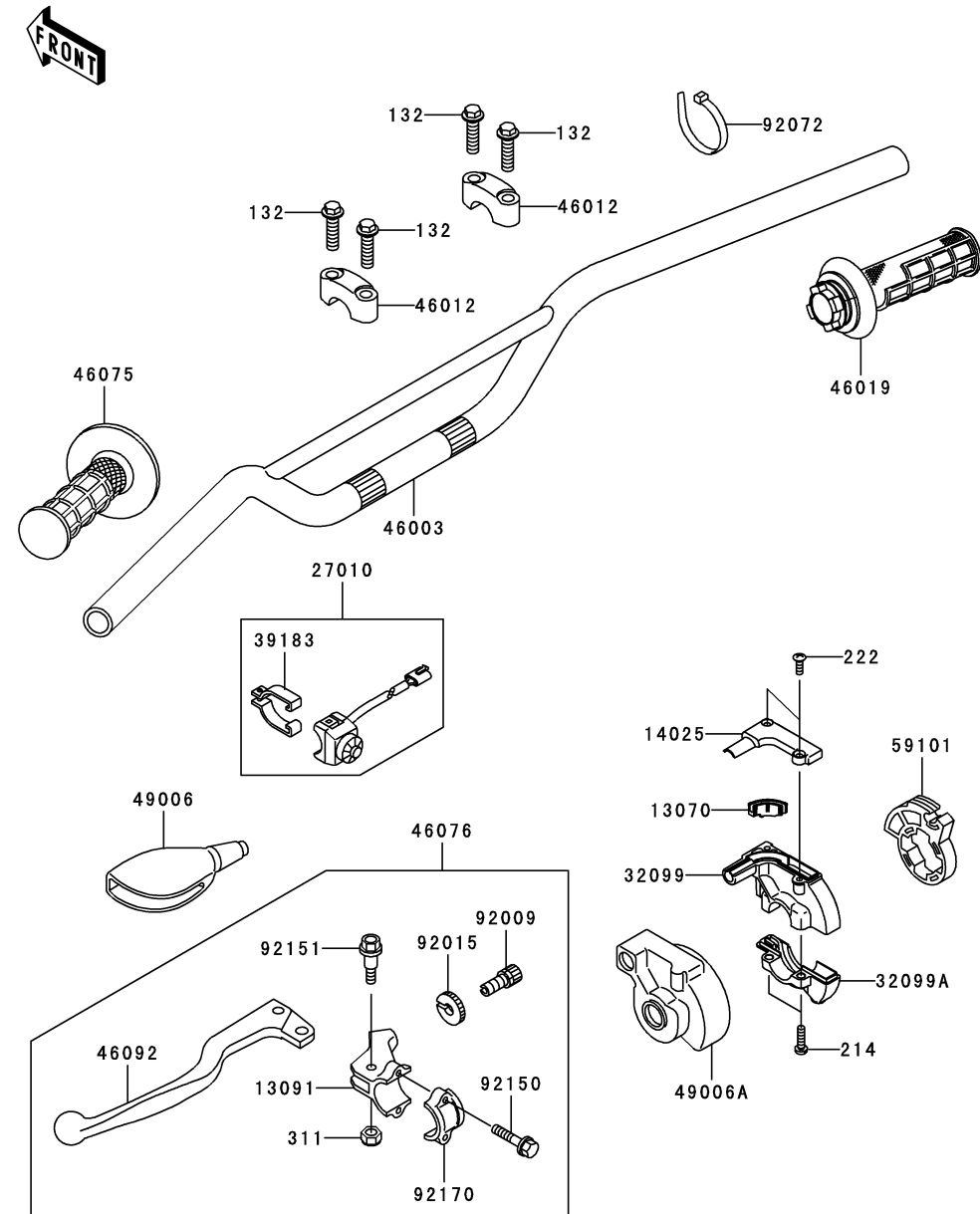

Ref. No.	Part No.	Description	Spec Code	Quantity-KX65		
				'10	AAF	
13070	13070-1074	GUIDE,THROTTLE			1	
13091	13091-1728	HOLDER,CLUTCH LEVER			1	
14025	14025-1646	COVER,THROTTLE CASE UPP			1	
27010	27010-0035	SWITCH,ENGINE STOP			1	
32099	32099-1036	CASE,THROTTLE UPP			1	
32099A	32099-1044	CASE,THROTTLE LWR			1	
39183	39183-1059	BAND-ASSY,ENGINE STOP SWITCH			1	
46003	46003-0030-458	HANDLE,P,SILVER			1	
46012	46012-0011-21	HOLDER-HANDLE,UPP,F.BLACK			2	
46019	46019-1054	GRIP-ASSY,THROTTLE			1	
46075	46075-1024	GRIP,LH			1	
46076	46076-1202	LEVER-ASSY-GRIP,CLUTCH			1	
46092	46092-1165	LEVER-GRIP,CLUTCH			1	
49006	49006-1017	BOOT,LEVER HOLDER			1	
49006A	49006-1097	BOOT,THROTTLE CASE			1	
59101	59101-1110	REEL,THROTTLE			1	
92009	92009-1435	SCREW,CABLE ADJUST,8MM			1	
92015	92015-1596	NUT,CABLE ADJUST LOCK,8MM			1	
92072	92072-0055	BAND,L=100			1	
92150	92150-1474	BOLT			2	
92151	92151-1103	BOLT,LEVER SET,5MM			1	
92170	92170-1226	CLAMP,LEVER HOLDER			1	
132	132BC0830	BOLT-FLANGED-SMALL,8X30			4	
214	214C0518	SCREW-PAN+-,5X18			2	
222	222E0412	SCREW-CSK-RD-CROS,4X12			2	
311	311AA0500	NUT-HEX			1	

F2340

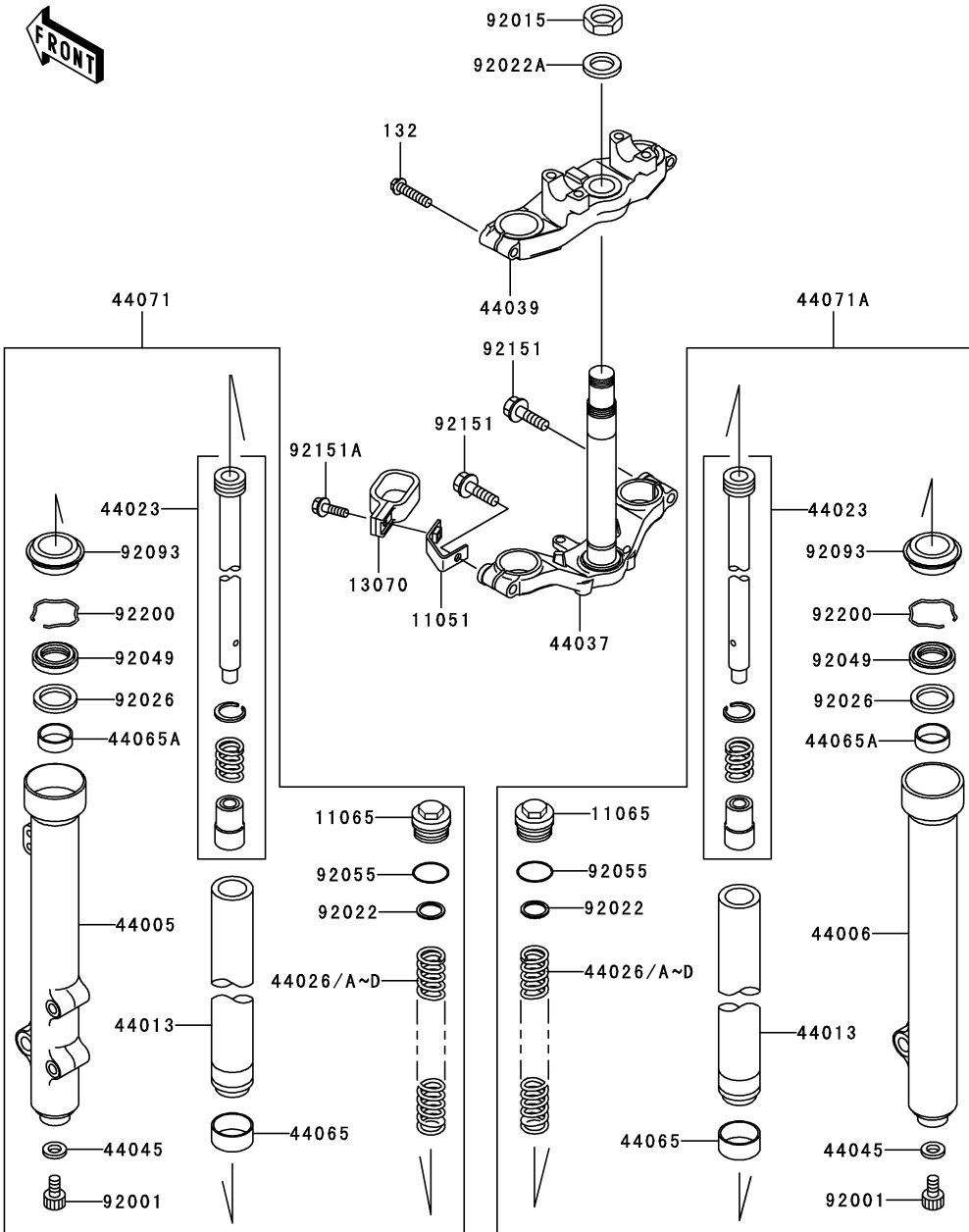

Ref. No.	Part No.	Description	Spec Code	Quantity-KX65			
				'10	AAF		
11051	11051-1892	BRACKET,BRAKE HOSE GUIDE		1			
11065	11065-1225	CAP,FORK TOP		2			
13070	13070-1349	GUIDE,BRAKE HOSE		1			
44005	44005-0042-458	PIPE-LEFT FORK OUTER,P.SILVER		1			
44006	44006-0042-458	PIPE-RIGHT FORK OUTER,P.SILVER		1			
44013	44013-1496	PIPE-FORK INNER		2			
44023	44023-1161	CYLINDER-SET-FORK		2			
44026	44026-1735	SPRING-FRONT FORK,K=2.55N/MM		2			
	(OPTION)						
44026A	44026-1736	SPRING-FRONT FORK,K=2.65N/MM		2			
44026B	44026-1737	SPRING-FRONT FORK,K=2.75N/MM		2			
	(OPTION)						
44026C	44026-1738	SPRING-FRONT FORK,K=2.84N/MM		2			
	(OPTION)						
44026D	44026-1739	SPRING-FRONT FORK,K=2.45N/MM		2			
	(OPTION)						
44037	44037-0023-21	HOLDER-FORK UNDER,F.BLACK		1			
44039	44039-0022-21	HOLDER-FORK UPPER,F.BLACK		1			
44045	44045-051	GASKET,FORK CYLINDER BOLT		2			
44065	44065-1123	BUSHING-FRONT FORK,INNER PIPE		2			
44065A	44065-1133	BUSHING-FRONT FORK		2			
44071	44071-0295-458	DAMPER-ASSY,FORK,LH,P.SILVER		1			
44071A	44071-0296-458	DAMPER-ASSY,FORK,RH,P.SILVER		1			
92001	92001-1464	BOLT,FORK CYLINDER		2			
92015	92015-1653	NUT,STEERING STEM,22MM		1			
92022	92022-1841	WASHER,FORK SPRING		2			
92022A	92022-1873	WASHER,STEERING STEM		1			
92026	92026-1365	SPACER		2			
92049	92049-1524	SEAL-OIL,FORK OUTER TUBE		2			
92055	92055-1367	RING-O,FORK TOP		2			
92093	92093-1519	SEAL,FORK OUTER TUBE		2			
92151	92151-1636	BOLT,FLANGED,10X35		2			
92151A	92151-1637	BOLT,FLANGED,5X16		1			
92200	92200-1496	WASHER		2			
132	132BA0835	BOLT-FLANGED-SMALL,8X35		2			

F2410

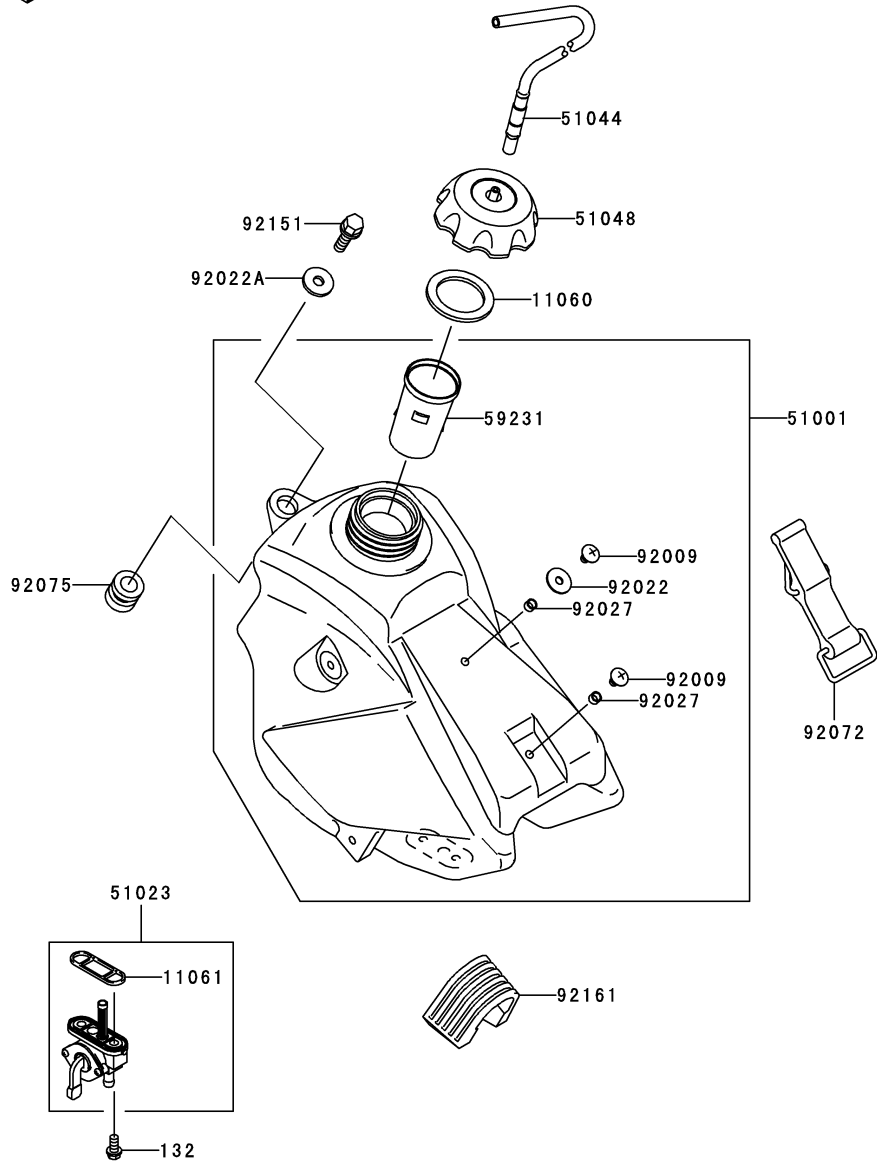

Ref. No.	Part No.	Description	Spec Code	Quantity-KX65		
				'10	AAF	
11060	11060-1340	GASKET,FUEL TANK CAP			1	
11061	11061-0181	GASKET,FUEL TAP			1	
51001	51001-1676-6Z	TANK-COMP-FUEL,F.BLACK			1	
51023	51023-0024	TAP-ASSY,FUEL			1	
51044	51044-0025	TUBE-ASSY			1	
51048	51048-0014	CAP-ASSY-TANK,FUEL			1	
59231	59231-1096	FILLER			1	
92009	92009-1530	SCREW,6X10			2	
92022	92022-165	WASHER,PLAIN,6MM			1	
92022A	92022-1690	WASHER,6.5X24X2			1	
92027	92027-2096	COLLAR,6.2X7.8X5			2	
92072	92072-1229	BAND,FUEL TANK			1	
92075	92075-1787	DAMPER			1	
92151	92151-1423	BOLT,6X14			1	
92161	92161-1077	DAMPER,FUEL TANK,RR			1	
132	132BA0612	BOLT-FLANGED-SMALL,6X12			2	

This catalog covers:

'10 KX65AAF Chassis

GRID NO.

**E-10**

This grid covers:

**Seat**



F2510

Ref. No.	Part No.	Description	Spec Code	Quantity-KX65			
				'10			
53066	53066-0092-13R	SEAT-ASSY,BLACK/GREEN				1	
92153	92153-0502	BOLT,6X20				2	

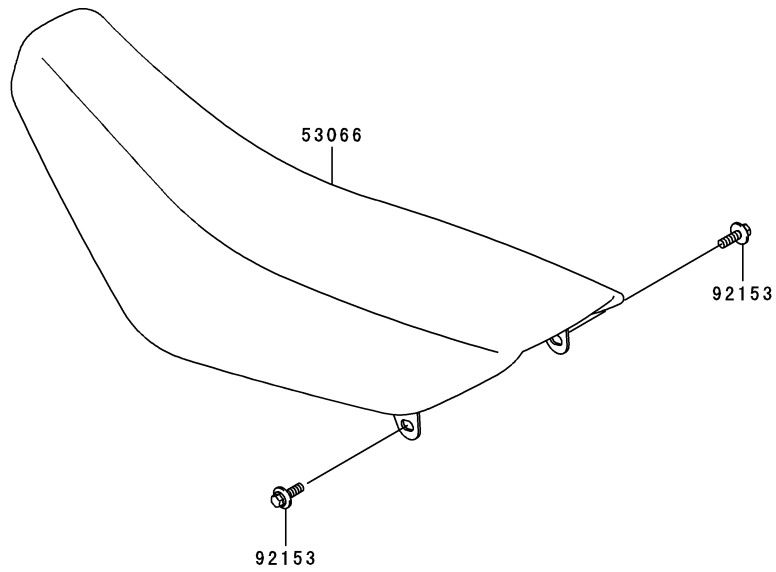

This catalog covers:

'10 KX65AAF Chassis

GRID NO.

**E-11**

This grid covers:

**Cables**

F2540

Ref. No.	Part No.	Description	Spec Code	Quantity-KX65			
				'10			
54011	54011-1415	CABLE-CLUTCH					1
54012	54012-0095	CABLE-THROTTLE					1
92072	92072-1293	BAND,L=140					1

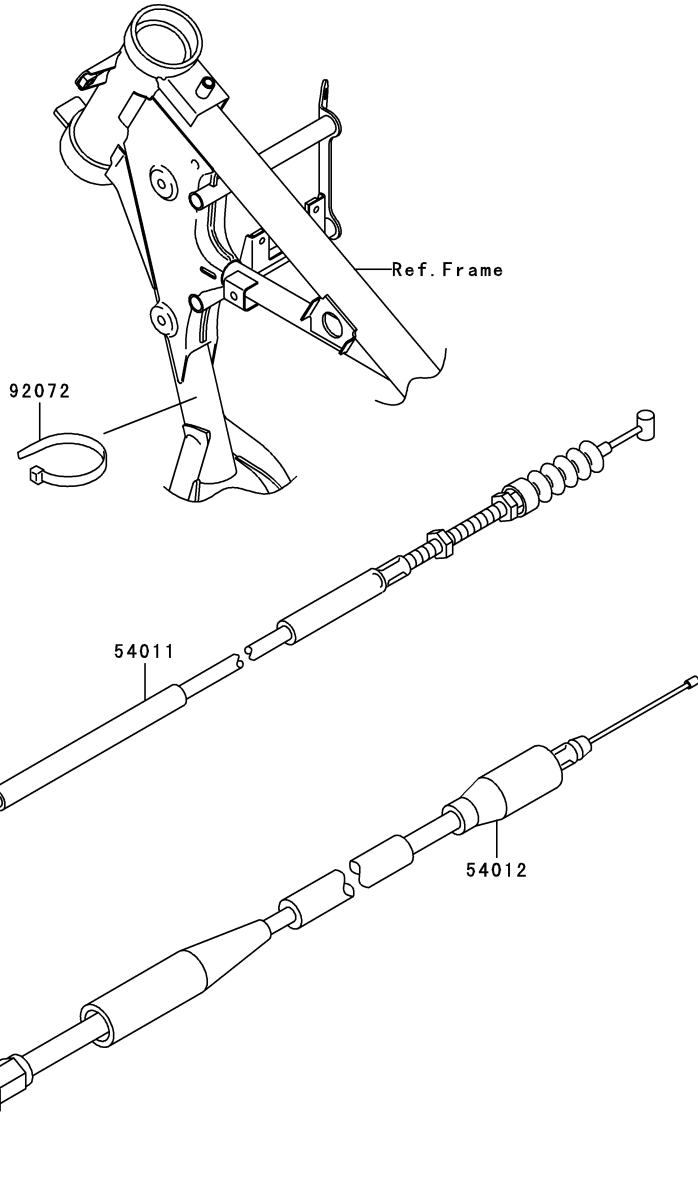

This catalog covers:

'10 KX65AAF Chassis

GRID NO.

**E-12**

This grid covers:

**Side Covers**

F2611

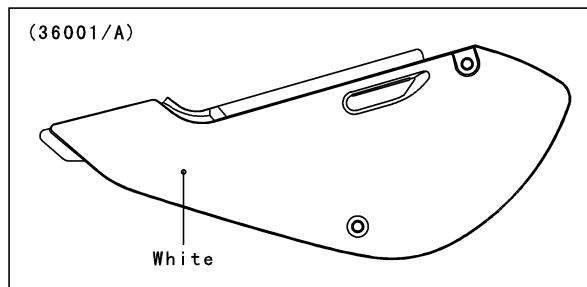
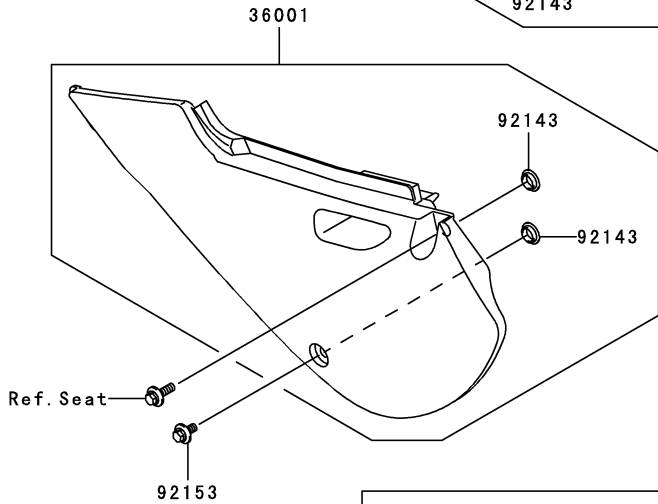
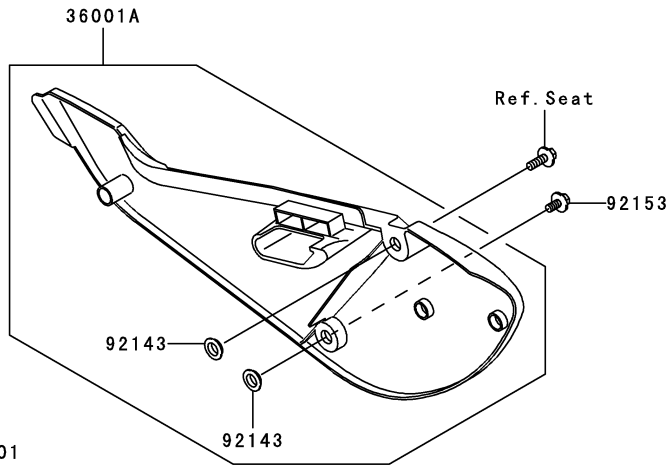

W0D

Ref. No.	Part No.	Description	Spec Code	Quantity-KX65			
				'10			
36001	36001-1639-266	COVER-SIDE,LH,S.WHITE		1			
36001A	36001-1667-266	COVER-SIDE,RH,S.WHITE		1			
92143	92143-1196	COLLAR		4			
92153	92153-0936	BOLT,FLANGED,6X14		2			

This catalog covers:

'10 KX65AAF Chassis

GRID NO.

**E-13**

This grid covers:

**Owner's Tools**

F2810

Ref. No.	Part No.	Description	Spec Code	Quantity-KX65			
				'10			
92104	92104-002	GASKET-LIQUID,TB1105B,SILVER					1
92110	92110-1119	TOOL-WRENCH,BOX,21MM&SPOKE					1

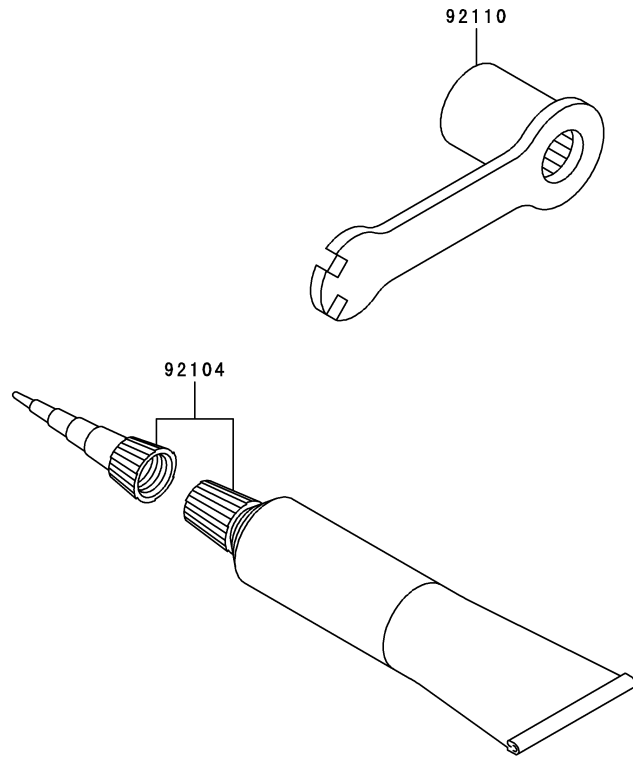

This catalog covers:

'10 KX65AAF Chassis

GRID NO.

**E-14**

This grid covers:

**Labels**

F2860

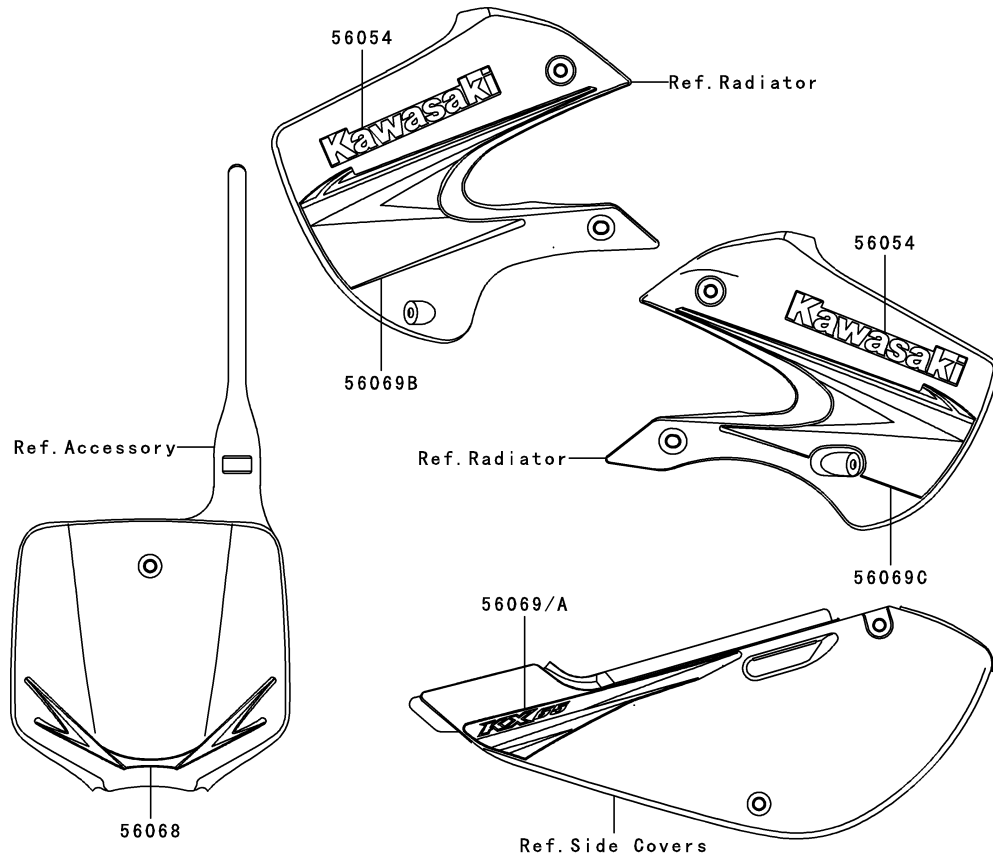
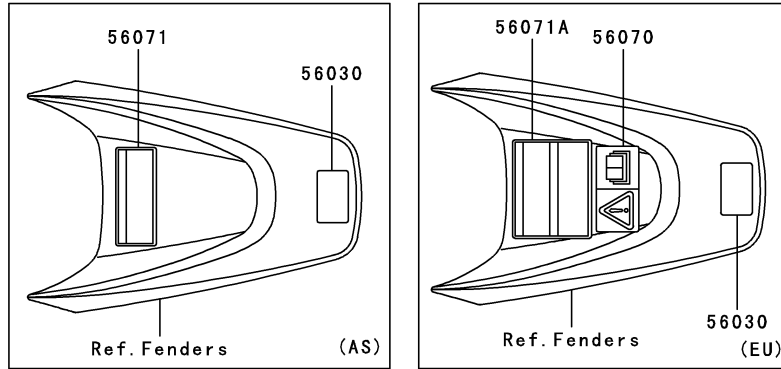

Ref. No.	Part No.	Description	Spec Code	Quantity-KX65			
				'10			
56030	56030-1230	LABEL,32:1					1
56054	56054-0485	MARK,SHROUD,KAWASAKI					2
56068	56068-1265	PATTERN,NUMBER PLATE					1
56069	56069-0019	PATTERN,SIDE COVER,LH					1
56069A	56069-0020	PATTERN,SIDE COVER,RH					1
56069B	56069-0021	PATTERN,SHROUD,LH					1
56069C	56069-0022	PATTERN,SHROUD,RH					1
56070	56070-3799	LABEL-WARNING,OWNER'S MANUAL					1
		L----- EU					1
56071	56071-0028	LABEL-WARNING,IMPORTANT NOTICE					1
		L----- AS					1
56071A	56071-0029	LABEL-WARNING,IMPORTANT NOTICE					1
		L----- EU					1



This catalog covers:  
**'10 KX65AAF Chassis**

GRID NO. **F-3** This grid covers:  
**Accessory**

F2910

Ref. No.	Part No.	Description	Spec Code	Quantity-KX65			
				'10			
58029	58029-1087-266	PLATE-NUMBER,S.WHITE					1
92153	92153-0936	BOLT,FLANGED,6X14					1

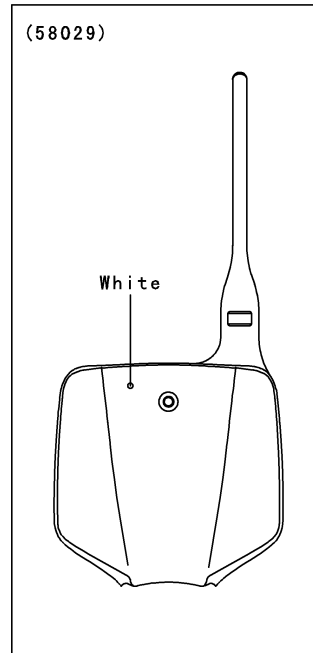
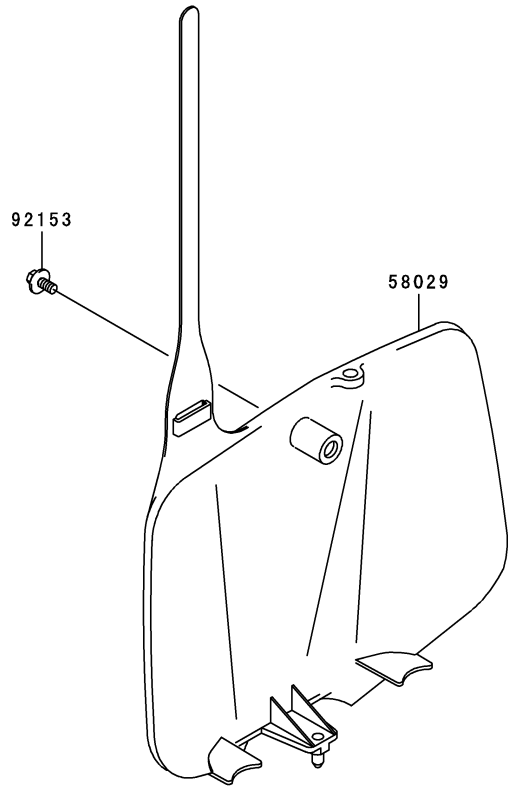

W0D

This catalog covers:  
**'10 KX65AAF Chassis**

GRID NO. **F-4** This grid covers:  
**Manual(EU)**

F2920

Ref. No.	Part No.	Description	Spec Code	Quantity-KX65			
				'10			
				AAF			
99976	99976-1549	OWNER'S MANUAL,EN/FR/DE					
		L-----	EU	1			
99976A	99976-1550	OWNER'S MANUAL,IT/ES/NL					
		L-----	EU	1			

Owner's Manual  
(Local Procurement)

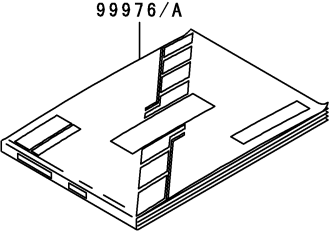

Ref. No.	Language
(99976)	English
	French
	German
(99976A)	Italian
	Spanish
	Dutch

This catalog covers:  
**'10 KX65AAF**

GRID NO.

**L-15**

This grid covers:

**Numerical Parts Index**

Part No.	Grid No.	Part No.	Grid No.	Part No.	Grid No.	Part No.	Grid No.	Part No.	Grid No.	Part No.	Grid No.
11001-1516	B-3	13091-1728	E-7	14037-0047-6C	C-6	311AA0500	E-7	42036-1370	D-6	44065-1133	E-8
11004-1346	B-3	13095-1042	B-8	14037-1266-6C	C-6	311AA0600	D-5	42041-1526	D-12	44071-0295-458	E-8
11005-1973	B-3	13097-0055	B-6	14069-1003	B-12	32085-1508	E-3	42041-1527	D-12	44071-0296-458	E-8
11009-1147	B-14	130CA0510	B-13	14073-1759	B-4	32099-1036	E-7	42041-1528	D-12	45014-0120-10	D-14
11011-1578	B-4	130CA0520	B-8	14079-1130	E-4	32099-1044	E-7	42041-1529	D-12	46003-0030-458	E-7
11012-1263	D-5	130CA0840	E-4	15003-1669	B-14	320BA1200	D-11	42041-1549	D-12	46012-0011-21	E-7
11013-1284	B-4	13114-1055	B-8	16002-011	B-14	320BA1200	D-12	43010-1076	E-5	46019-1054	E-7
11051-1892	E-8	13127-1105	B-9	16003-006	B-14	32160-0117-18R	D-3	43015-0152	E-3	46075-1024	E-7
11053-1682	D-4	13128-0016	B-9	16004-025	B-14	32160-1611-18R	D-3	43015-1694	E-5	46076-1202	E-7
11060-1340	E-9	13129-1215	B-9	16006-023	B-14	33001-1634-458	D-5	43020-1094	E-5	46092-1165	E-7
11060-1921	B-3	13129-1343	B-9	16007-023	B-14	33032-1194	D-5	43020-1121	E-3	46102-1430	D-6
11060-1922	B-5	13129-1345	B-9	16008-1010	B-14	33040-1188	D-5	43022-1010	E-3	46102-1431	D-6
11061-0121	B-13	13129-1348	B-9	16014-1116	B-14	34024-1403-458	D-9	43026-0020	E-3	46102-1432	D-6
11061-0159	B-13	13129-1349	B-9	16016-0008	B-14	34028-1529-CE	D-7	43026-1058	E-5	46102-1433	D-6
11061-0181	E-9	13129-1515	B-9	16017-1412	B-14	34028-1530-CE	D-7	43027-1052	E-5	480J1200	B-7
11061-0193	B-13	13129-1611	B-9	16017-1413	B-14	35004-1416-290	D-8	43028-1060	E-5	480J1500	B-7
11061-0202	B-13	13129-1612	B-9	16017-1414	B-14	35019-1395-6D	D-8	43028-1067	E-3	480J1600	B-7
11065-1137	D-11	13129-1654	B-9	16017-1415	B-14	35022-1342-290	D-8	43034-1110	E-3	481J3700	D-12
11065-1137	D-12	13140-1300	B-10	16017-1418	B-14	36001-1639-266	E-12	43044-1076	E-6	49006-0078	E-3
11065-1225	E-8	13140-1301	B-10	16021-1224	B-14	36001-1667-266	E-12	43044-1127	D-12	49006-1017	E-7
12021-1015	B-3	13141-1220	B-10	16025-1040	B-14	39007-1299	D-6	43048-1089	E-4	49006-1088	E-4
12022-1013	B-3	13144-1022	B-9	16029-004	B-14	39061-1277	C-6	43048-1090	E-6	49006-1088	E-6
12022-1087	B-3	13144-1023	B-9	16030-1095	B-14	39062-1808	C-6	43049-1025	E-6	49006-1089	E-6
12053-1436	D-5	13156-1347	B-11	16031-1005	B-14	39062-1809	C-6	43049-1060	E-6	49006-1097	E-7
12053-1456	D-5	13159-1056	E-5	16032-003	B-14	39062-1810	C-6	43049-1061	E-6	49006-1242	E-4
13001-0040	B-6	13161-1280	B-11	16049-1001	B-14	39183-1059	E-7	43056-1055	E-4	49016-1044	E-3
13002-1119	B-6	13206-1067	B-7	16065-1020	B-14	41009-0105	D-10	43056-1055	E-6	49047-1009	B-10
13008-1199	B-6	13234-1110	B-13	16065-1366	B-14	41009-0106	D-10	43057-1001	E-4	49085-1076	C-6
13031-0039	B-6	13236-1026	B-11	16115-018	B-13	41022-1114	D-10	43057-1001	E-6	49085-1077	C-6
13032-1246	B-6	13236-1338	B-8	16142-0023	B-13	41022-1115	D-10	43078-1068	E-5	49089-1144-6C	C-6
13033-0002	B-6	13236-1346	E-3	16187-1130	B-14	41023-1066	D-10	43080-0035	E-4	49089-1145-6C	C-6
13034-0012	B-6	13236-1369	D-13	16187-1226	B-14	41023-1068	D-10	43080-0036	E-6	49091-0001	E-3
13035-1002	B-6	13236-1376	B-11	18020-0038	B-5	41024-010	D-10	43082-0042	E-4	49091-0001	E-5
13037-0049	B-6	13242-1366	B-11	18046-0049	B-5	41025-0129-WC	D-10	43082-0043	E-6	51001-1676-6Z	E-9
13037-1615	B-6	13260-1542	B-9	18100-0025	B-5	41025-0130-WC	D-10	43095-1228	E-5	51023-0024	E-9
13061-1712	B-7	13271-1298	B-4	18120-1116	B-5	41029-1302	D-10	43095-1254	E-5	51044-0025	E-9
13064-1196	B-7	13271-1417	B-10	18120-1119	B-5	41029-1303	D-10	43095-1256	E-3	51048-0014	E-9
13066-1097	B-7	13280-1142	B-4	21003-0031	C-4	41032-1055	D-10	44005-0042-458	E-8	52005-0019	B-13
13070-1074	E-7	13280-1179	B-10	21007-0052	C-4	41034-1302	D-11	44006-0042-458	E-8	52014-1094	B-13
13070-1314	B-7	132BA0612	E-9	21119-0047	C-4	41034-1303	D-12	44013-1496	E-8	53066-0092-13R	E-10
13070-1347	D-5	132BA0616	B-7	21121-0022	C-5	41068-1418	D-11	44023-1161	E-8	54011-1415	E-11
13070-1349	E-8	132BA0835	E-8	21130-1077	C-5	41068-1419	D-12	44026-1735	E-8	54012-0095	E-11
13078-1004	B-7	132BA0840	D-4	214C0518	E-7	41080-1470	E-4	44026-1736	E-8	55020-1707-6D	E-6
13086-1002	B-8	132BC0620	C-3	221AA0510	E-5	41080-1470	E-6	44026-1737	E-8	55020-1787	B-14
13087-1051	B-8	132BC0620	C-6	221AA0618	B-7	41090-0099-WC	D-10	44026-1738	E-8	550AA2015	E-5
13088-1010	B-8	132BC0830	E-7	222E0412	E-7	41090-0100-WC	D-10	44026-1739	E-8	550AA2518	D-4
13089-1087	B-8	14001-0119	B-12	223AA0416	C-3	410AA0800	D-12	44037-0023-21	E-8	550AA3025	D-11
13091-1115	B-8	14025-1646	E-7	224AA0614	C-4	42036-1067	D-5	44039-0022-21	E-8	550AA3025	D-12
13091-1133	B-8	14031-0107	B-13	27010-0035	E-7	42036-1351	D-6	44045-051	E-8	550S3020	D-7
13091-1696	B-4	14032-0133	B-13	290CA0808	B-7	42036-1364	D-6	44065-1123	E-8	56030-1230	E-14

This catalog covers:  
**'10 KX65AAF**

GRID NO.

**L-16**

This grid covers:

**Numerical Parts Index**

Part No.	Grid No.	Part No.	Grid No.	Part No.	Grid No.	Part No.	Grid No.	Part No.	Grid No.	Part No.	Grid No.
56054-0485	E-14	92015-1432	D-12	92043-1264	B-12	92066-1081	D-4	92150-1474	E-7	92153-0864	D-8
56068-1265	E-14	92015-1432	D-4	92043-1643	D-7	92066-1437	B-12	92150-1604	B-10	92153-0936	B-4
56069-0019	E-14	92015-1433	D-5	92045-1059	B-12	92070-1133	C-5	92150-1673	B-7	92153-0936	E-12
56069-0020	E-14	92015-1433	D-6	92045-1062	D-11	92070-1272	C-5	92150-1760	D-3	92153-0936	E-5
56069-0021	E-14	92015-1528	E-3	92045-1062	D-12	92071-042	B-12	92150-1840	E-6	92153-0936	E-6
56069-0022	E-14	92015-1596	E-7	92045-1235	B-12	92072-0055	E-7	92150-1891	D-4	92153-0936	F-3
56070-3799	E-14	92015-1653	E-8	92045-1236	B-8	92072-1229	E-9	92151-1103	E-7	92153-1095	D-4
56071-0028	E-14	92015-1684	D-3	92045-1304	B-12	92072-1293	C-4	92151-1131	B-12	92153-1101	D-12
56071-0029	E-14	92022-077	B-13	92045-1305	B-13	92072-1293	E-11	92151-1132	B-12	92160-1176	B-5
58029-1087-266	F-3	92022-1028	E-5	92045-1432	B-12	92075-1414	E-6	92151-1135	B-12	92160-1201	B-5
59051-1026	B-7	92022-107	D-4	92046-1046	D-5	92075-1787	E-9	92151-1135	B-5	92160-1913	B-5
59051-1027	B-7	92022-125	D-8	92046-1144	D-6	92075-209	C-6	92151-1235	B-13	92161-1077	E-9
59051-1146	B-6	92022-1380	B-13	92046-1160	B-13	92081-020	B-7	92151-1256	B-4	92170-1226	E-7
59101-1110	E-7	92022-1561	D-4	92046-1192	D-6	92081-1109	B-11	92151-1311	C-5	92170-1283	C-6
59231-1096	E-9	92022-1601	E-5	92046-1217	B-13	92081-1129	B-11	92151-1423	E-5	92170-1684	E-5
59256-1064	B-13	92022-165	E-9	92046-1271	D-6	92081-1152	C-3	92151-1423	E-9	92170-1686	B-4
600A0800	B-7	92022-1690	E-9	92049-002	B-13	92081-1153	C-3	92151-1572	D-13	92171-0652	C-4
601A6002	B-12	92022-1829	D-7	92049-1188	B-12	92081-1175	B-8	92151-1636	E-8	92171-0652	D-4
601A6004	B-12	92022-1841	E-8	92049-1257	D-11	92081-122	B-7	92151-1637	E-8	92172-0119	D-5
601A6203	B-12	92022-1873	E-8	92049-1257	D-12	92081-1275	B-11	92151-1762	B-12	92180-1354	D-4
601B6301UU	D-11	92022-237	B-5	92049-1328	D-6	92081-1502	E-6	92151-1766	D-6	92190-1488	D-13
601B6301UU	D-12	92022-255	B-8	92049-1331	E-4	92092-1078	D-14	92151-1785	D-6	92191-1434	C-6
610A0408	B-10	92022-304	B-3	92049-1359	B-13	92093-1272	E-4	92151-1799	E-4	92191-1495	C-3
610A0408	B-13	92025-1817	E-6	92049-1366	B-13	92093-1436	D-6	92151-1799	E-6	92191-1496	C-3
610A0408	B-3	92026-1365	E-8	92049-1414	B-13	92093-1511	B-5	92151-1822	B-5	92191-1611	C-3
670B2012	D-13	92026-1522	B-6	92049-1468	B-7	92093-1519	E-8	92151-1930	B-13	92200-0213	B-6
670E3032	B-5	92027-1210	B-5	92049-1524	E-8	92104-002	E-13	92151-1930	B-5	92200-1004	D-11
92001-1463	D-5	92027-1744	B-12	92050-013	B-12	92110-1119	E-13	92151-1930	D-8	92200-1004	D-12
92001-1464	E-8	92027-194	C-6	92051-005	B-12	92116-1065	D-3	92152-0195	B-9	92200-1197	B-8
92001-1499	D-6	92027-2096	E-9	92055-022	B-9	92122-1179	D-4	92152-1139	D-6	92200-1209	B-7
92001-1693	D-6	92028-1967	B-8	92055-1061	B-14	92122-1213	D-4	92152-1196	D-11	92200-1496	E-8
92002-1222	B-3	92033-029	B-9	92055-1251	E-5	92143-1196	C-6	92152-1196	D-12	92200-1564	C-3
92002-1237	B-11	92033-1060	B-9	92055-1367	E-8	92143-1196	D-8	92152-1197	D-11	92210-0076	B-3
92002-1697	B-8	92033-1079	B-9	92055-1658	B-14	92143-1196	E-12	92152-1198	D-12	92210-0215	B-6
92003-179	D-5	92033-1186	E-5	92055-2068	B-14	92143-1432	D-4	92152-1199	D-12	92210-1184	D-6
92004-0019	B-12	92036-007	B-6	92057-1504	D-12	92143-1676	D-5	92152-1215	D-5	99976-1549	F-4
92004-0020	B-12	92036-018	B-14	92058-1073	D-12	92144-1752	D-13	92152-1235	C-6	99976-1550	F-4
92004-1069	B-3	92037-1173	C-4	92059-1074	B-12	92145-1058	B-7	92152-1255	D-8		
92009-1014	B-3	92037-1173	C-5	92063-019	C-3	92145-1106	D-7	92153-0502	C-6		
92009-1102	B-11	92037-1236	B-13	92063-020	C-3	92145-1107	D-7	92153-0502	D-8		
92009-1435	E-7	92037-1305	B-14	92063-021	C-3	92145-1269	E-4	92153-0502	E-10		
92009-1458	E-3	92037-1362	E-3	92063-022	C-3	92145-1340	B-5	92153-0503	B-5		
92009-1530	E-9	92037-1363	E-3	92063-023	C-3	92145-1474-10	D-14	92153-0503	C-6		
92009-1607	B-7	92037-147	B-14	92063-025	C-3	92145-1475-10	D-14	92153-0627	E-3		
92009-1862	B-10	92037-1710	E-5	92064-021	C-3	92145-1476-10	D-14	92153-0627	E-5		
92015-077	C-4	92037-1712	B-14	92064-022	C-3	92145-1477-10	D-14	92153-0695	E-3		
92015-1078	B-5	92038-001	C-4	92064-032	C-3	92150-1144	E-4	92153-0859	B-13		
92015-1078	D-8	92042-007	B-12	92064-040	C-3	92150-1144	E-6	92153-0860	B-13		
92015-1143	D-4	92042-014	B-10	92064-1033	C-3	92150-1451	E-3	92153-0863	C-4		
92015-1259	B-4	92043-0004	E-5	92065-058	B-12	92150-1452	E-3	92153-0863	D-8		

This catalog covers:

'10 KX65AAF

GRID NO.

**B-16**

This grid covers:

**Part Name Index**

Accessory.....	F-3
Air Cleaner.....	B-4
Brake Pedal.....	D-13
Cables.....	E-11
Carburetor.....	B-14/C-3
Clutch.....	B-8
Crankcase.....	B-12
Crankshaft.....	B-6
Cylinder.....	B-3
Cylinder Head.....	B-3
Engine Cover(s).....	B-13
Engine Mount.....	D-4
Fenders.....	D-8
Footrests.....	D-7
Frame.....	D-3
Front Brake.....	E-4
Front Fork.....	E-8
Front Hub.....	D-11
Front Master Cylinder.....	E-3
Fuel Tank.....	E-9
Gear Change Drum.....	B-10
Gear Change Mechanism.....	B-11

Generator.....	C-4
Handlebar.....	E-7
Ignition System.....	C-5
Kickstarter Mechanism.....	B-7
Labels.....	E-14
Manual(EU).....	F-4
Muffler(s).....	B-5
Owner's Tools.....	E-13
Piston(s).....	B-6
Radiator.....	C-6
Rear Brake.....	E-6
Rear Hub.....	D-12
Rear Master Cylinder.....	E-5
Seat.....	E-10
Shift Fork(s).....	B-10
Shock Absorber(s).....	D-14
Side Covers.....	E-12
Stand(s).....	D-9
Suspension.....	D-6
Swingarm.....	D-5
Tires.....	D-10
Transmission.....	B-9

This catalog covers:

'10 KX65AAF

GRID NO.

**C-16**

This grid covers:

**Part Name Index**

Accessory.....	F-3
Air Cleaner.....	B-4
Brake Pedal.....	D-13
Cables.....	E-11
Carburetor.....	B-14/C-3
Clutch.....	B-8
Crankcase.....	B-12
Crankshaft.....	B-6
Cylinder.....	B-3
Cylinder Head.....	B-3
Engine Cover(s).....	B-13
Engine Mount.....	D-4
Fenders.....	D-8
Footrests.....	D-7
Frame.....	D-3
Front Brake.....	E-4
Front Fork.....	E-8
Front Hub.....	D-11
Front Master Cylinder.....	E-3
Fuel Tank.....	E-9
Gear Change Drum.....	B-10
Gear Change Mechanism.....	B-11

Generator.....	C-4
Handlebar.....	E-7
Ignition System.....	C-5
Kickstarter Mechanism.....	B-7
Labels.....	E-14
Manual(EU).....	F-4
Muffler(s).....	B-5
Owner's Tools.....	E-13
Piston(s).....	B-6
Radiator.....	C-6
Rear Brake.....	E-6
Rear Hub.....	D-12
Rear Master Cylinder.....	E-5
Seat.....	E-10
Shift Fork(s).....	B-10
Shock Absorber(s).....	D-14
Side Covers.....	E-12
Stand(s).....	D-9
Suspension.....	D-6
Swingarm.....	D-5
Tires.....	D-10
Transmission.....	B-9

This catalog covers:

'10 KX65AAF

GRID NO.

**D-16**

This grid covers:

**Part Name Index**

Accessory.....	F-3
Air Cleaner.....	B-4
Brake Pedal.....	D-13
Cables.....	E-11
Carburetor.....	B-14/C-3
Clutch.....	B-8
Crankcase.....	B-12
Crankshaft.....	B-6
Cylinder.....	B-3
Cylinder Head.....	B-3
Engine Cover(s).....	B-13
Engine Mount.....	D-4
Fenders.....	D-8
Footrests.....	D-7
Frame.....	D-3
Front Brake.....	E-4
Front Fork.....	E-8
Front Hub.....	D-11
Front Master Cylinder.....	E-3
Fuel Tank.....	E-9
Gear Change Drum.....	B-10
Gear Change Mechanism.....	B-11

Generator.....	C-4
Handlebar.....	E-7
Ignition System.....	C-5
Kickstarter Mechanism.....	B-7
Labels.....	E-14
Manual(EU).....	F-4
Muffler(s).....	B-5
Owner's Tools.....	E-13
Piston(s).....	B-6
Radiator.....	C-6
Rear Brake.....	E-6
Rear Hub.....	D-12
Rear Master Cylinder.....	E-5
Seat.....	E-10
Shift Fork(s).....	B-10
Shock Absorber(s).....	D-14
Side Covers.....	E-12
Stand(s).....	D-9
Suspension.....	D-6
Swingarm.....	D-5
Tires.....	D-10
Transmission.....	B-9

This catalog covers:

'10 KX65AAF

GRID NO.

**E-16**

This grid covers:

**Part Name Index**

Accessory.....	F-3
Air Cleaner.....	B-4
Brake Pedal.....	D-13
Cables.....	E-11
Carburetor.....	B-14/C-3
Clutch.....	B-8
Crankcase.....	B-12
Crankshaft.....	B-6
Cylinder.....	B-3
Cylinder Head.....	B-3
Engine Cover(s).....	B-13
Engine Mount.....	D-4
Fenders.....	D-8
Footrests.....	D-7
Frame.....	D-3
Front Brake.....	E-4
Front Fork.....	E-8
Front Hub.....	D-11
Front Master Cylinder.....	E-3
Fuel Tank.....	E-9
Gear Change Drum.....	B-10
Gear Change Mechanism.....	B-11

Generator.....	C-4
Handlebar.....	E-7
Ignition System.....	C-5
Kickstarter Mechanism.....	B-7
Labels.....	E-14
Manual(EU).....	F-4
Muffler(s).....	B-5
Owner's Tools.....	E-13
Piston(s).....	B-6
Radiator.....	C-6
Rear Brake.....	E-6
Rear Hub.....	D-12
Rear Master Cylinder.....	E-5
Seat.....	E-10
Shift Fork(s).....	B-10
Shock Absorber(s).....	D-14
Side Covers.....	E-12
Stand(s).....	D-9
Suspension.....	D-6
Swingarm.....	D-5
Tires.....	D-10
Transmission.....	B-9



This catalog covers:

'10 KX65AAF

GRID NO.

**F-16**

This grid covers:

**Part Name Index**

Accessory.....	F-3
Air Cleaner.....	B-4
Brake Pedal.....	D-13
Cables.....	E-11
Carburetor.....	B-14/C-3
Clutch.....	B-8
Crankcase.....	B-12
Crankshaft.....	B-6
Cylinder.....	B-3
Cylinder Head.....	B-3
Engine Cover(s).....	B-13
Engine Mount.....	D-4
Fenders.....	D-8
Footrests.....	D-7
Frame.....	D-3
Front Brake.....	E-4
Front Fork.....	E-8
Front Hub.....	D-11
Front Master Cylinder.....	E-3
Fuel Tank.....	E-9
Gear Change Drum.....	B-10
Gear Change Mechanism.....	B-11

Generator.....	C-4
Handlebar.....	E-7
Ignition System.....	C-5
Kickstarter Mechanism.....	B-7
Labels.....	E-14
Manual(EU).....	F-4
Muffler(s).....	B-5
Owner's Tools.....	E-13
Piston(s).....	B-6
Radiator.....	C-6
Rear Brake.....	E-6
Rear Hub.....	D-12
Rear Master Cylinder.....	E-5
Seat.....	E-10
Shift Fork(s).....	B-10
Shock Absorber(s).....	D-14
Side Covers.....	E-12
Stand(s).....	D-9
Suspension.....	D-6
Swingarm.....	D-5
Tires.....	D-10
Transmission.....	B-9